



ORANGE UNIFIED SCHOOL DISTRICT

May 23, 2019

ORANGE HIGH SCHOOL PHASE II

ARCHITECTURE ENGINEERING PLANNING INTERIORS SUSTAINABILITY GRAPHICS ACCESS COMPLIANCE

LIONAKIS

The image features a background aerial photograph of a city grid. A large, semi-transparent teal rectangle is centered over the image. Within this rectangle, on the right side, is a detailed architectural rendering of a proposed development. The rendering shows a complex of buildings, including a large rectangular structure, a curved building, and a parking lot with many spaces. The word "INTRODUCTION" is written in white, bold, sans-serif capital letters across the middle of the teal area.

INTRODUCTION

OUSD DISTRICT-WIDE PLANNING GOALS FOR HIGH SCHOOLS

“The Orange Unified School District, being committed to planning for continual improvement, will offer a learning environment of excellence, with high expectations, to provide each student with the opportunity to be able to compete in the global economy.”



Canyon High School
El Modena High School
Orange High School
Villa Park High School

- District-wide Planning Guidelines for Equity/Parity
- 75 Teacher Stations
- 40 Student Classroom Capacity
- Kelly Stadium Remains as shared resource
- CTE/Specialty Programs are Site Specific

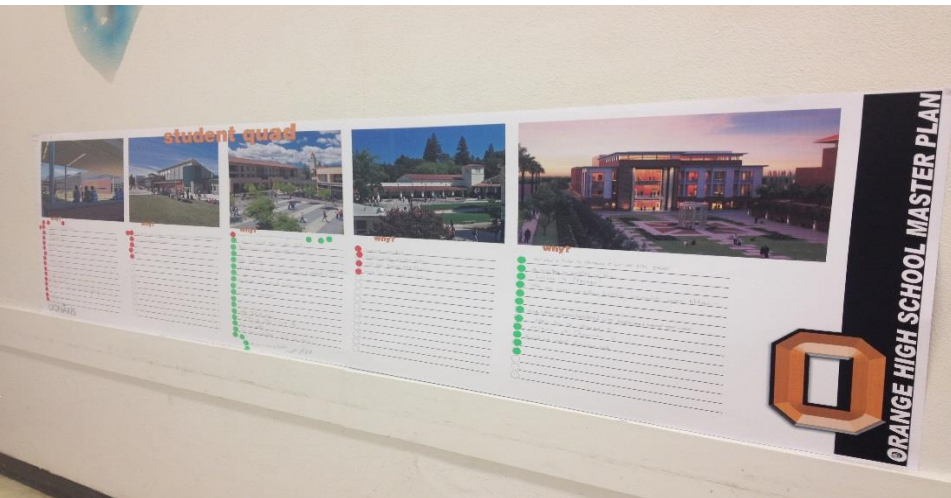

PLANNING PROCESS

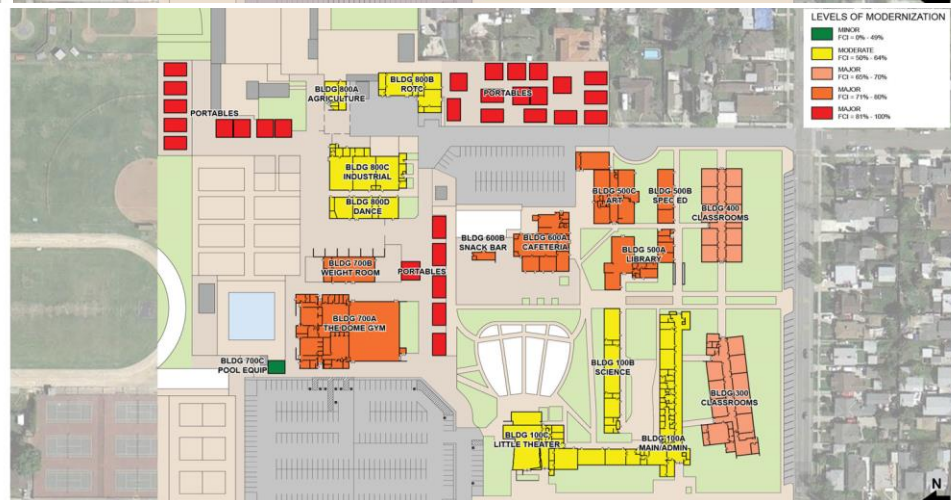

PLANNING PROCESS



Conceptual Illustration Only

MASTER PLAN UPDATE

- New Science Labs
- New 21st Century Classrooms
- Relocate Bus Drop-Off for Student Safety
- New Administration and Student Services, including Counseling and Health Center
- New Snack Bar and Outdoor Dining Complex
- Removal of 20 Portable Classroom Buildings
- New Staff Parking
- Panther Plaza and Alumni Corner

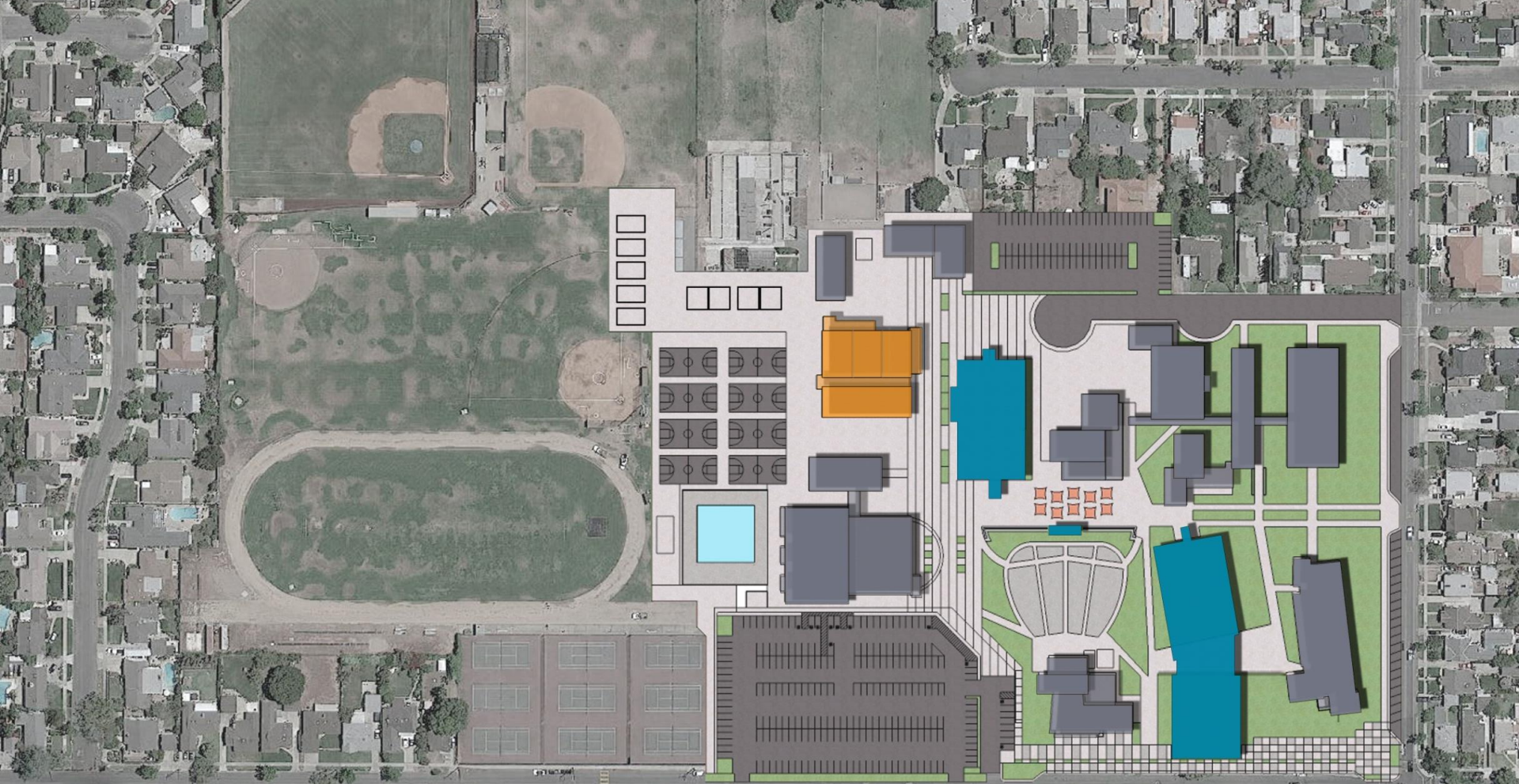

MASTER PLAN 2016



MEASURE S
\$288,000,000 IN BONDS
\$72 MILLION IN IMPROVEMENTS AT EACH HIGH SCHOOL

PRIORITIES:
INFRASTRUCTURE
SCIENCE CLASSROOMS AND LABS
REPLACE INADEQUATE FACILITIES



Relocate Bus Drop-off
to E Walnut Ave

This is an aerial architectural rendering of a school campus. The campus includes several buildings, a large parking lot with many spaces, a swimming pool, and various sports fields including baseball and softball diamonds. A new bus drop-off location is indicated by an orange dashed line along E Walnut Ave, with a yellow school bus icon shown at the new site. A teal text box in the upper right corner contains the text 'Relocate Bus Drop-off to E Walnut Ave'.

PHASE I – RELOCATE BUS DROP-OFF - COMPLETE



Remove/Relocate Portables
&
Demolish Snack Bar

PHASE I – DEMOLISH EXISTING PORTABLES - COMPLETE

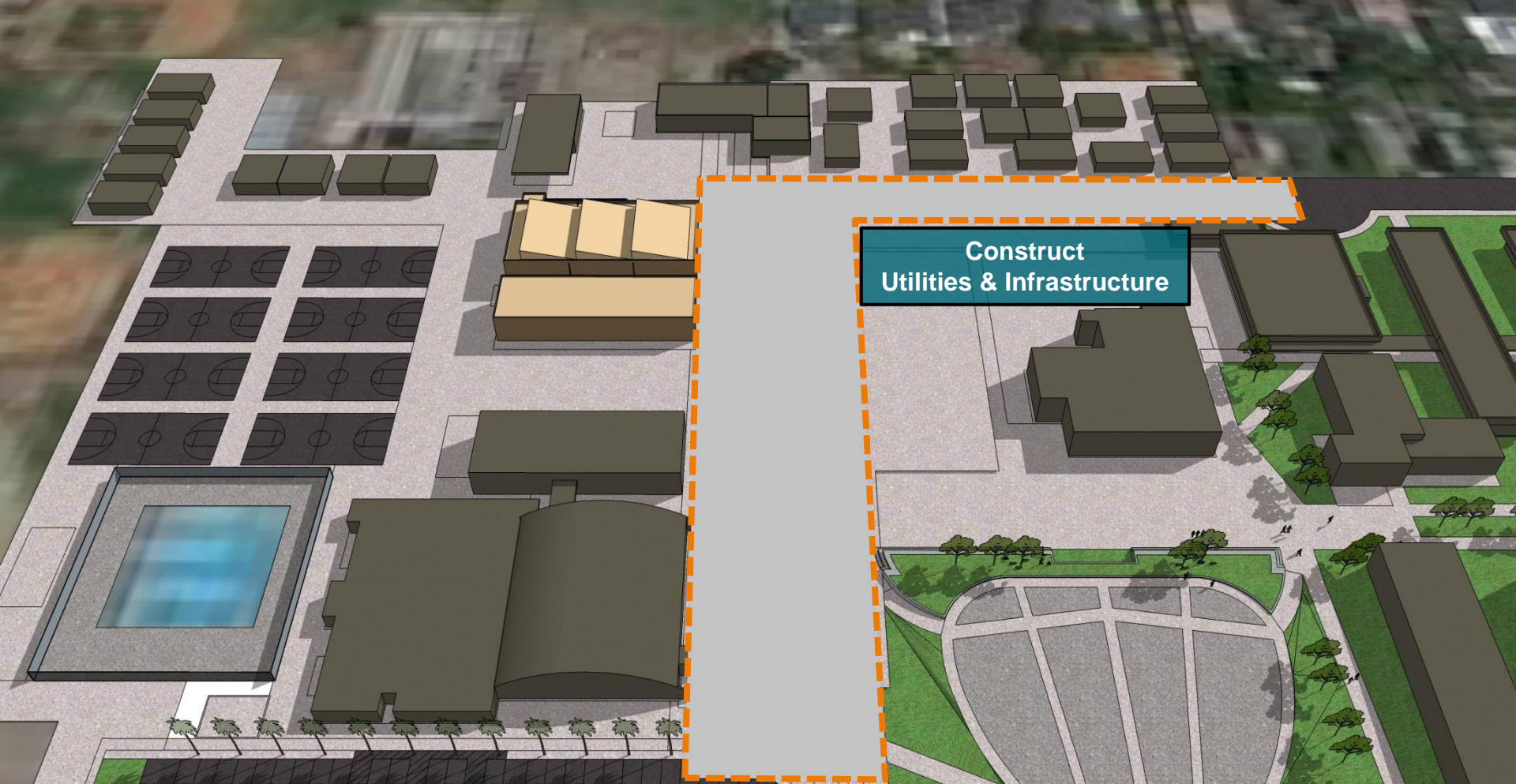

**Construct
Utilities & Infrastructure**

PHASE I – INFRASTRUCTURE - COMPLETE

An aerial architectural rendering of a campus. The image shows various buildings, including a large white rectangular building in the center, a yellow building to its left, and several grey buildings to the right. There are parking lots with cars, a swimming pool in the bottom left, and a grid of basketball courts. Two areas are highlighted with orange dashed boxes and labeled with blue callout boxes. The first box, labeled 'Construct New Science Center', is around the white building. The second box, labeled 'Construct New Snack Bar', is around a small yellow building with orange umbrellas. The background shows a city street with trees and other buildings.

**Construct New
Science Center**

**Construct New
Snack Bar**

PHASE I – STEM BUILDING - UNDERWAY



Measure S Phase I – Science Center

- 4 New Chemistry Labs
- 8 New Science Labs
- 1 New Standard Classroom
- 2 Medically Fragile Classrooms
- Completion Date: May 2020

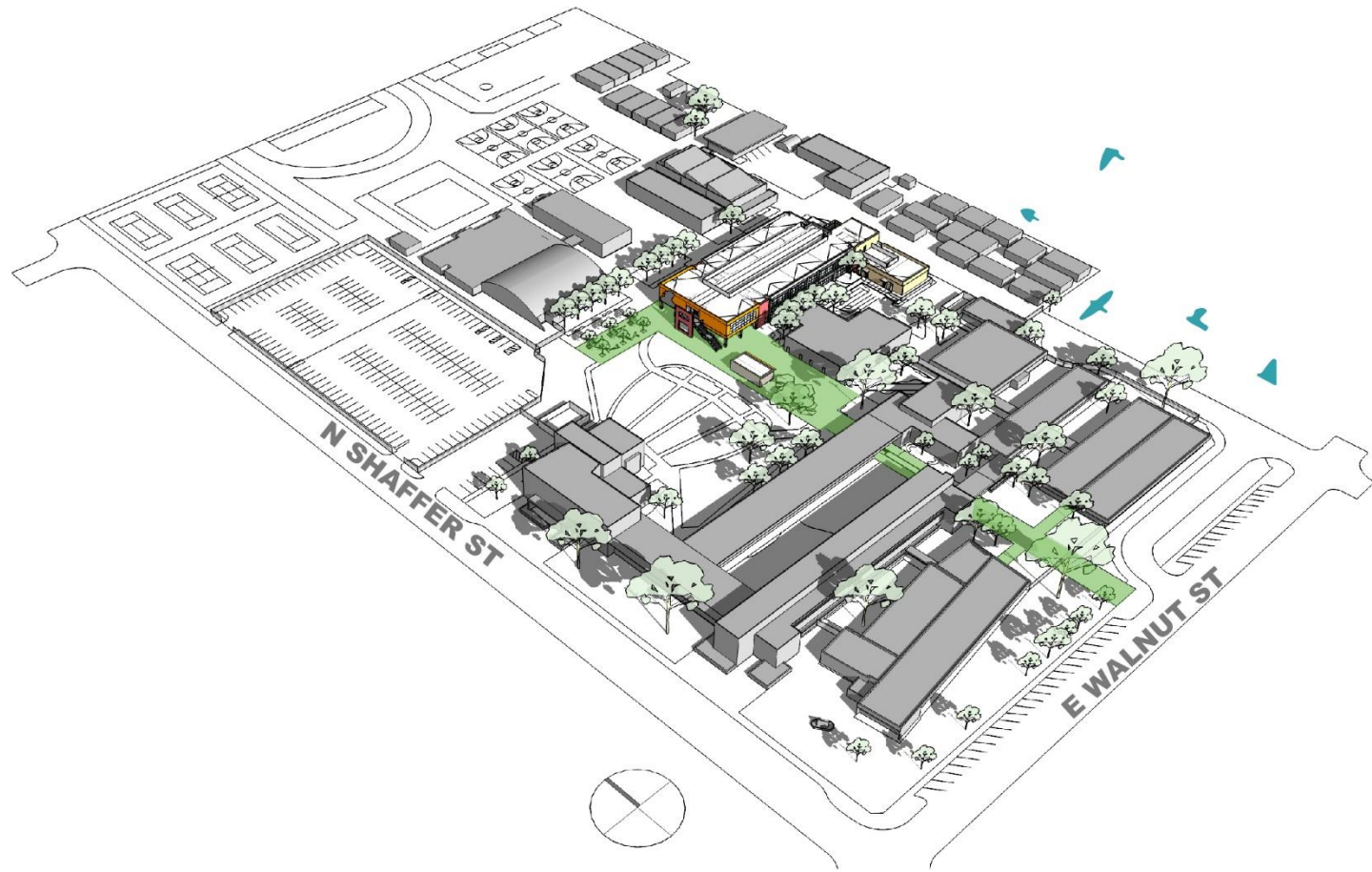

PHASE I COMPLETION

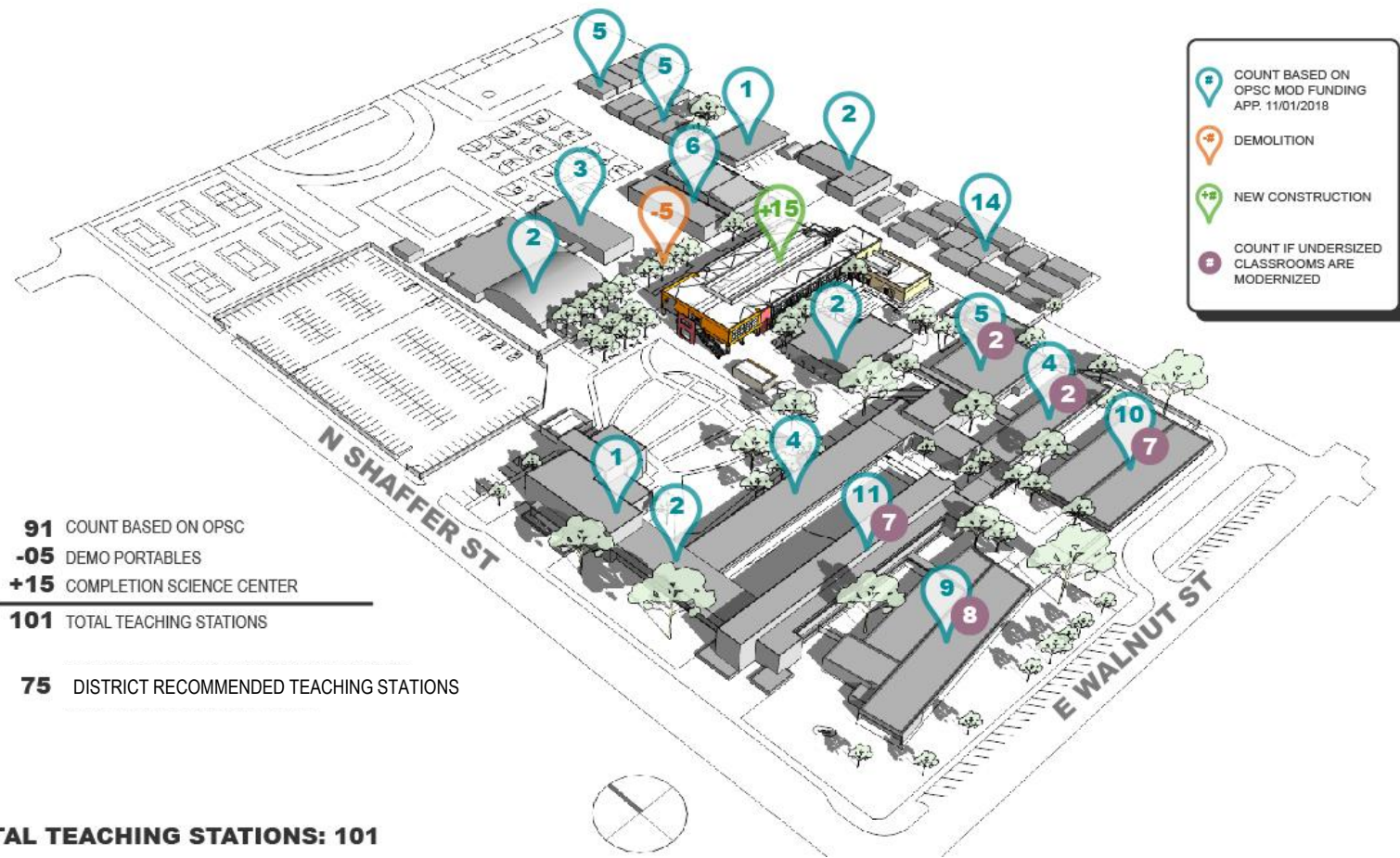

PHASE I COMPLETION – MAY 2020



MEASURE S – PHASE II

Building 100/200 Assessment

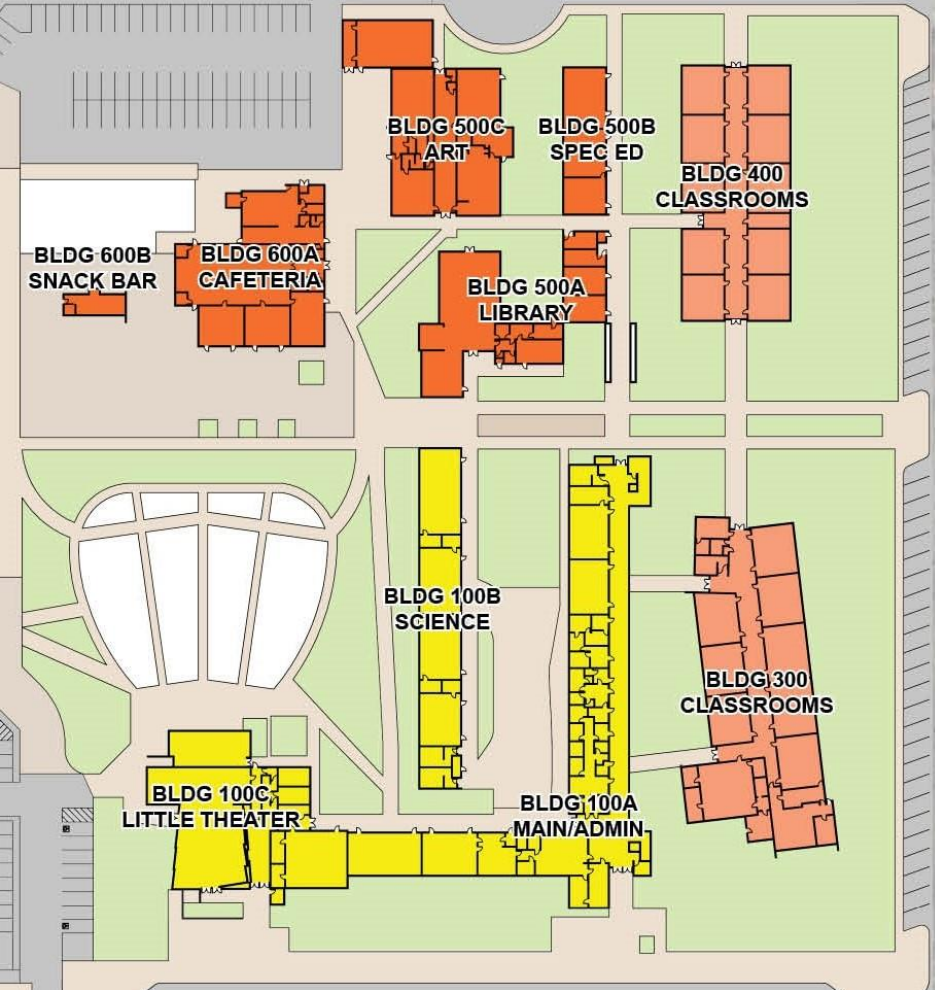

- Structural Assessment
 - Tier 1 - What do we have?
 - Tier 2 – Which structural improvements do we implement?
- Accessibility
 - Bldg 200 Second Floor
 - Restrooms
- Fire & Life Safety
 - Exiting
 - Fire Protection
 - Impacts to adjacent buildings

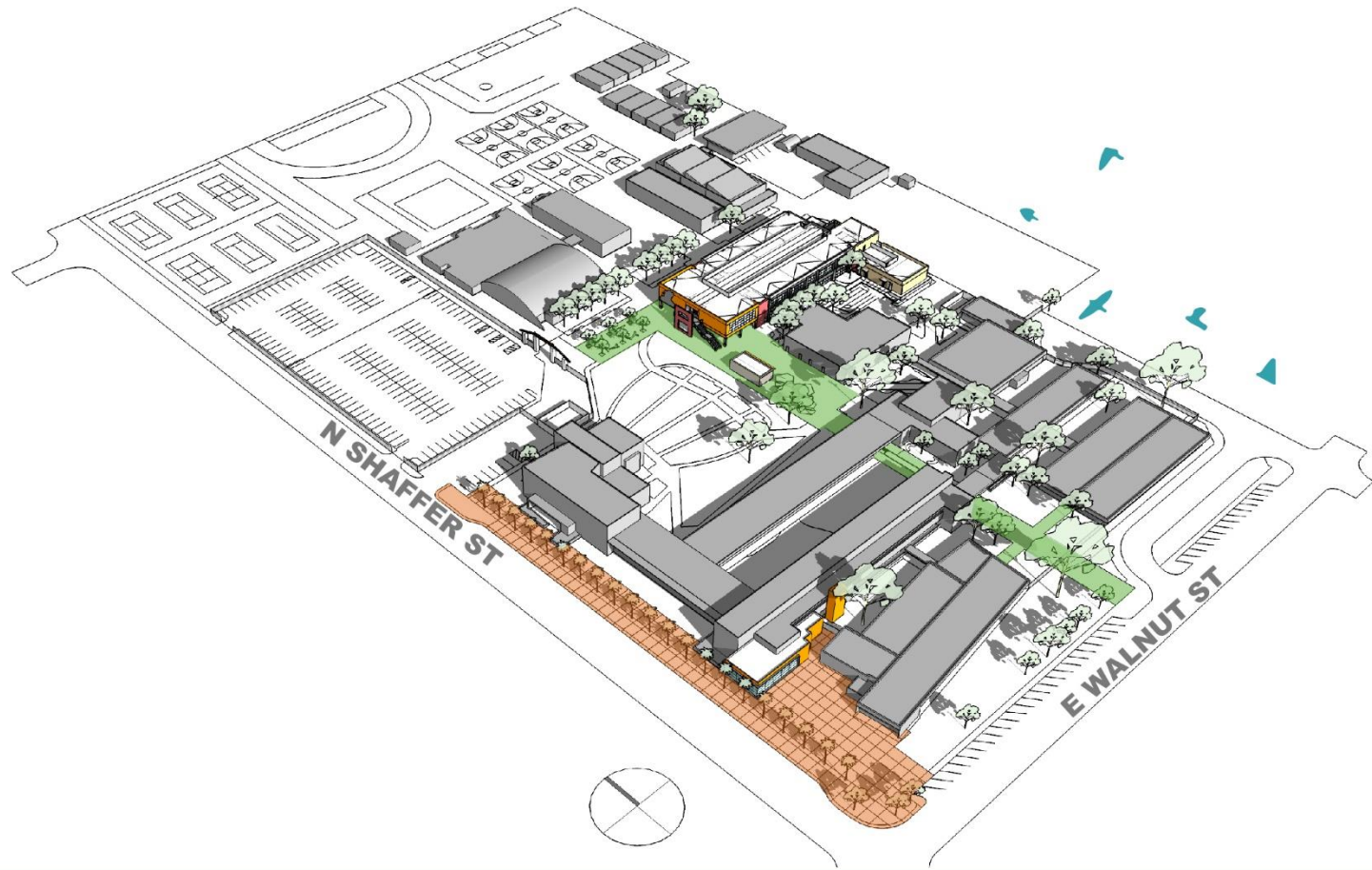

MODERNIZATION

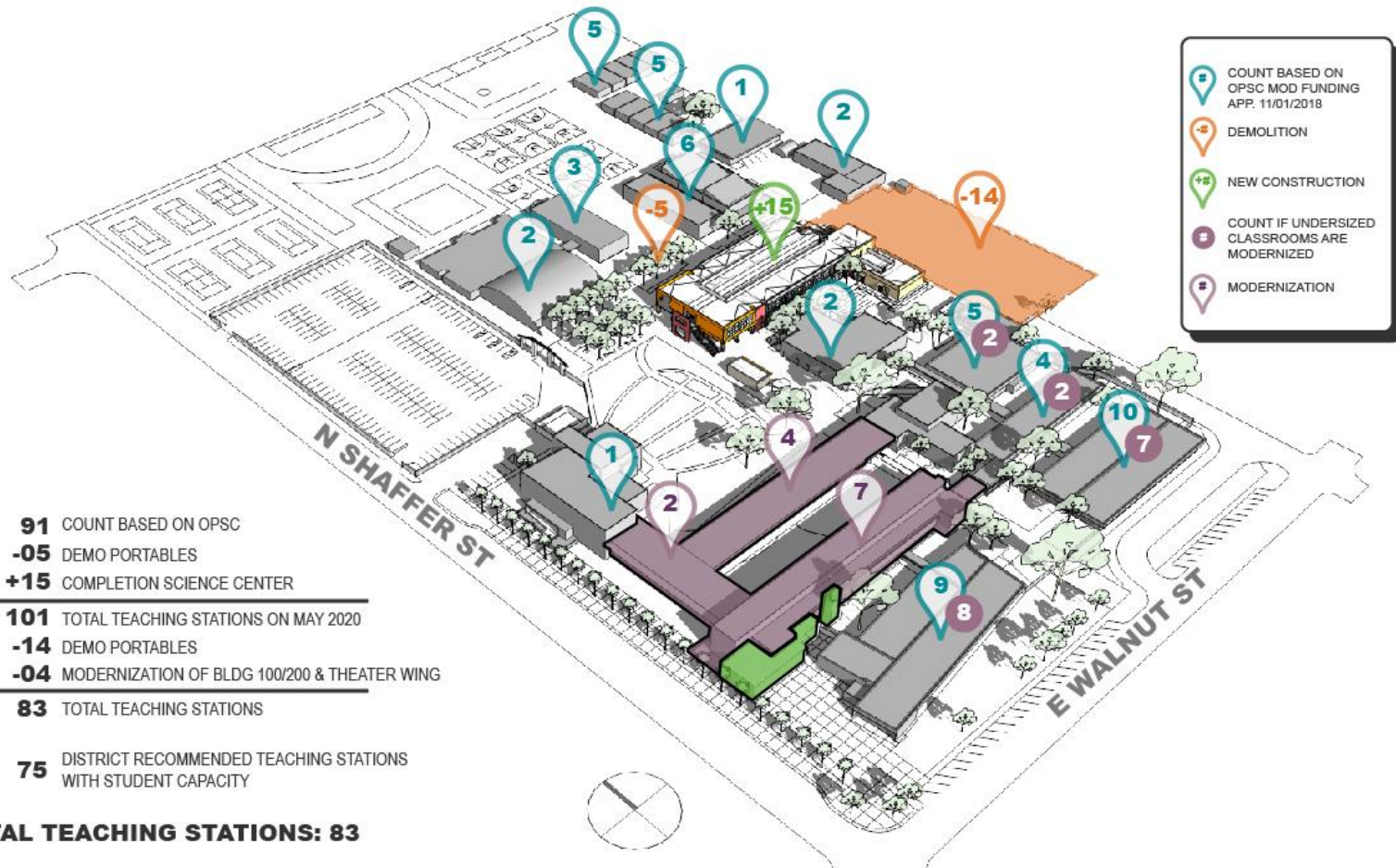

MODERNIZATION



VIEW FROM SNACK BAR - MODERNIZATION



VIEW FROM WALNUT ENTRY - MODERNIZATION



VIEW FROM SHAFFER/WALNUT - MODERNIZATION

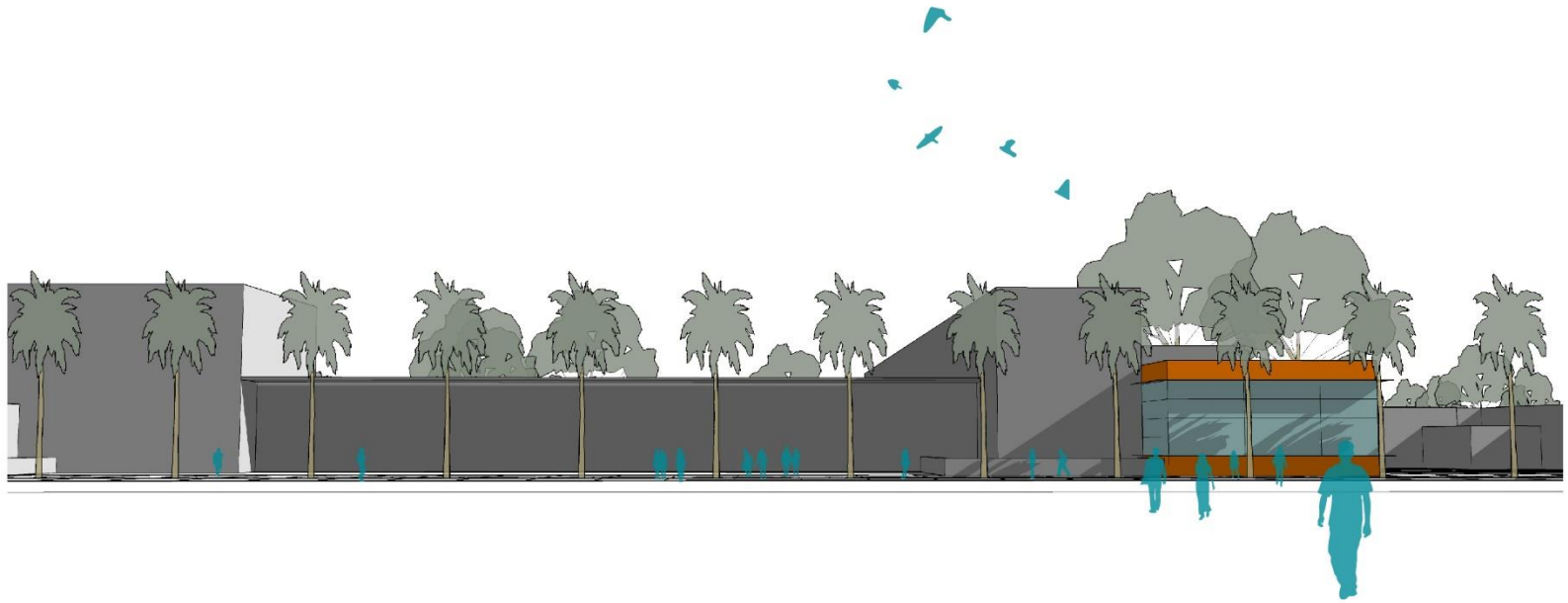

VIEW FROM SHAFFER ST - MODERNIZATION

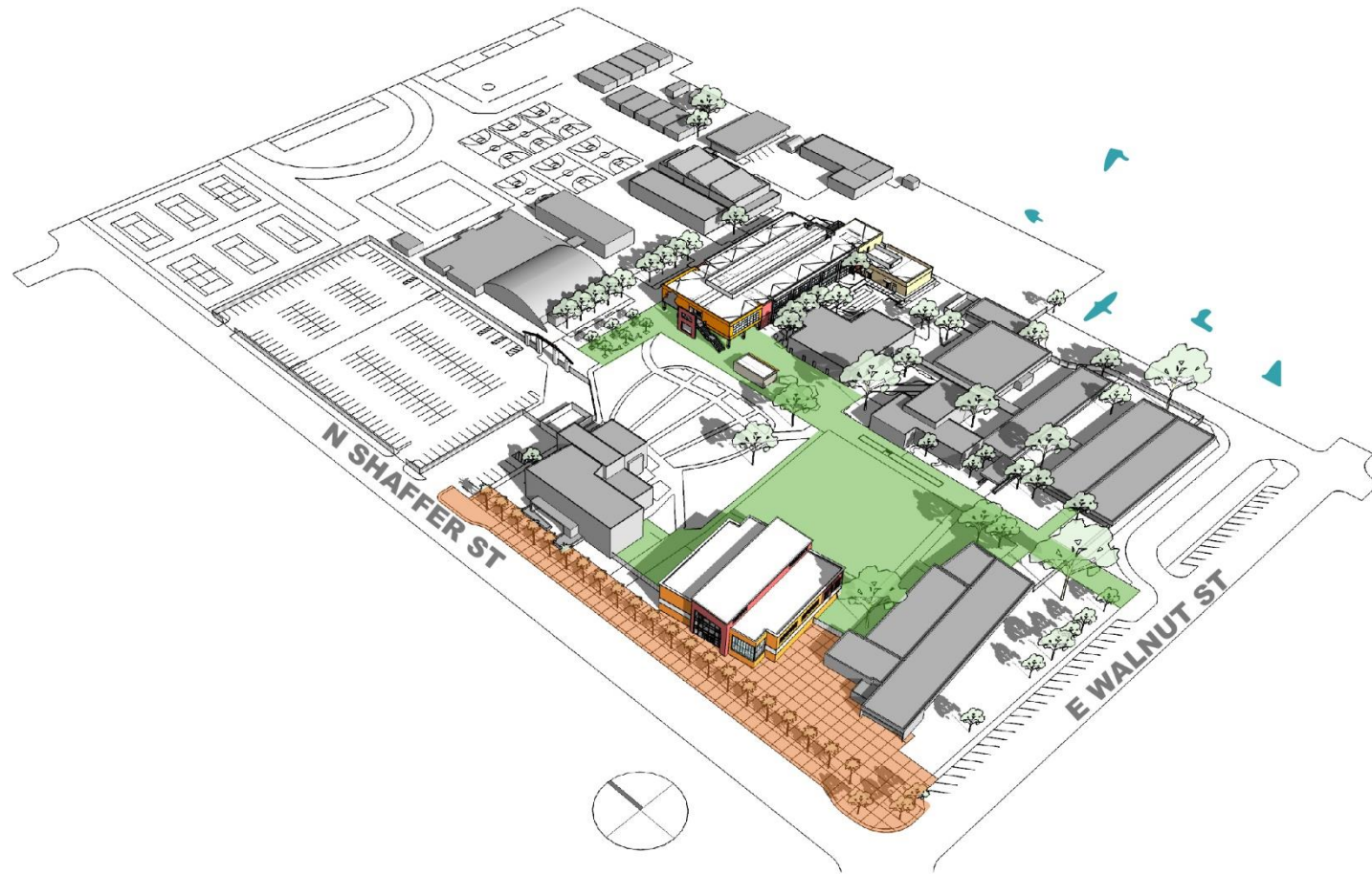

PHASE II - NEW CLASSROOM / ADMIN / STUDENT SERVICES

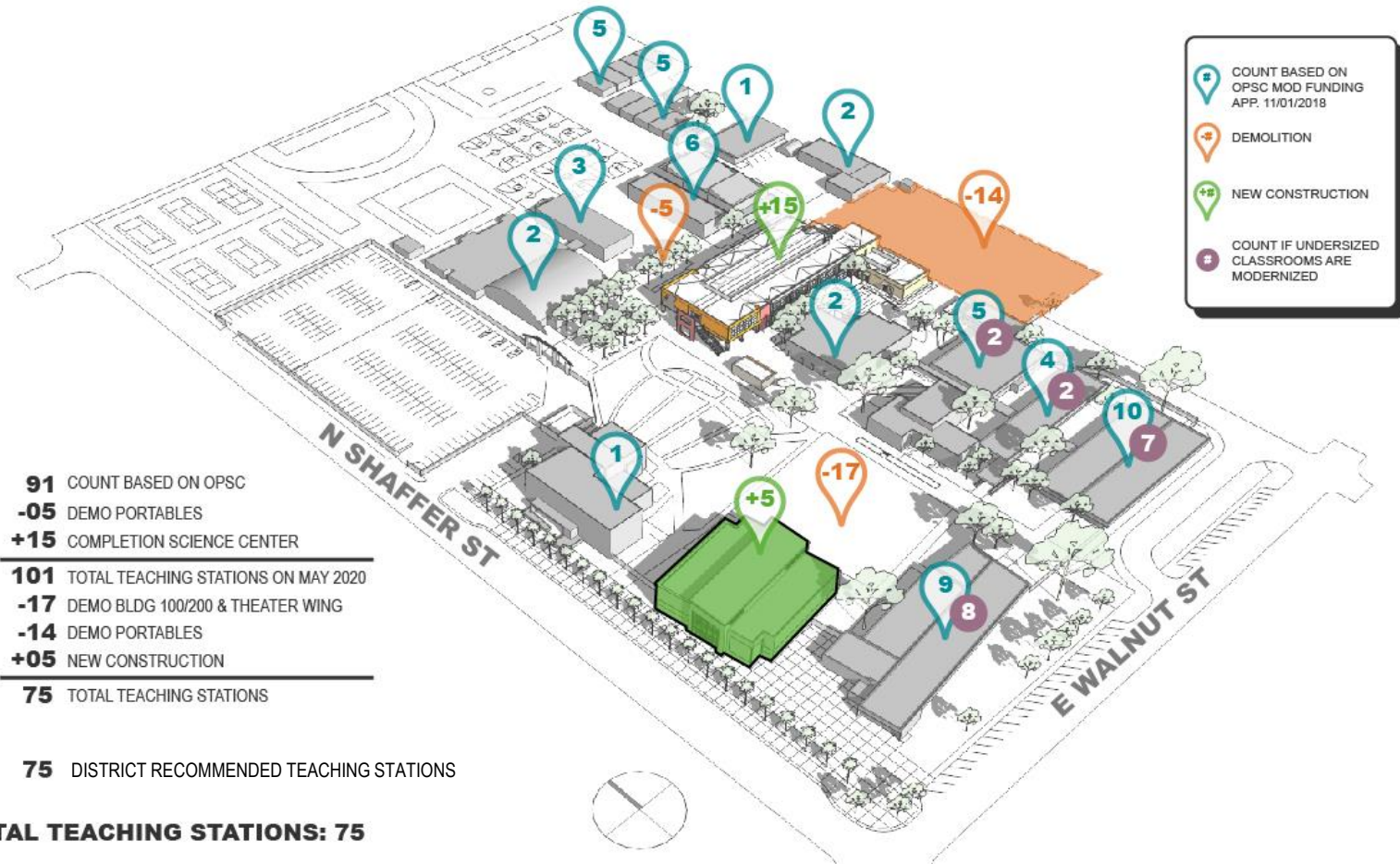

PHASE II - NEW CLASSROOM / ADMIN / STUDENT SERVICES



VIEW FROM SNACK BAR - NEW CLASSROOM / ADMIN / STUDENT SERVICES



VIEW FROM WALNUT ENTRY - NEW CLASSROOM / ADMIN / STUDENT SERVICES



VIEW FROM SHAFFER/WALNUT - NEW CLASSROOM / ADMIN / STUDENT SERVICES



VIEW FROM SHAFFER ST – NEW CLASSROOM / ADMIN / STUDENT SERVICES

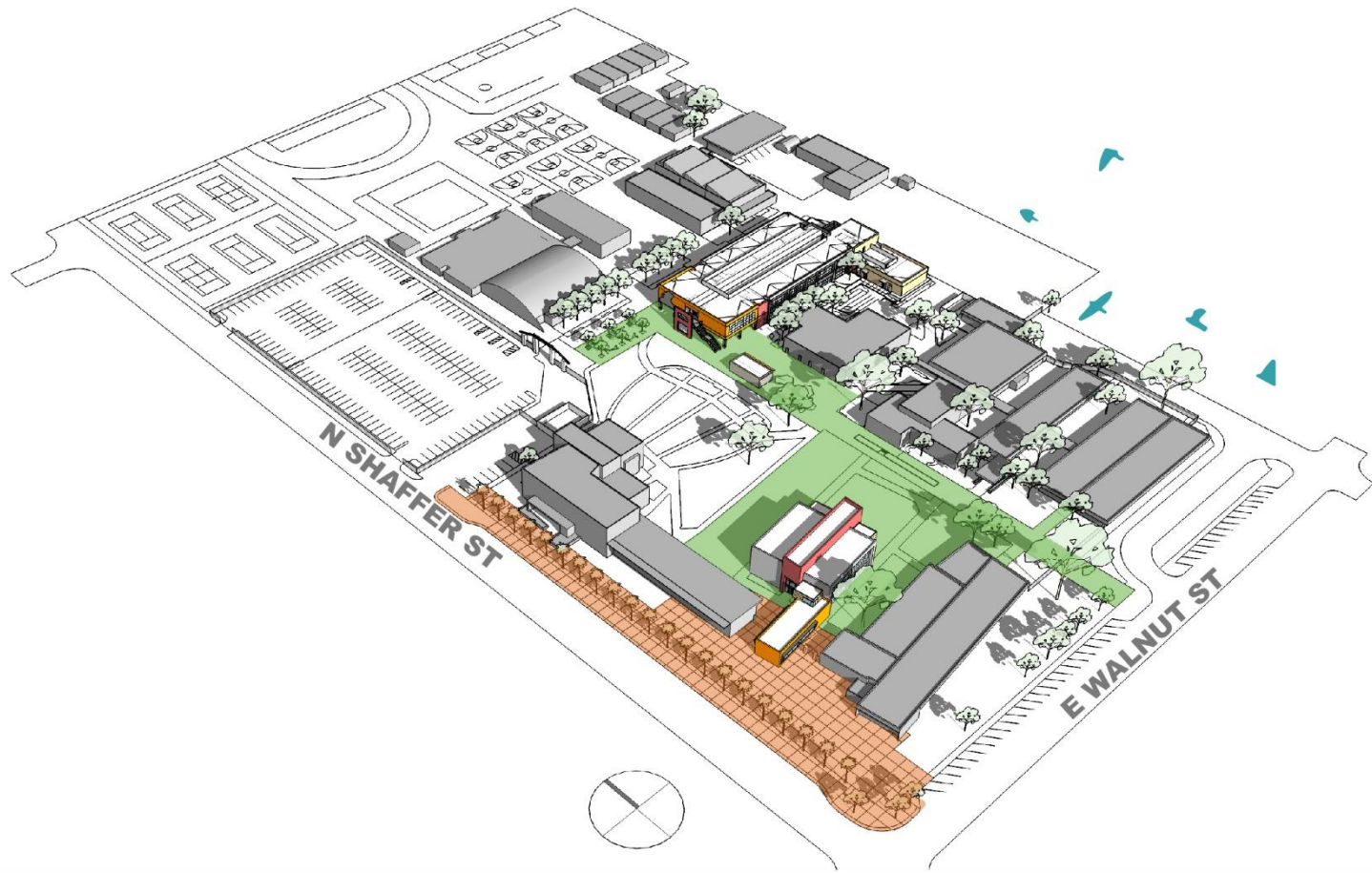

HYBRID

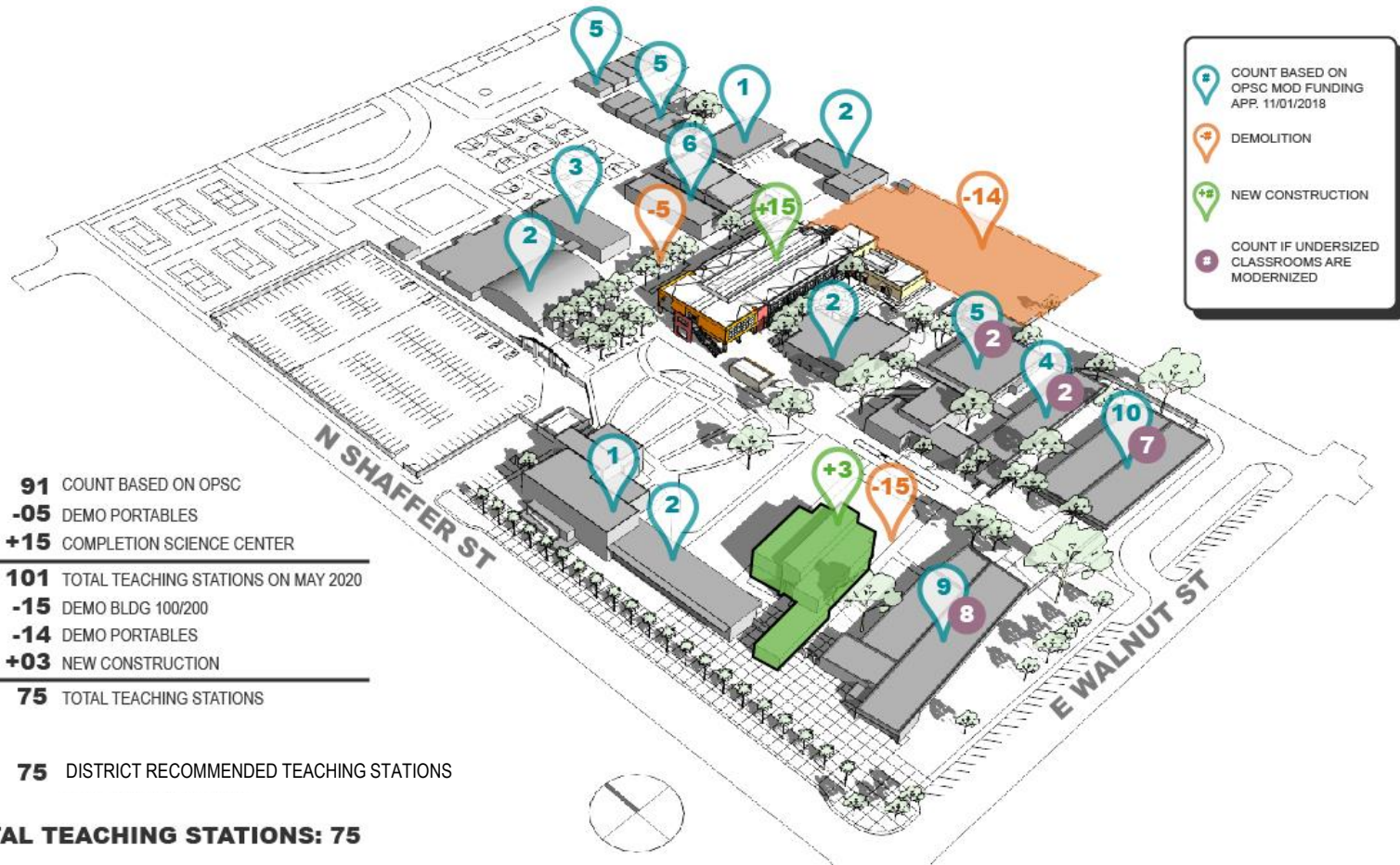



VIEW FROM SNACK BAR - HYBRID



VIEW FROM WALNUT ENTRY - HYBRID



VIEW FROM SHAFFER/WALNUT - HYBRID



VIEW FROM SHAFFER ST - HYBRID

The image is a composite. The background is an aerial photograph of a city, showing a grid of streets, residential areas, and a large baseball field in the upper left. Overlaid on the right side of the image is a semi-transparent architectural rendering of a large stadium complex. The rendering shows multiple buildings, a large central arena with a curved roof, and a large parking lot with many spaces. The text "THE PROCESS SO FAR...." is centered over the middle of the image, in white capital letters.

THE PROCESS SO FAR....

Stakeholder Meetings



- Stakeholder Meeting #1
 - Community and Staff
- Stakeholder Meeting #2
 - Students



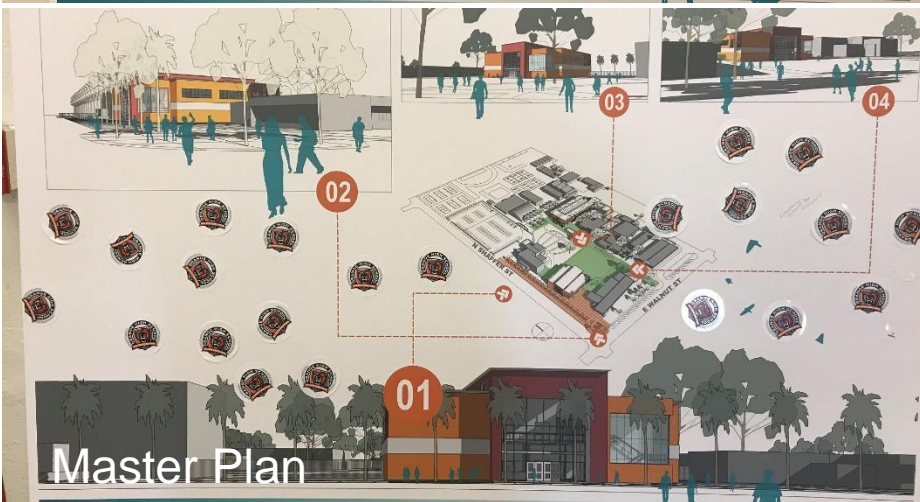
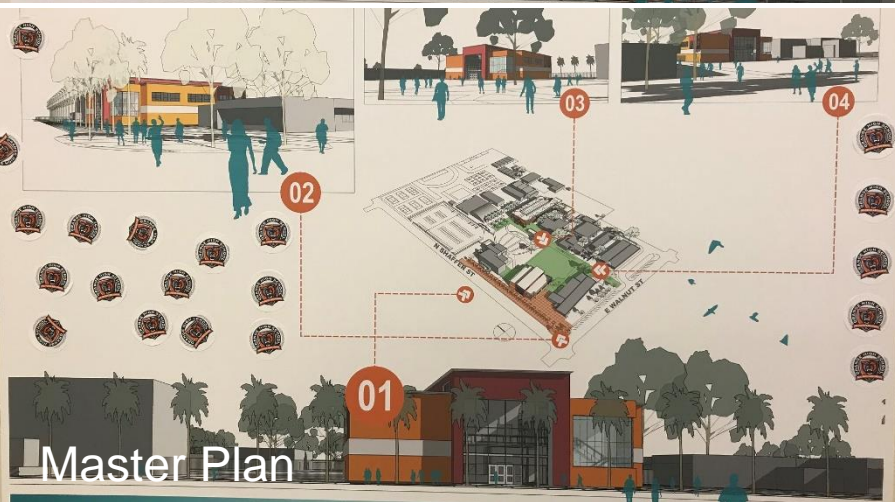
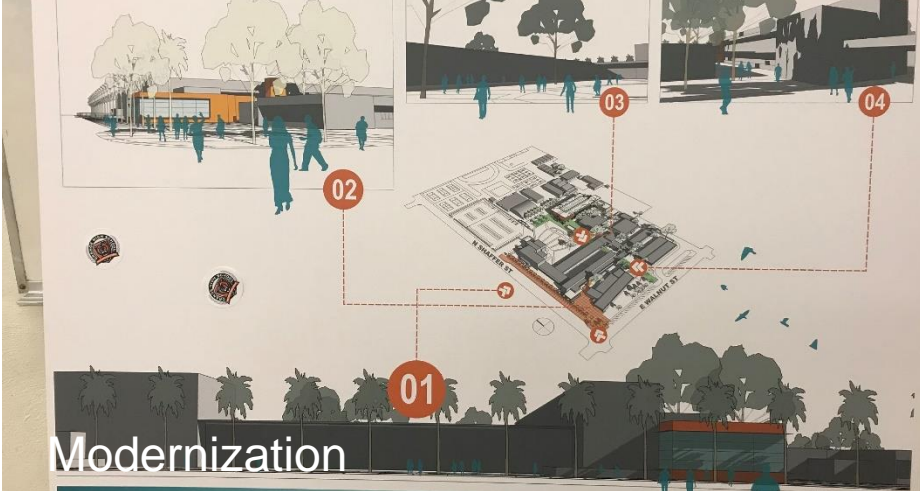
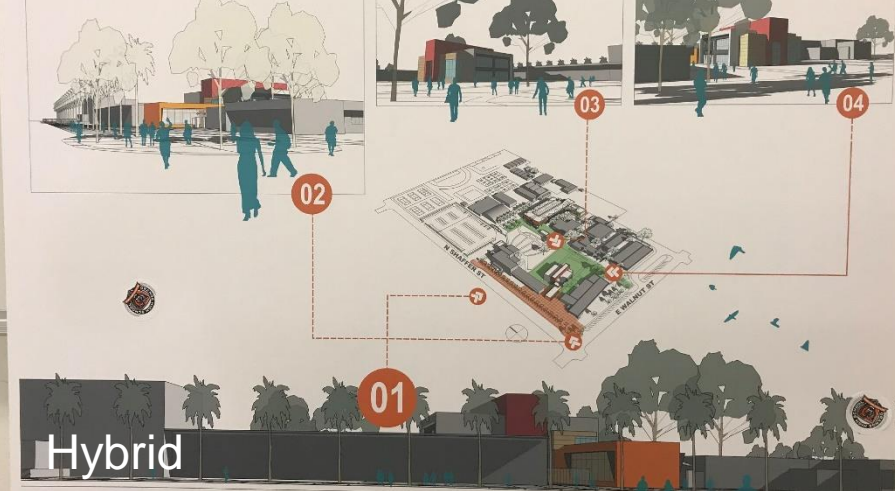

COMMUNITY OUTREACH

An architectural rendering of a modern building, likely a university or corporate structure. The building features a large tiger logo on its facade and the text "PA...ER PAVILION". In the foreground, there is a wide, paved plaza with a series of low, rectangular concrete steps or planters. The scene is set against a backdrop of trees and a sky with birds.

relationships. performance. design.