



# Measure S PHASE II DESIGN CONTRACT ACTION ITEMS

July 25, 2019

Scott Harvey, Senior Executive Director, Administrative Services  
Rory Lorenzo, Bond Program Manager



# Orange High School

"ONCE A PANTHER, ALWAYS A PANTHER"

## PHASE II

### Building 100/200 Structural Assessment

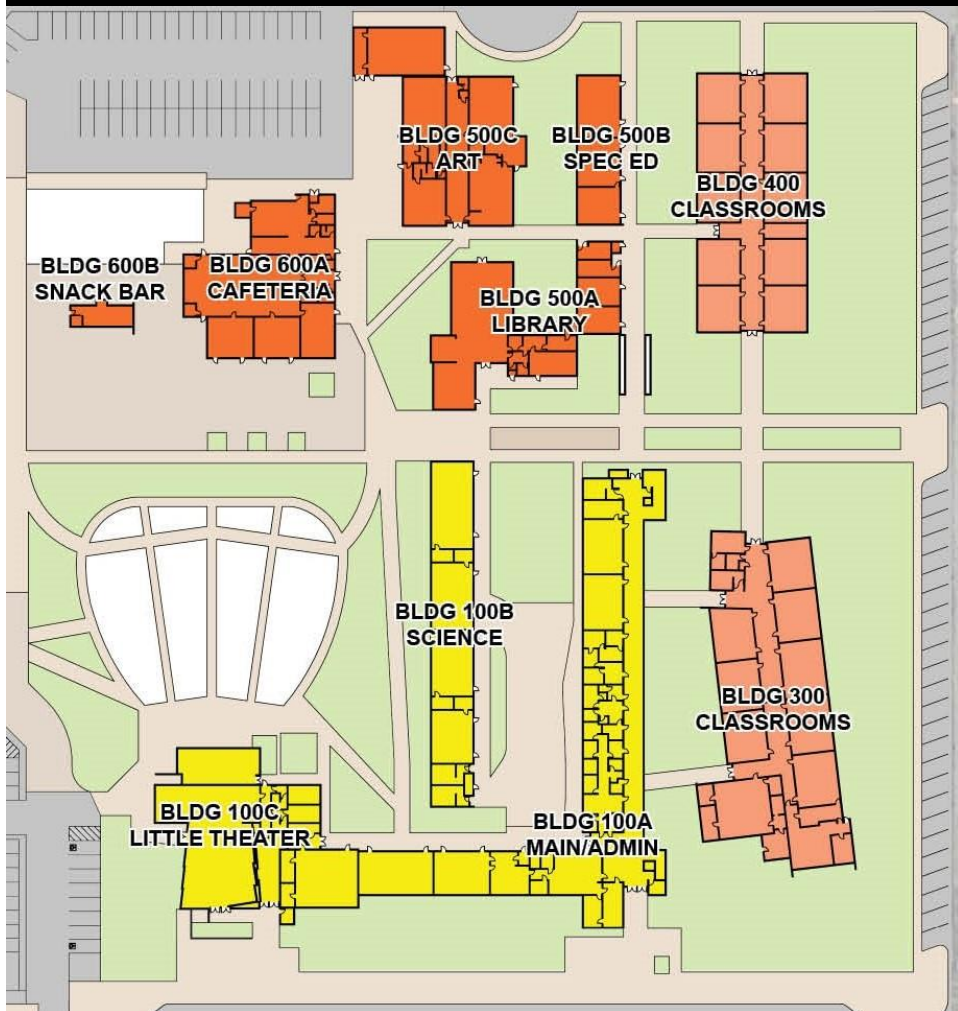

- Accessibility
  - ❖ Bldg 200 Second Floor
  - ❖ Restrooms
- Fire & Life Safety
  - ❖ Exiting
  - ❖ Fire Protection
  - ❖ Impacts to Adjacent Buildings
- \$20 Million Construction Budget



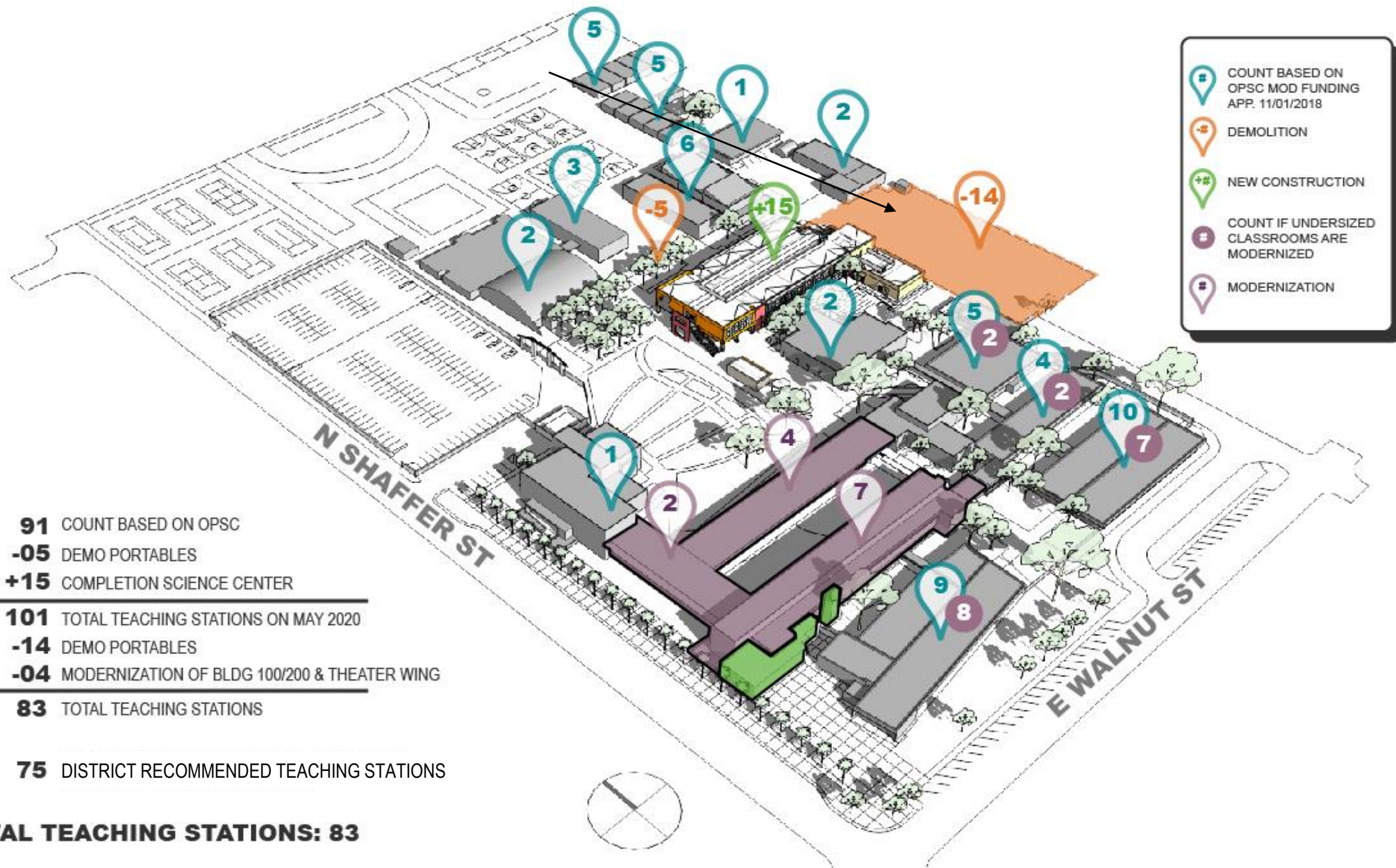

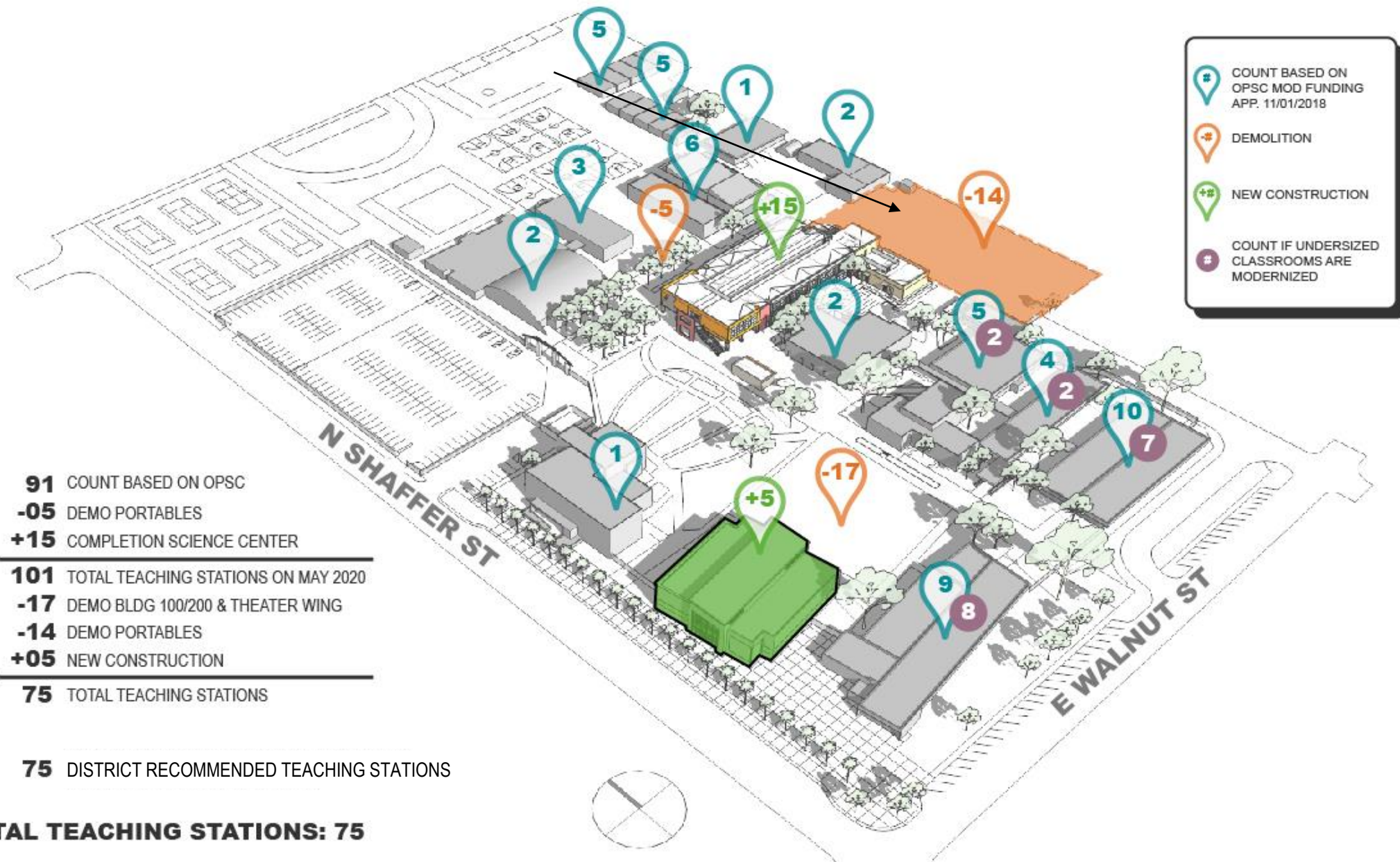



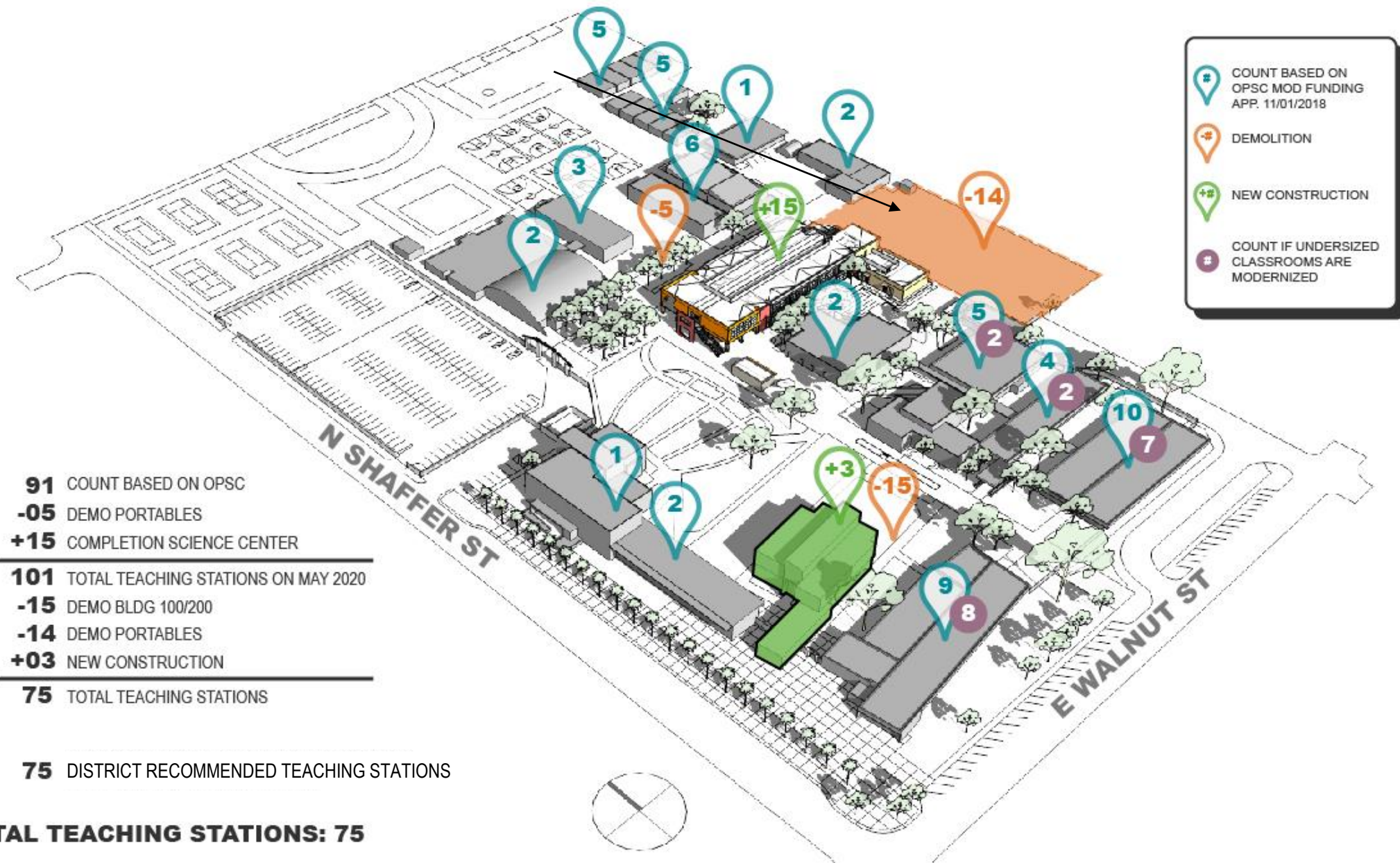



# Orange High School

"ONCE A PANTHER, ALWAYS A PANTHER"

## PHASE II

STAFF RECOMMENDED DESIGN OPTION: [OPTION 2](#)

TENTATIVE CONSTRUCTION BUDGET: **\$20,000,000**

ARCHITECT OF RECORD: [LIONAKIS](#)

Schematic Design: \$141,350

Design Development: \$238,400

Contract Documents: \$414,650

Agency Review/Bidding: \$32,200

Construction Administration/Close Out: \$317,150

Allowances (Alumni Corner/FF&E): \$72,500

Reimbursable Expenses: \$47,363

**Total Fee: \$1,450,000**

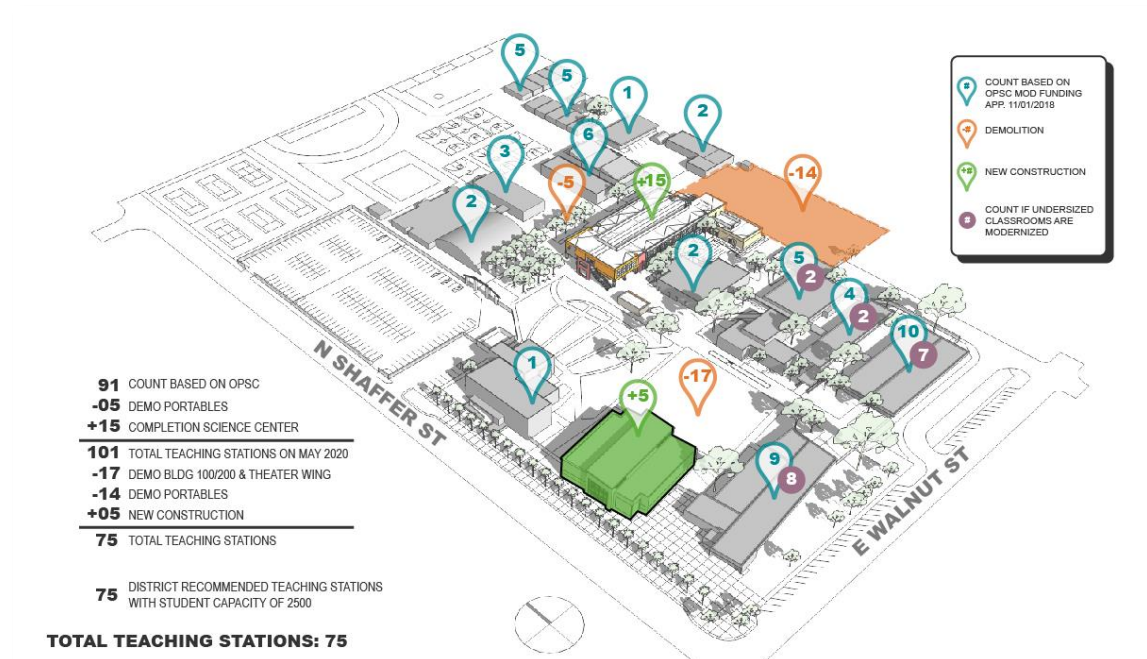

### OPTION 2 SUMMARY-

- Construction of a New, 2-Story 15-Classroom and Student Services Building
- Added Security Fencing and Single Point of Entry Created
- ZERO PORTABLE CLASSROOMS REMAIN ON SITE (Based on Enrollment Projections of under 2400 students)





CANYON HIGH SCHOOL  
HOME OF THE COMANCHES

# PHASE II

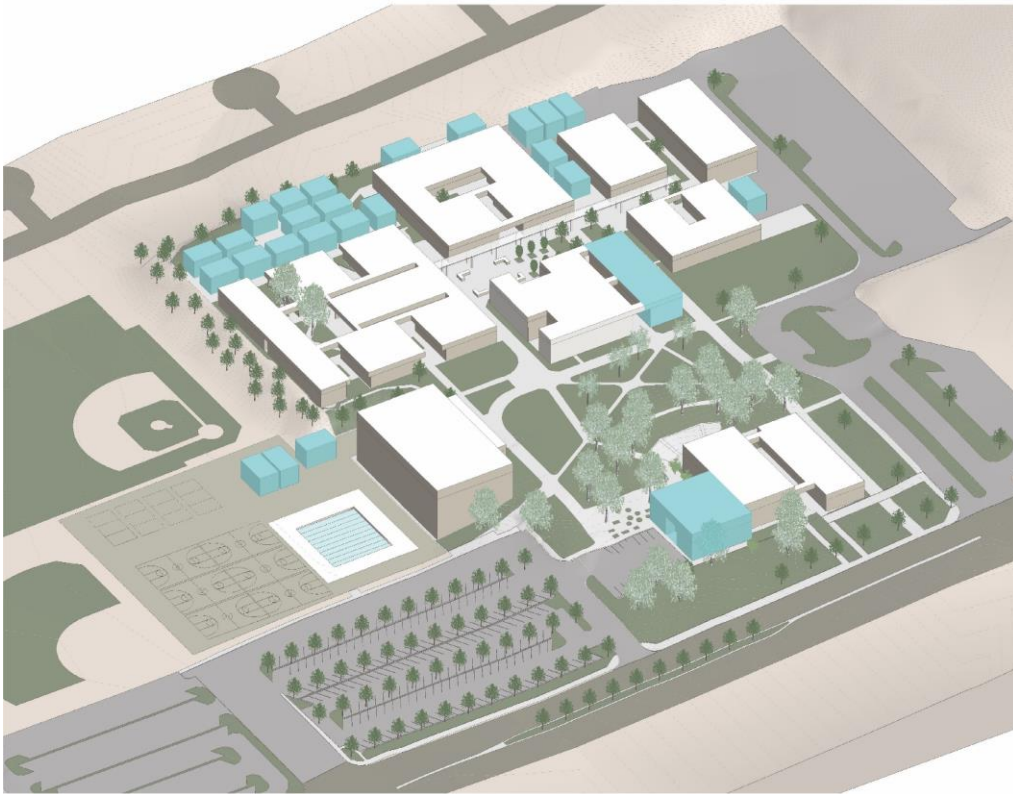

## Campus and Community

### Goals and Priorities- MASTER PLAN

- Create New 21<sup>st</sup> Century Learning Environments for STEM Curriculum
- Replace Classrooms in Portables with new facilities
- Improve Safety and Security (campus access & supervision)
- Increase Parking Quantity
- Improve Drop-off and Site Circulation

# Canyon High School

## Existing Science Building

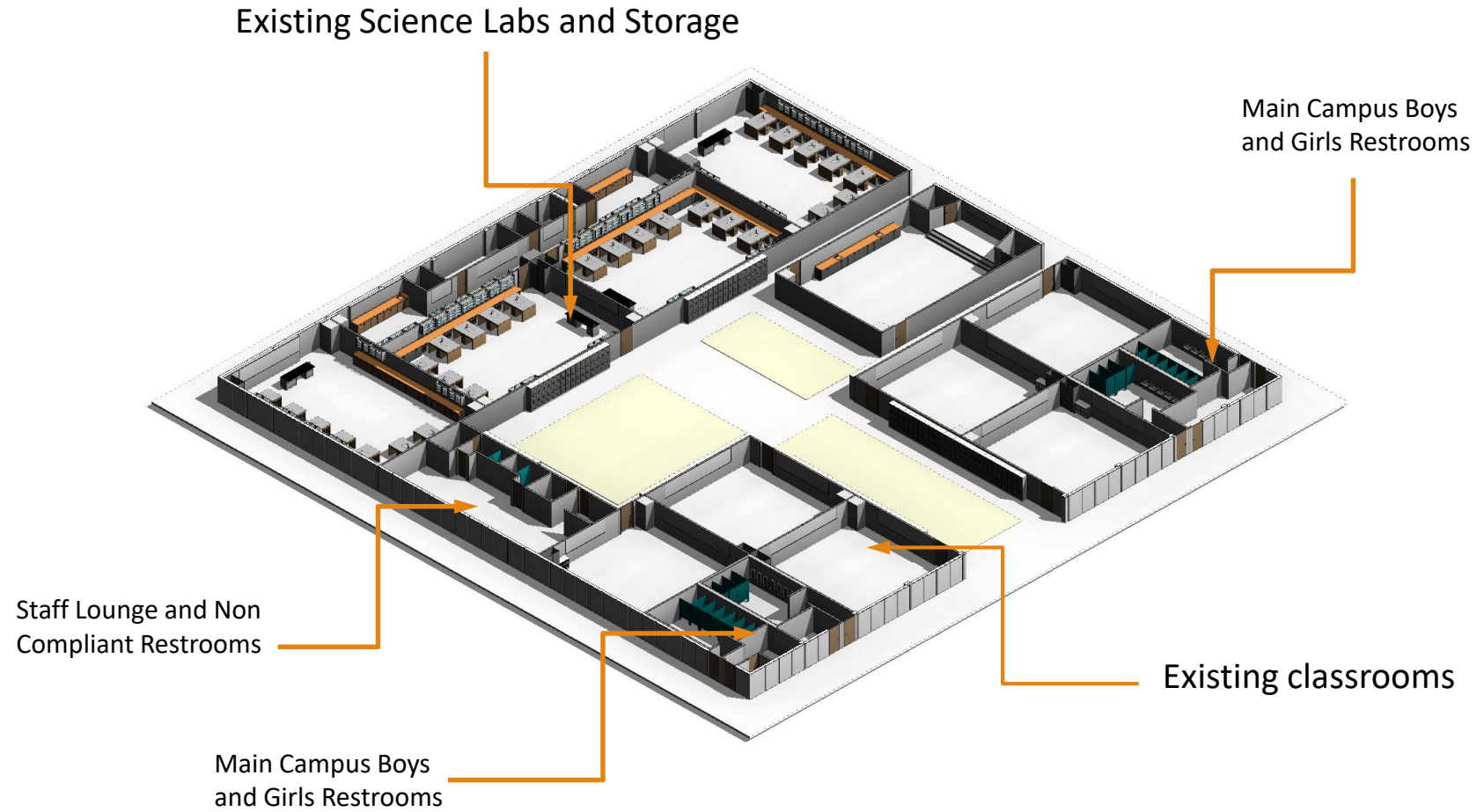



# Canyon High School

## Science Building Renovation Option 1



New classrooms including 2 additional teaching stations

Renovated Boys and Girls Restrooms

Renovated Staff Lounge and Restrooms

Renovated Boys and Girls Restrooms

Modernized classrooms

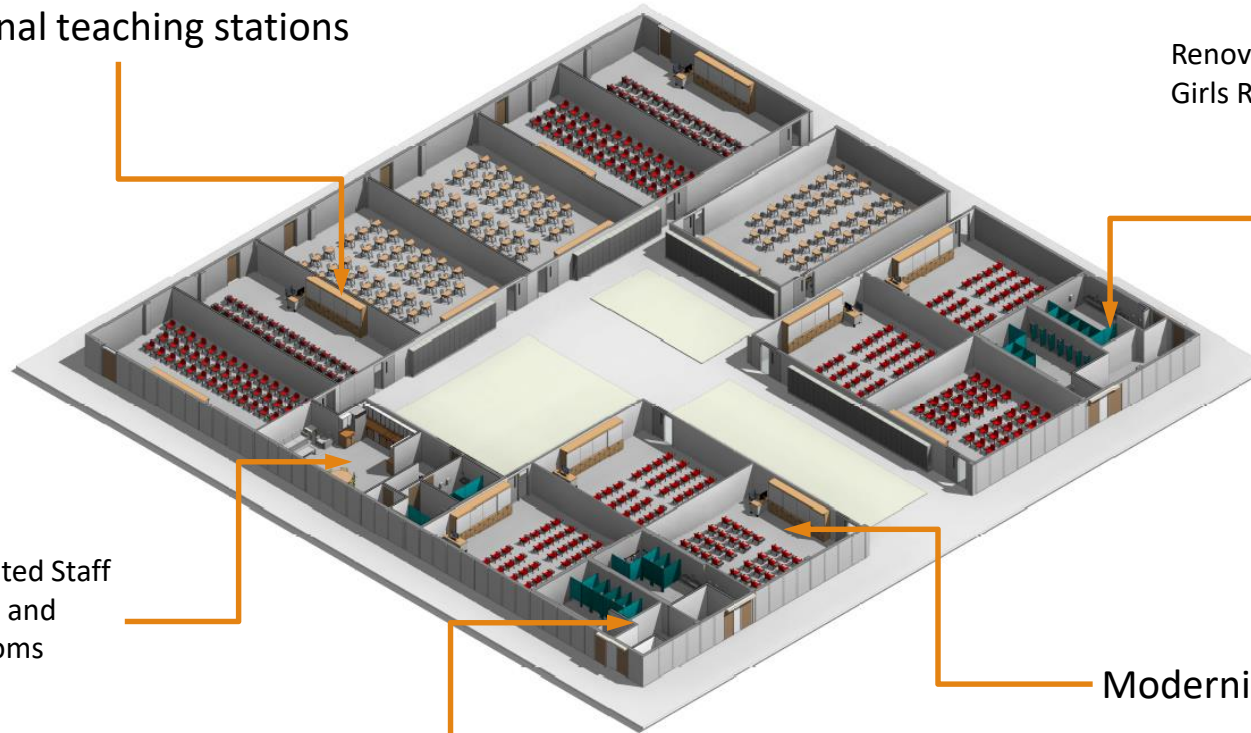

# Canyon High School

## Science Building Renovation Option 2



New classrooms including 2 additional teaching stations

Renovated Boys and Girls Restrooms

Renovated Staff Lounge and Restrooms

Renovated Boys and Girls Restrooms

Modernized classrooms

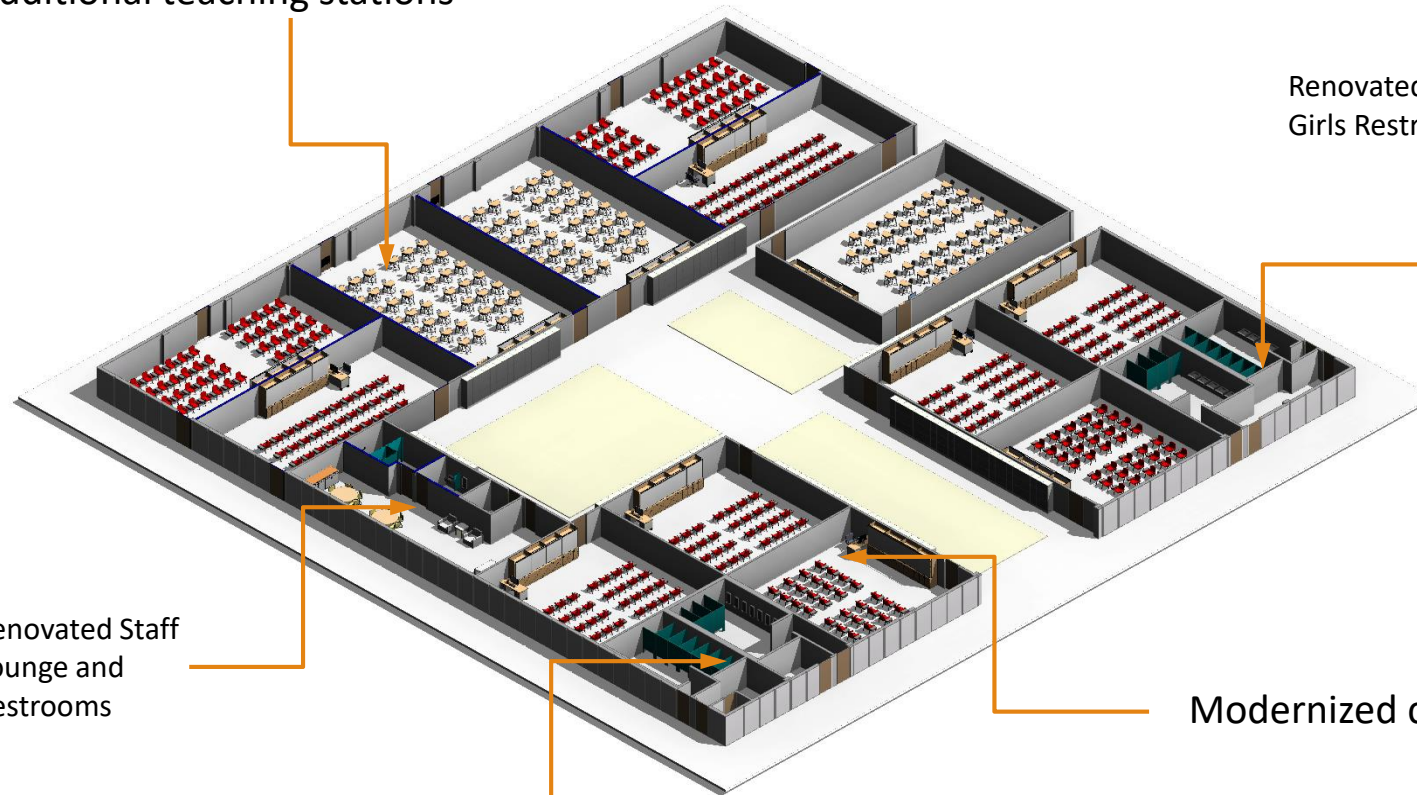





CANYON HIGH SCHOOL  
HOME OF THE COMANCHES

# PHASE II

**STAFF RECOMMENDED DESIGN OPTION: [OPTION 1](#)**

**TENTATIVE CONSTRUCTION BUDGET: \$5,000,000**

**ARCHITECT OF RECORD: [CANNON DESIGN \(Formerly gkk\)](#)**

Schematic Design: \$103,975

Design Development: \$126,500

Contract Documents: \$189,750

Agency Review/Bidding: \$37,950

Construction Administration: \$126,500

Close Out: \$6,325

Reimbursable Expenses: \$29,000

**Total Fee: \$620,000**

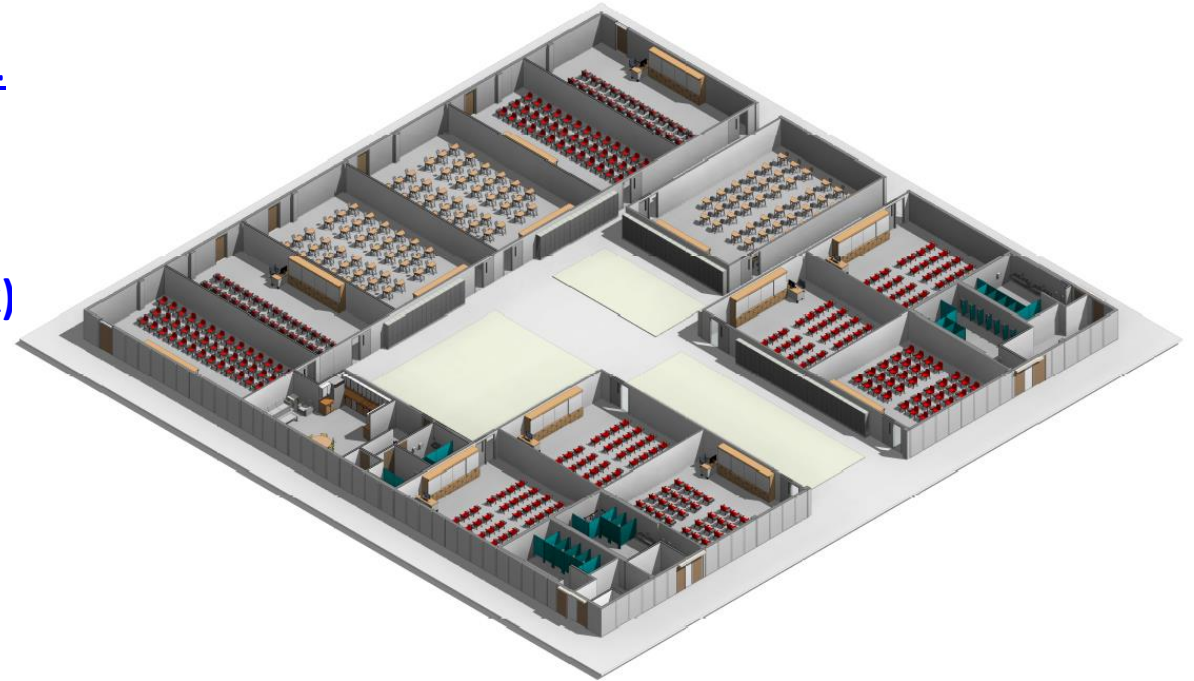

## **OPTION 1 SUMMARY-**

- Full Modernization of Old Science Classrooms in Building 200
- Renovation of Four Restrooms
- Added Security Fencing in Rear of Building
- ZERO PORTABLE CLASSROOMS REMAIN ON SITE



## EL MODENA HIGH SCHOOL

# PHASE II

### GOALS

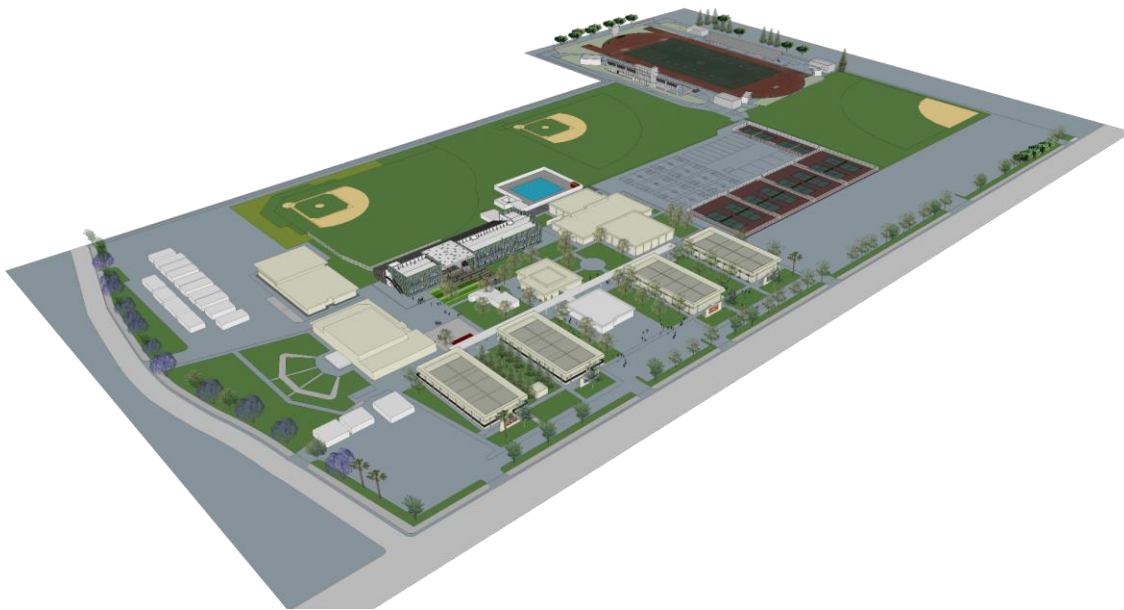

- Renew all Classroom Buildings to support 21<sup>st</sup> century learning
- Eliminate all Portable Classrooms
- Upgrade Building 800 to support Career Tech Education
- Upgrade the Library
- Expand Administration, Counselling and Career Center
- Enhance access – bridge and interconnect all two story buildings
- Enhance campus security



# PHASE 2 OPTION 1

1<sup>ST</sup> Floor



2<sup>ND</sup> Floor



## Rooms Legend

- Administrative
- Basic Classroom
- Circulation
- Classroom Support
- Library and Media
- Operational Support
- Science Classroom
- Special Education
- Specialty Classroom
- Student Support

## Scheme 1 Summary

- Existing Administrative building to be demolished
- New construction - 2 stories, 16,000 SF Administrative / Classroom building to replace existing administrative building
  - Administrative program increase from 6,100 (current) SF to 8,000 SF
  - Additional Programming: 1,600 SF of student support and teachers collaborations areas
- New construction - 3 elevators and elevated walkway
- All portable classroom buildings to be removed
- All classrooms to be located inside permanent buildings

**\$20 Million Budget – Permanent 2-Story Student Services and Classroom building**

# PHASE 2 OPTION 1



Removal of all 17 Existing Portables

Phase 2, Option 1



# PHASE 2 OPTION 2

1<sup>ST</sup> Floor

2<sup>ND</sup> Floor

## Rooms Legend

- Administrative
- Athletic
- Basic Classroom
- Circulation
- Classroom Support
- Library and Media
- Operational Support
- Science Classroom
- Special Education
- Specialty Classroom
- Student Support

## Scheme 2 Summary

- New construction - 6,700 SF, 1 story Classroom building
  - New building to be located at east side of the Library
  - Additional Programming: 1,000 SF of student support and teachers collaboration areas
- New construction - 3,300 SF administrative building expansion
  - Administrative program area increase from 6,100 (current) SF to 8,000 SF
- New construction - 2 elevators and elevated walkways
- All portable classroom buildings to be removed
- All classrooms to be located inside permanent buildings

**\$20 Million Budget -1 Story Modular Classroom Building**

## PHASE 2 OPTION 2



Aerial View from Northeast





## EL MODENA HIGH SCHOOL

# PHASE II

STAFF RECOMMENDED DESIGN OPTION: [OPTION 2](#)

TENTATIVE CONSTRUCTION BUDGET: **\$22,000,000**

ARCHITECT OF RECORD: **HARLEY ELLIS DEVEREAUX**

Schematic Design/Design Development: \$691,970

Contract Documents: \$470,560

Agency Review/Bidding: \$124,321

Construction Administration: \$424,440

Close Out: \$48,709

Reimbursable Expenses: \$40,000

**Total Fee: \$1,800,000**



### OPTION 2 SUMMARY-

- Construction of a New 6700 Square Foot Modular Classroom Building
- Moderate Renovation to ALL 2-Story Buildings (200, 300, 400, 500)
- Renovation/Addition to Student Services Building (3000 Square Feet)
- Moderate Renovation of 800 Building and Library
- ZERO PORTABLE CLASSROOMS REMAIN





## GOALS

- ❖ Smart & efficient use of resources
- ❖ Minimize number of portables
- ❖ Secure campus perimeter

- (e) fencing/wall
- new fencing – part of field improvements
- phase 1 new fencing
- phase 2 proposed new fencing



## phase 2 implementation – building 100/200 partial mod

scope:

- relocate north stairs to quad side
- add elevator
- upgrade restrooms
- ornamental fencing @ breezeways

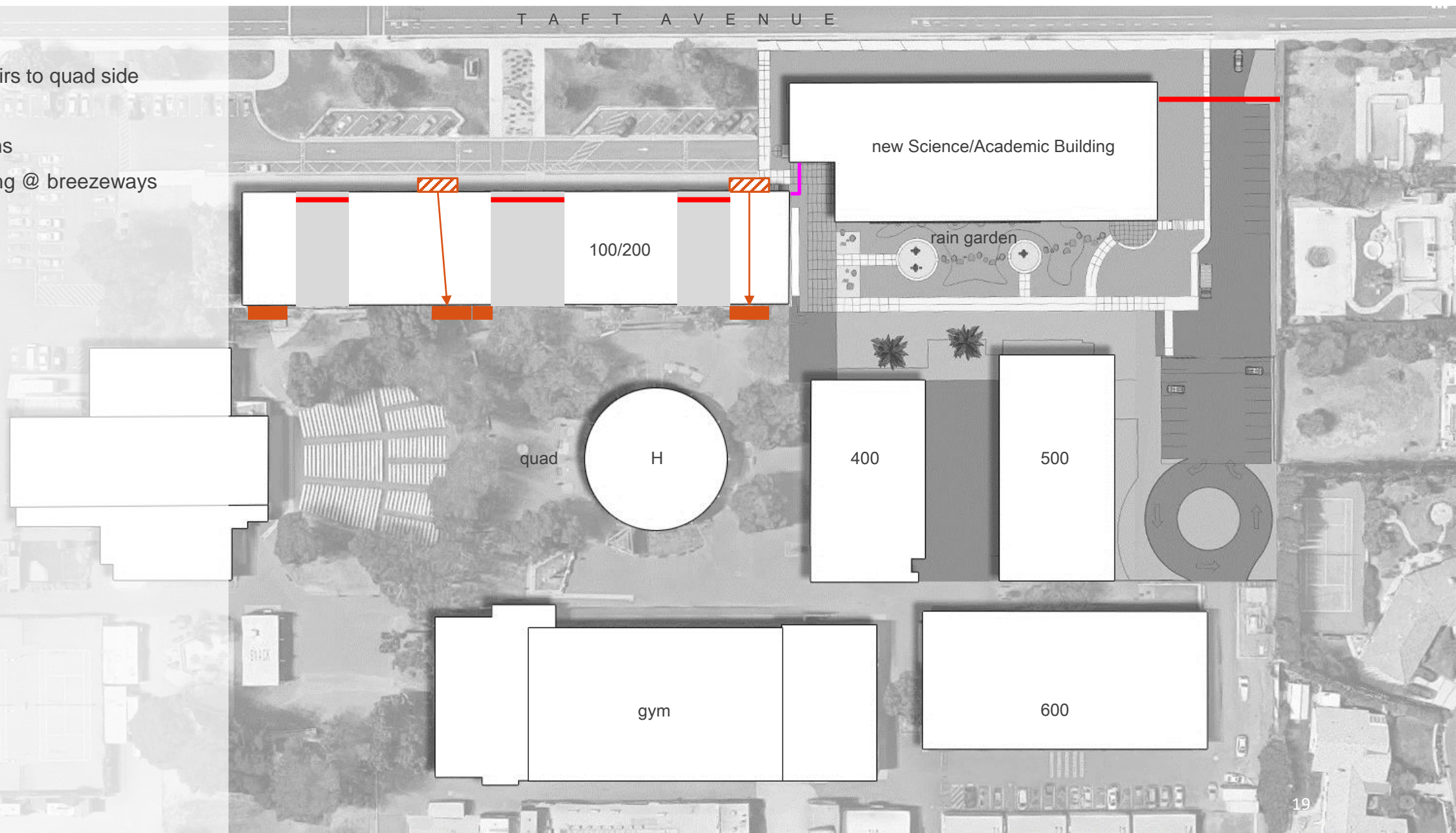





## phase 2 implementation - Option 1

### opportunities

- potential dedicated outdoor learning spaces
- frames edge of quad
- portables after phase II: 5

### Challenges

- 'hidden' by building 400
- solar orientation
- potential supervision of outdoor spaces
- visual disconnect from 'rain garden'

### portable count

after phase I: 18

after phase II: 5

after phase III: 0

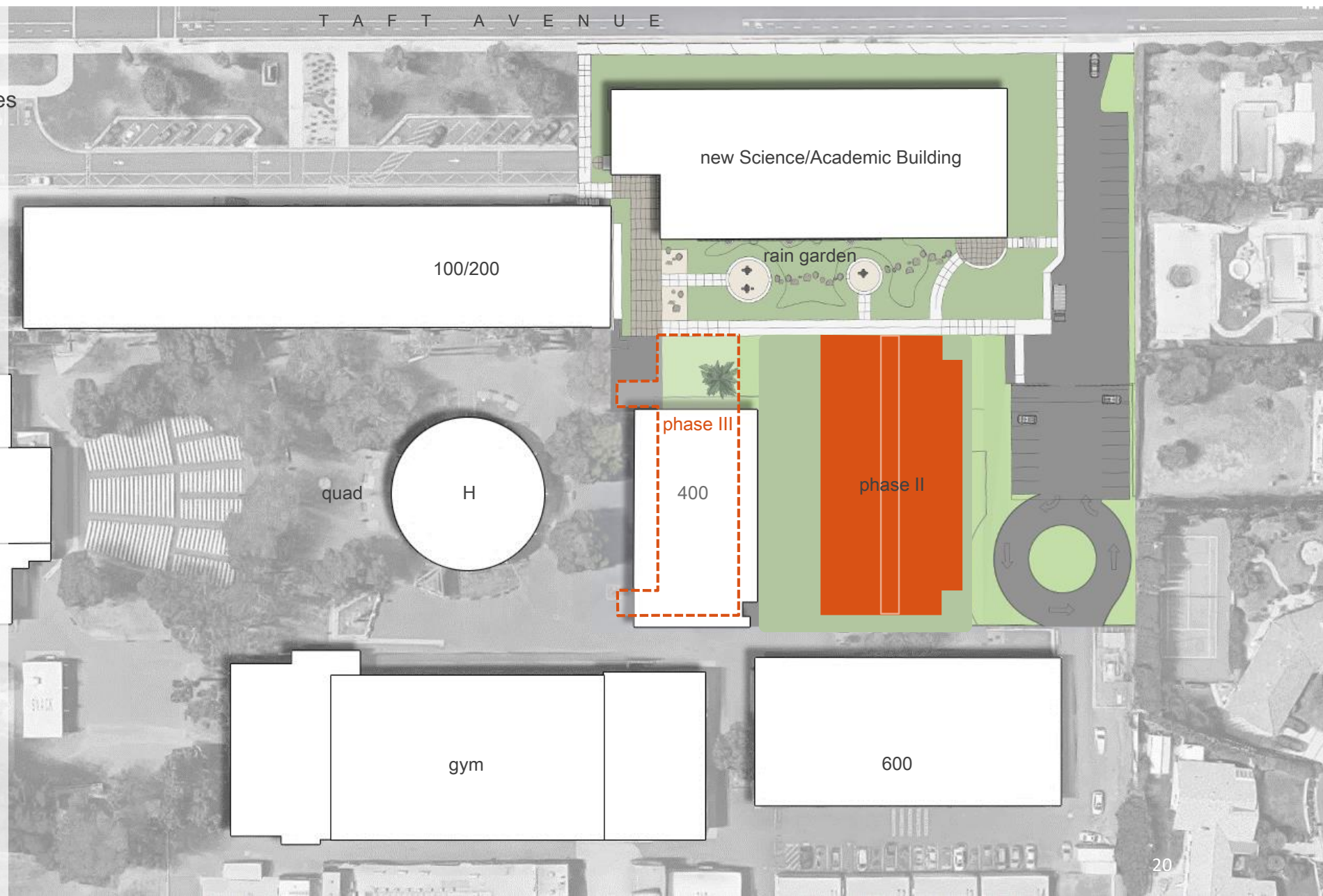





## phase 2 implementation - Option 2

### opportunities

- potential dedicated outdoor learning spaces
- exterior building circulation
- opens up to quad & rain garden
- solar orientation

### challenges

- portable count after phase II = 10
- ‘hides’ bldg. 600

### portable count

after phase I: 18

after phase II: 10

after phase III: 0





## phase 2 implementation - Option 3

### opportunities

- potential dedicated outdoor learning spaces
- partial exterior building circulation
- opens up to quad & rain garden
- ideal solar orientation for both phases
- least visual impact on neighbors

### challenges

- portable count after phase II = 10
- rework of vehicular turnaround
- 'hides' bldg. 600

### portable count

after phase I: 18

after phase II: 10

after phase III: 0

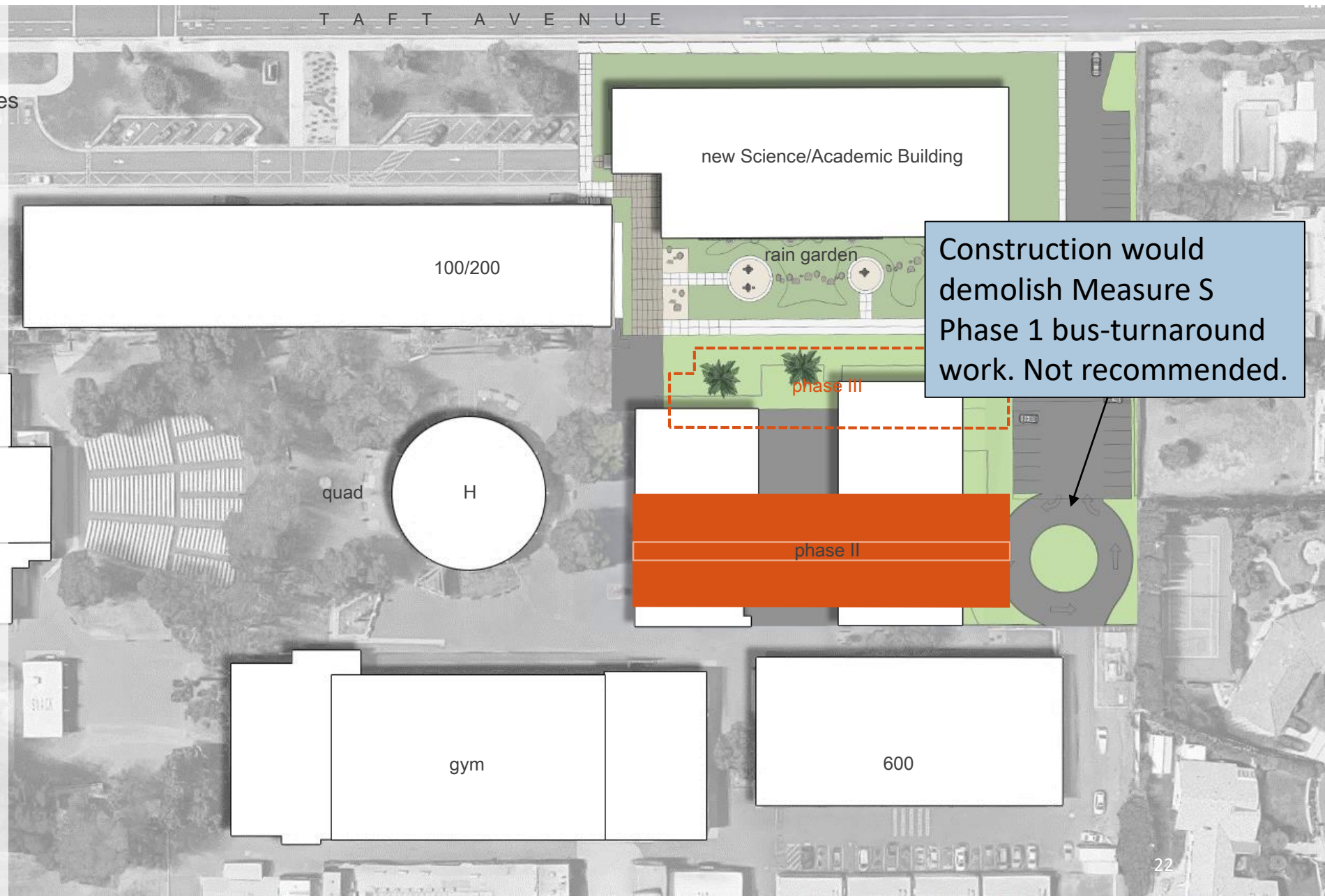





# VILLA PARK HIGH SCHOOL

# PHASE II

**STAFF RECOMMENDED DESIGN OPTION: OPTION 1**

**TENTATIVE CONSTRUCTION BUDGET: \$21,000,000**

**ARCHITECT OF RECORD: LPA**

Schematic Design: \$104,620

Design Development: \$343,213

Contract Documents: \$542,600

Agency Review/Bidding: \$32,707

Construction Administration: \$523,100

Close Out: \$32,707

Reimbursable Expenses: \$34,666

**Total Fee: \$1,800,000**

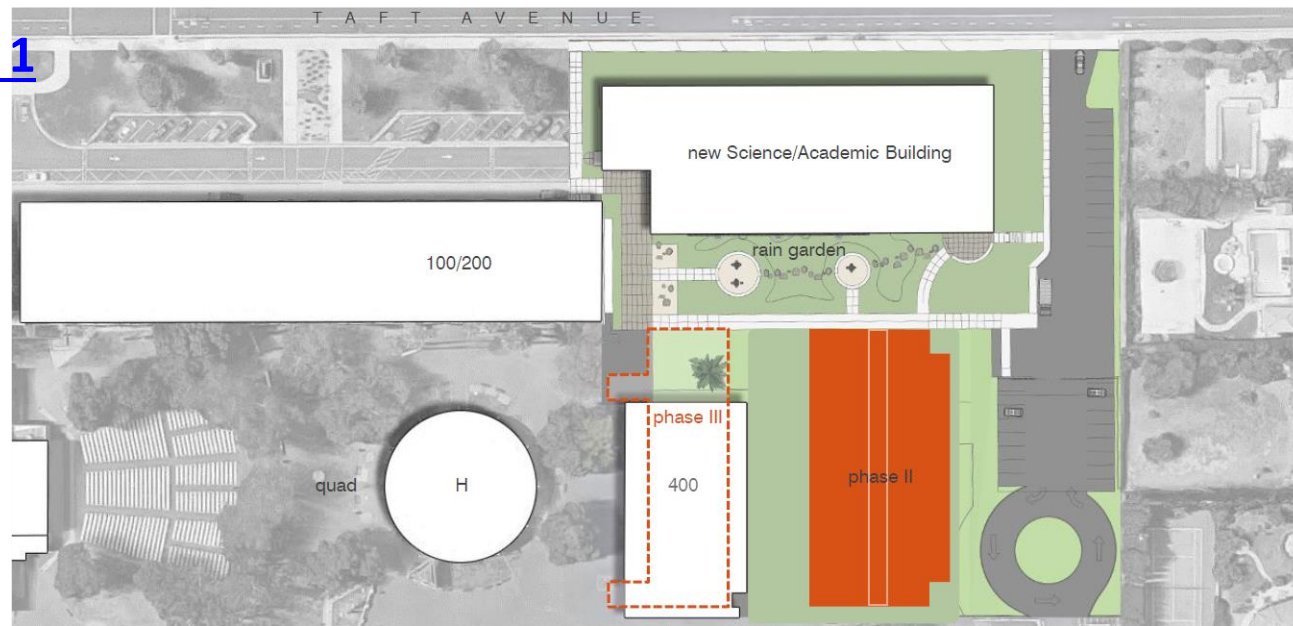

## **OPTION 1 SUMMARY-**

- Construction of a New, 2-Story 18-Classroom Building
- Required ADA and Restroom Renovations to 100/200 Building
- Added Security Fencing and Single Point of Entry Created
- 5 PORTABLE CLASSROOMS REMAIN ON SITE (Enrollment Projections Pending)





# Questions?

---