

**ORANGE UNIFIED SCHOOL DISTRICT
BOARD OF EDUCATION • REGULAR MEETING
DISTRICT EDUCATION CENTER , BLDG. H
1401 NORTH HANDY STREET • ORANGE, CA**

**THURSDAY • JANUARY 5, 2006
6:30 P.M. • CLOSED SESSION
7:30 P.M. • REGULAR SESSION**

Members of the audience are invited to address the Board of Education on agenda items when the Board considers them. Speakers are limited to three (3) minutes, with a maximum of twenty (20) minutes per topic. Persons wishing to address the Board are requested to complete and submit a blue speaker card, available on the information table, before the meeting begins.

A G E N D A

(Full copies of the agenda are available online at www.orangeusd.k12.ca.us/board/calendar.asp)

1. CALL MEETING TO ORDER - 6:30 P.M.
2. ESTABLISH QUORUM
3. PUBLIC COMMENT ON CLOSED SESSION AGENDA ITEMS
4. ADJOURN TO CLOSED SESSION
 - A. PUBLIC EMPLOYEE DISCIPLINE/DISMISSAL/RELEASE
Government Code 54957
 - B. CONFERENCE WITH LABOR NEGOTIATORS
Government Code 54957.6
Agency Negotiators: Ed Kisse; Jamie Brown; Spencer Covert, Parker & Covert LLP
Employee Organizations: a) Orange Unified Education Association
b) California School Employees Association

5. CALL TO ORDER - REGULAR SESSION - 7:30 P.M.
Please turn off pagers and cell phones during the meeting.

Mission Statement: *The Orange Unified School District, being committed to planning for continual improvement, will offer a learning environment of excellence, with high expectations, to provide each student with the opportunity to be able to compete in the global economy.*

6. PLEDGE OF ALLEGIANCE
7. REPORT OF CLOSED SESSION DECISIONS AS REQUIRED BY THE BROWN ACT
8. ADOPTION OF AGENDA

9. ANNOUNCEMENTS AND ACKNOWLEDGMENTS

- A. Superintendent's Report 1
- B. Board President's Report 1
- C. Board Recognition of Students, Staff, and Community 1
 - 1) CASTO School Bus Safety Poster Contest
- D. State of the School Report - Emily Haase, El Modena High School 1

10. APPROVAL OF MINUTES

None

11. COMMUNICATIONS TO THE BOARD

Members of the audience may address the Board of Education on items not on the agenda at this time. Speaking time is limited to three (3) minutes per speaker with a maximum of twenty (20) minutes per topic. Persons wishing to address the Board should complete and submit a blue speaker card, available on the information table, prior to the meeting. In accordance with Government Code Section 54954.3, matters not on the agenda may not be acted on or discussed by the Board, but will be researched and responded to in any one of the following ways: 1) by telephone after research; 2) by mail after research; or 3) at a subsequent Board meeting as an agenda item.

12. ACTION ITEMS

- A. (1) Resolution of Intention (I) to Establish CFD No. 2005-2 (Del Rio School District),
(II) To Levy a Special Tax and (III) to Issue Bonds
(2) Resolution of Intention to Incur Bonded Indebtness of the Proposed CFD
(2005-2 Del Rio School District 2-30
- B. School Board Policy Proposed Revision - the 2000 Series, Administration - First Reading 31-42

13. INFORMATION/DISCUSSION ITEMS

- A. Report on AVID (Advancement Via Individual Determination) 43
- B. Board of Education Self-Evaluation 44

14. CONSENT ITEMS

Consent items are acted upon by one motion. However, any such item can be considered separately at a Board member's request, in which case it will be acted upon following approval of the Consent Items.

BUSINESS SERVICES

- A. Purchase Orders List 45
- B. Warrants List 46
- C. Gifts 47-48
- D. Contract Services Report - Business Services 49
- E. Acceptance of Completed Contract(s) and Filing of Notice(s) of Completion 50-51
- F. Approval of Agreement between Orange Unified School District and Other Orange
County School Districts for Transportation Services 52

HUMAN RESOURCES

- G. Personnel Report 53-63
- H. Student Teacher Assignments/Agreements 64-65
- I. Out-of-State Travel/Conference Attendance 66-67
- J. Student Teaching Agreement - University of La Verne 68-73
- K. Teacher Assignment/Consent - Provisional Internship Permit 74-75

EDUCATIONAL SERVICE

L.	Contract Services Report: Educational Services	76
M.	Study Trips	77-78
N.	Course Approvals: Advanced Annual (Formerly Annual IV), Advance Journalism (Formerly Journalism IV), Annual I, Journalism I, Language Arts	79-81
O.	IMMEX Grant - Serrano Elementary School	82
P.	Joint Powers Agreement Between Orange Unified School District And Other Orange County Public Educational Agencies	83
Q.	Textbook Adoptions - 30-Day Review by Public	84-85
R.	Special Education Non-Public Schools & Designated Instructional Services - 2005-06	86-87
S.	Expulsion of Student: Case No. 05-06-08	88
T.	Expulsion of Student: Case No. 05-06-09	89
U.	Expulsion of Student: Case No. 05-06-10	90
V.	Expulsion of Student: Case No. 05-06-11	91
W.	Expulsion of Student: Case No. 05-06-12	92
X.	Expulsion of Student: Case No. 05-06-13	93

15. OTHER BUSINESS

- A. Board/Staff Conference and Comments

16. ADJOURNMENT**17. CALENDAR OF 2006 BOARD MEETINGS**

January 5, 2006	June 8, 2006
January 19, 2006	June 22, 2006
February 9, 2006	July 20, 2006
February 23, 2006	August 24, 2006
March 9, 2006	September 14, 2006
March 23, 2006	September 28, 2006
April 20, 2006	October 12, 2006
May 4, 2006	October 26, 2006
May 25, 2006	November 16, 2006
	December 7, 2006

ANNOUNCEMENTS
AND
ACKNOWLEDGMENTS

TOPIC: **ANNOUNCEMENTS & ACKNOWLEDGMENTS**

DESCRIPTION: **9.A. Superintendent's Report**

9.B. Board President's Report

**9.C. Board Member Recognition of Students,
Staff, and Community**
1) CASTO School Bus Safety Poster Contest

9.D. State of the School Report
Emily Haase, El Modena High School

ACTION ITEMS

TOPIC: (1) RESOLUTION OF INTENTION (I) TO ESTABLISH CFD NO. 2005-2 (DEL RIO SCHOOL DISTRICT), (II) TO LEVY A SPECIAL TAX AND (III) TO ISSUE BONDS

(2) RESOLUTION OF INTENTION TO INCUR BONDED INDEBTEDNESS OF THE PROPOSED CFD (2005-2 DEL RIO SCHOOL DISTRICT)

DESCRIPTION: On November 18, 2004, the Board of Education approved a School Impact Mitigation Agreement with North Orange Del Rio, LLC, ("Company") whereby the School District would be the lead agency for a Community Facilities District encompassing approximately 73 acres of property proposed for construction of approximately 716 mixed residential units. It is proposed that the CFD be formed for the acquisition and construction of school facilities. The Landowner has submitted a petition requesting the School District undertake proceedings relating to the formation of the CFD at his time.

The principal, interest and other periodic costs of issuance for up to \$9,000,000 of the bonds proposed in the CFD will be issued in one series to finance the acquisition, design, construction, lease, improvement and/or equipping of school facilities directly or indirectly impacted by the Project.

In order to fund the costs of the purposes outline above and the costs of issuance and other related costs of the proposed CFD the Landowner further requests the Board of Education of the School District to levy an annual special tax in accordance with the procedures required in the Mello-Roos Facilities Act of 1982, as amended, commencing with Section 53311 of the California Government Code.

The Company has previously agreed to advance the costs of the formation of the CFD with the amount of the costs reimbursable to the Company, without interest, from the proceeds of the CFD when formed.

FISCAL IMPACT: No financial impact to the District. All costs of issuance and other expenses related to CFD No. 2005-2 will be funded by the proceeds of the bond sale. The Resolutions initiate the process for formation of CFD No. 2005-2 and call a public hearing for February 9, 2006, at which the Board will consider formation of CFD No. 2005-2, the proposed levy of the special tax within CFD No. 2005-2 and the necessity to incur bonded indebtedness. Attached to the Resolution of Intention to Establish the CFD are exhibits which include a map showing the proposed boundaries of the CFD, a description of the authorized facilities and the proposed Rate and Method of Apportionment of the Special Tax.

RECOMMENDATION: It is recommended that the Board of Education approve each Resolution (attached) and call for the public hearing on February 9, 2006.

OUSD/Archibald/Christensen
Board Agenda
January 5, 2006

RESOLUTION NO. 30-05-06

A RESOLUTION OF THE ORANGE UNIFIED SCHOOL DISTRICT DECLARING ITS INTENTION (i) TO ESTABLISH COMMUNITY FACILITIES DISTRICT NO. 2005-2 (DEL RIO SCHOOL FACILITIES) OF THE ORANGE UNIFIED SCHOOL DISTRICT, (ii) TO LEVY A SPECIAL TAX TO PAY FOR CERTAIN PUBLIC FACILITIES AND (iii) TO ISSUE BONDS SECURED BY A SPECIAL TAX TO FINANCE CERTAIN FACILITIES

WHEREAS, the Board of Education (the “Board”) of the Orange Unified School District (the “School District”) proposes to establish Community Facilities District No. 2005-2 (Del Rio School Facilities) of the Orange Unified School District under and pursuant to the terms and provisions of the “Mello-Roos Community Facilities Act of 1982” (the “Act”), being Chapter 2.5, Part 1, Division 2, Title 5 of the Government Code of the State of California;

WHEREAS, the Board has been advised that certain property owners have requested that an area more particularly described herein be established as a new Community Facilities District, hereinafter referred to as “Community Facilities District No. 2005-2 (Del Rio School Facilities) of the Orange Unified School District” (“CFD No. 2005-2”), and that a rate and method of apportionment of the special tax to be levied therein be established and the Board desires to provide for CFD No. 2005-2 and to establish the maximum indebtedness which may be incurred with respect thereto;

WHEREAS, the Board had previously received a Petition (including Consent and Waiver); and

WHEREAS, the Board has determined to institute proceedings to provide for formation of CFD No. 2005-2 and has determined to set a date, time and place for a public hearing relating thereto.

NOW, THEREFORE, BE IT RESOLVED by the Board of Education of the Orange Unified School District as follows:

Section 1. All of the above recitals are true and correct.

Section 2. The Petition (including Consent and Waiver) (the “Petition”) of landowners within proposed CFD No. 2005-2 is hereby accepted and the Board hereby determines that the public convenience and necessity require that all of the property referenced in said Petition be incorporated within CFD No. 2005-2 and proceedings are hereby initiated pursuant to the authorization of the Act to establish CFD No. 2005-2.

Section 3. The boundaries of the territory included in CFD No. 2005-2 are more particularly described and shown on that certain map entitled “Proposed Boundaries of Community Facilities District No. 2005-2 (Del Rio School Facilities), Orange Unified School District, Orange County, State of California” to be recorded in the Book of Maps of Assessment and Community Facilities Districts in the office of the County Recorder of the County of

Orange, California, a copy of which is attached hereto as Exhibit A and incorporated herein and made a part hereof.

Section 4. The Board has previously adopted local goals and policies for community facilities district financings as required by Government Code Section 53312.7.

Section 5. It is the intention of the Board to consider establishing CFD No. 2005-2. At the conclusion of the public hearing described below, the Board shall determine whether to form CFD No. 2005-2 and establish the rate and method of apportionment of special tax to be applicable within CFD No. 2005-2.

Section 6. The Clerk of the Board is hereby authorized and directed to endorse the Certificate on the map of CFD No. 2005-2, a copy of which is attached as Exhibit A, evidencing the date and adoption of this resolution of intention (the "Resolution") and is further authorized and directed to file said map with the County Recorder of the County of Orange in accordance with the provisions of Section 3110.5 and 3113.5 of the California Streets and Highways Code within 15 days of the adoption of this Resolution and not later than 15 days prior to the date of the public hearing relating to the proceedings as set forth in Section 15 hereof.

Section 7. It is the intention of the Board to order the acquisition, installation and construction of certain public facilities (the "Facilities") with an estimated useful life of five (5) years or longer, which are public facilities that the School District is authorized by law to construct, own or operate. A description of the types of Facilities to be constructed or acquired by CFD No. 2005-2 is set forth in Exhibit B, attached hereto and incorporated herein and made a part hereof.

The Facilities are necessary to meet increased demand placed upon the School District as a result of development occurring within CFD No. 2005-2. The cost of acquiring, constructing and installing the Facilities includes incidental expenses of the Facilities as set forth in Exhibit B hereto.

Section 8. The Executive Director, Facilities and Planning, shall coordinate a study by interested School District departments and other public agencies of CFD No. 2005-2 and, at or prior to the public hearing on formation of CFD No. 2005-2, a report (the "Public Report") which shall contain a brief description of the Facilities by type which are required to adequately meet the needs of CFD No. 2005-2, and an estimate of the cost for providing the Facilities and an estimate of the incidental expenses related thereto shall be considered by the Board. Reference is hereby made to the Public Report and, upon its presentation, it shall be made a part of the record of the public hearing held to consider formation of CFD No. 2005-2.

In the opinion of the Board, the public interest will not be served by allowing the property owners in CFD No. 2005-2 to enter into a contract pursuant to Section 53329.5 of the Act to do the work to be financed by CFD No. 2005-2.

Section 9. It is the intention of the Board that, except where funds are otherwise available, a special tax sufficient to pay for all Facilities, including the payment of interest on and principal of bonds proposed to be issued to finance the Facilities and the repayment of funds advanced to or on behalf of CFD No. 2005-2, the replenishment of any reserve fund established

for bonds, and the payment of annual administration expenses of the School District and CFD No. 2005-2 in determining, apportioning, levying and collecting such special taxes, will be levied annually within the boundaries of CFD No. 2005-2 secured by recordation of a continuing lien against all nonexempt real property in CFD No. 2005-2. The rate, method of apportionment and manner of collection of such proposed special tax for CFD No. 2005-2 is set forth in Exhibit C, attached hereto and incorporated herein and made a part hereof. Exhibit C provides sufficient detail to allow each landowner or resident within CFD No. 2005-2 to estimate the maximum amount that such person will have to pay for the Facilities.

The special tax shall be collected in the same manner as ordinary *ad valorem* property taxes are collected and shall be subject to the same penalties and the same procedure, sale and lien priority in case of delinquency as is provided for *ad valorem* taxes as such procedure may be modified by law or by the Board from time to time.

The special tax as apportioned to each parcel pursuant to Exhibit C is apportioned on the basis of benefit as permitted by Section 53325.3 of the Act and the apportionment of the special tax is not on or based upon the value or ownership of real property. In the event that property within CFD No. 2005-2 is acquired or dedicated to a public agency subsequent to the date of formation of CFD No. 2005-2, it may become exempt and no longer subject to the special tax, pursuant to the provisions of the rate and method of apportionment attached hereto as Exhibit C. The special tax obligation on any parcel, if the Board so elects, may be prepaid and eliminated according to the methodology and conditions specified by the Board in the rate and method of apportionment by payment of the amount so calculated to the School District or its designated paying agent for CFD No. 2005-2 and utilized to call or defease bonds to the full extent of such payment on the earliest date on which such call or defeasance can be accomplished.

The maximum special tax applicable to a parcel to be used for private residential purposes, as set forth in Exhibit C, is specified as a dollar amount which shall be calculated and established not later than the date on which the parcel is first subject to tax because of its use for private residential purposes, and such amount shall not be increased over time by an amount in excess of 2 percent per year. The special tax shall be levied for a period of three (3) Fiscal Years past the life of the bonds, provided the tax year after which no further special tax shall be levied to pay for Facilities against any parcel used for private residential purposes is Fiscal Year 2051-52, except that a special tax that was levied on or before the final tax year and that remains delinquent may be collected in subsequent years. Under no circumstances will the special tax to be levied against any parcel subject to the foregoing sentence be increased as a consequence of delinquency or default by the owner of any other parcel or parcels within CFD No. 2005-2 by more than 10 percent. As specified by the Act, for purposes of this paragraph, a parcel shall be considered "used for private residential purposes" not later than the date on which an occupancy permit for private residential use is issued.

Section 10. It is the intention of the Board, pursuant to Section 53317.3 of the Act, to levy the proposed special tax on property that is not otherwise exempt from the proposed special tax and that is acquired by a public entity through a negotiated transaction, or by gift or devise.

Section 11. It is the intention of the Board, pursuant to Section 53317.5 of the Act, to treat any special tax levied against property that is acquired by a public entity through

eminent domain proceedings as if it were a special annual assessment pursuant to Section 1265.250 of the Code of Civil Procedure of the State of California.

Section 12. It is the intention of the Board, pursuant to Section 53340.1 of the Act, to levy the proposed special tax on the leasehold or possessory interests in property owned by a public agency, which property is otherwise exempt from the special tax.

Section 13. The Board hereby declares that the public convenience and necessity require and it is necessary that a bonded indebtedness be incurred to finance all or a portion of the Facilities for CFD No. 2005-2. The purpose for the proposed bonded indebtedness for CFD No. 2005-2 is to finance the acquisition, installation and/or construction of the Facilities, having an estimated useful life of five years or longer, including planning work directly related to the Facilities and all related incidental expenses, as authorized by the Act, as more specifically described in Exhibit B hereto.

Section 14. The aggregate amount of the proposed bonded indebtedness to be incurred for CFD No. 2005-2 (including incidental expenses as authorized by the Act) shall not exceed \$9,000,000. Pursuant to Section 53351(c) of the Act, the Board hereby declares its intention that CFD No. 2005-2 will pay for the bonded indebtedness to finance the Facilities.

Section 15. Notice is given that on the 9th day of February, 2006, at the hour of 7:30 o'clock p.m., or as soon thereafter as the matter may be heard, at the regular meeting place of the Board, 1401 North Handy Street, Orange, California, a public hearing will be held at which the Board shall consider the formation of CFD No. 2005-2, the proposed levy of the special tax within CFD No. 2005-2, the necessity to incur bonded indebtedness and all other matters as set forth in this Resolution. At the above-mentioned time and place for such public hearing, any persons interested, including all taxpayers, property owners and registered voters within CFD No. 2005-2, may appear and be heard, and the testimony of all interested persons or taxpayers for or against the formation of CFD No. 2005-2, the boundaries of CFD No. 2005-2, the levy of the special tax in CFD No. 2005-2, the acquisition, installation or construction of Facilities, the necessity to incur bonded indebtedness or on any other matters set forth herein, will be heard and considered.

Any protests may be made orally or in writing, except that any protests pertaining to the regularity or sufficiency of such proceedings shall be in writing and shall clearly set forth the irregularities and defects to which the objection is made. All written protests shall be filed with the Clerk on or before the time fixed for such public hearing, and any written protest may be withdrawn in writing at any time before the conclusion of such public hearing.

If written protests against the formation are filed by fifty percent (50%) or more of the registered voters, or six (6) registered voters, whichever is greater, residing within CFD No. 2005-2 or by the owners of one-half (½) or more of the area of land in the territory included within CFD No. 2005-2, and such protests are not withdrawn so as to reduce the protests to less than a majority, no further proceedings shall be undertaken for a period of one year from the date of decision of the Board.

Section 16. If, following the public hearing described herein, the Board determines to form CFD No. 2005-2 and proposes to levy a special tax within CFD No. 2005-2 and to incur bonded indebtedness, the Board shall then submit the levy of the special tax and the necessity to incur bonded indebtedness to the qualified electors within the boundaries of CFD No. 2005-2. If at least twelve (12) persons, who need not necessarily be the same twelve (12) persons, have been registered to vote within the boundaries of CFD No. 2005-2 for each of the ninety (90) days preceding the close of the public hearing, the vote shall be by registered voters of CFD No. 2005-2 with each voter having one (1) vote. Otherwise, the vote shall be a mailed ballot election, consistent with Section 53327.5 of the Act, by the landowners of CFD No. 2005-2 who are the owners of record at the close of the public hearing, with each landowner having one (1) vote for each acre or portion of an acre of land owned within CFD No. 2005-2. The number of votes to be voted by a particular landowner shall be specified on the ballot provided to that landowner.

Section 17. Notice of the time and place of the public hearing shall be given by the Clerk in the following manner: A Notice of Public Hearing in the form required by Section 53322 of the Act shall be published in the Orange County Register, a newspaper of general circulation published in the area of CFD No. 2005-2, which such publication shall be made pursuant to Section 6061 of the Government Code, and shall be completed at least seven (7) days prior to the date set for such public hearing.

Section 18. Section 53314.9 of the Act provides that, at any time either before or after the formation of a community facilities district, the legislative body of the local agency conducting the proceedings to form such community facilities district may accept advances of funds from any source, including, but not limited to, private persons or private entities and may provide, by resolution, for the use of those funds for any authorized purpose, including, but not limited to, paying any cost incurred by such local agency in creating such community facilities district. CFD No. 2005-2 may repay the funds received pursuant to the Deposit and Reimbursement Agreement previously approved by the Board, if the Board determines to form the CFD No. 2005-2 and if the voters of CFD No. 2005-2 approve the proposed special tax at the election to be conducted pursuant to the Act.

Section 19. Based on information furnished to the School District it is anticipated that there will be less than 12 registered voters within the boundaries of CFD No. 2005-2 and that the election will be among landowner voters. Contingent on such finding, the Board hereby appoints the District Superintendent, or such District officer or employee as the Superintendent shall designate, to serve as the election official (the "Election Official") for the election pursuant to Government Code Section 53326. Pursuant to Section 53326(d) the Board may determine to distribute the ballots for such election by mail or other delivery service.

Section 20. Pursuant to the Local Agency Special Tax and Bond Accountability Act, Section 50075.1 et seq. of the California Government Code, (a) the ballot measure referred to herein shall contain a statement indicating the specific purposes of the special taxes, (b) the special taxes shall be applied only to the purposes specified in the ballot measure, (c) there shall be created by CFD No. 2005-2 an account into which proceeds of the special tax levies will be deposited, and (d) the Executive Director, Facilities and Planning, is hereby directed to cause an annual report to be provided to the legislative body of CFD No. 2005-2 as required by Section 50075.3 of the California Government Code.

Section 21. The Board hereby determines that the formation of CFD No. 2005-2, the levy of special taxes and the issuance of bonds for facilities in accordance with Section 15061 of the California Environmental Quality Act ("CEQA") Guidelines are not a "project," as defined in Section 15378 of the CEQA Guidelines, and are therefore exempt from the requirements of CEQA. Applicable CEQA requirements shall be satisfied prior to the issuance of bonds by CFD No. 2005-2. Pursuant to CEQA Guidelines Sections 15061(d) and 15062, the Executive Director, Facilities and Planning is hereby directed to cause a Notice of Exemption to be prepared, executed and filed in regard to the foregoing determination.

Section 22. The officers of the School District and their authorized representatives, are, and each of them acting alone is, hereby authorized to execute any and all documents and agreements and do and perform any and all acts and things, from time to time, consistent with this Resolution and necessary or appropriate to carry the same into effect and to carry out its purpose.

Section 23. This Resolution shall take effect immediately upon its adoption.

PASSED, APPROVED AND ADOPTED, by the Board of Education of the Orange Unified School District at a meeting held on the 5th day of January, 2006.

Kimberlee Nichols, President of the Board of
Education of the Orange Unified School
District

ATTEST:

Wes Poutsma, Clerk of the Board of Education
of the Orange Unified School District

CLERK'S CERTIFICATE

I, Wes Poutsma, Clerk of the Board of Education of the Orange Unified School District, Orange County, California, hereby certify that the foregoing Resolution is a full, true and correct copy of a resolution duly adopted at a regular meeting of the Board of said School District duly and regularly held on the 5th day of January, 2006, of which meeting all of the members of said Board had due notice and at which a majority thereof were present; and that at said meeting said resolution was adopted by the following vote:

AYES:

NOES:

ABSENT:

ABSTAIN:

An agenda of said meeting was posted at least 72 hours before said meeting at 1401 North Handy Street, Orange, California, locations freely accessible to members of the public, and a brief general description of said resolution appeared on said agenda.

I further certify that I have carefully compared the same with the original minutes of said meeting on file and of record in my office; that the foregoing resolution is a full, true and correct copy of the original resolution adopted at said meeting and entered in said minutes; and that said resolution has not been amended, modified or rescinded since the date of its adoption, and the same is now in full force and effect.

Dated: _____, 2006

Wes Poutsma, Clerk of the Board of
Education of the Orange Unified School
District

EXHIBIT A
BOUNDARY MAP
OF COMMUNITY FACILITIES DISTRICT

PROPOSED BOUNDARIES OF
COMMUNITY FACILITIES DISTRICT NO. 2005-2 (DEL RIO SCHOOL FACILITIES)
OF ORANGE UNIFIED SCHOOL DISTRICT
ORANGE COUNTY, CALIFORNIA

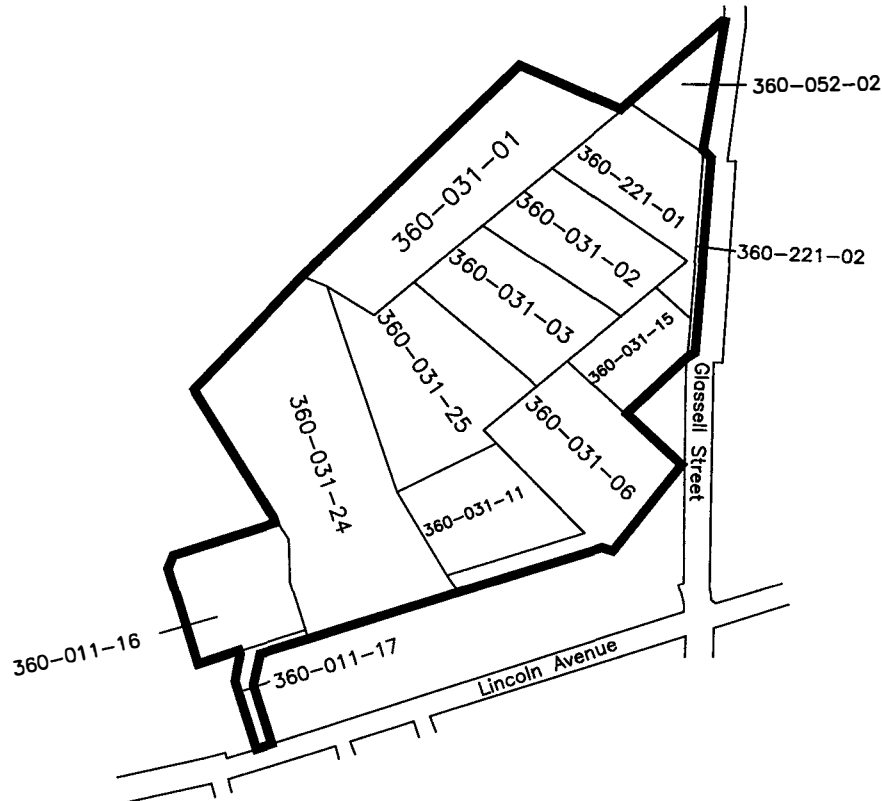

(1) Filed in the office of the Clerk of the Board of Education this ____ day of ____, 20__.

Clerk of the Board of Education

(2) I hereby certify that the within map showing the proposed boundaries of Community Facilities District No. 2005-2 (Del Rio School Facilities), of Orange Unified School District, Orange County, State of California, was Approved by the Board of Education at a regular meeting thereof, held on this ____ day of ____, 20__, by its Resolution No. _____.

Clerk of the Board of Education

(3) Filed this ____ day of ____, 20__, at the hour of ____ o'clock __m, in Book ____ of Maps of Assessment and Community Facilities Districts at page ____ and as Instrument No. ____ in the office of the County Recorder of Orange County, State of California.

County Recorder of Orange County

Reference is hereby made to the Assessor maps of the County of Orange for an exact description of the lines and dimensions of each lot and parcel.

PREPARED BY
DAVID TAUSSIG & ASSOCIATES, INC.

LEGEND

	Boundaries of Community Facilities District No. 2005-2 (Del Rio School Facilities) of Orange Unified School District
	Assessor Parcel Line
000-000-00	Assessor Parcel Number

EXHIBIT B
DESCRIPTION OF FACILITIES
FOR COMMUNITY FACILITIES DISTRICT NO. 2005-2
(DEL RIO SCHOOL FACILITIES)
OF THE ORANGE UNIFIED SCHOOL DISTRICT

The proposed project involves creation of a Mello-Roos Community Facilities District (hereinafter referred to as "CFD No. 2005-2") to finance the acquisition, installation and construction of public school facilities, and include all facilities authorized by the Act. All facilities shall have a useful life in excess of five years. The improvements which can be acquired and constructed include, but are not limited to, the following: school facilities, sites, site improvements and classroom furnishings and equipment (including to the extent permitted by law, vehicles and computer equipment) and including landscaping, access roadways, drainage, sidewalks and gutters, utility lines, playground areas and equipment, classrooms, recreational facilities, on-site office space at a school, central support and administrative facilities, interim housing and transportation facilities.

The facilities listed in this Exhibit are representative of the types of improvements to be furnished by CFD No. 2005-2. Addition, deletion or modification of descriptions of facilities may be made consistent with the requirements of the School District, CFD No. 2005-2 and the Act.

Financing Costs and Incidentals:

Costs and expenses necessary to form CFD No. 2005-2, authorize the special tax and the issuance of notes or bonds, and relating to authorized facilities including environmental proceedings, and related "soft costs," including but not limited to, preliminary engineering, soils engineering and testing, aerial photography, construction surveys, staking, insurance and bonding, plan check and inspection fees, other public agency plan check or inspection fees, plan design, design consultant fees, engineering, construction and project management, property owner and agency coordination, title reports, title insurance, appraisals, market absorption studies, special tax consultants, School District administrative charges, legal costs, reserve funds, interest during construction, underwriter's discounts, underwriter's counsel, rating agency, bond insurance, credit support, trustee fees and expenses, fiscal or paying agent fees and expenses, printing and mailing costs for disclosure statements, and note and bond printing, and including the determination of the amount of any special taxes to be levied, the cost of collecting any special taxes, and costs otherwise incurred in order to carry out the authorized purposes of CFD No. 2005-2, together with any other expenses incidental to the acquisition, installation, construction, completion and inspection of the facilities.

EXHIBIT C

**RATE AND METHOD OF APPORTIONMENT
OF SPECIAL TAX FOR COMMUNITY FACILITIES DISTRICT NO. 2005-2
(DEL RIO SCHOOL FACILITIES)
OF THE ORANGE UNIFIED SCHOOL DISTRICT**

**RATE AND METHOD OF APPORTIONMENT FOR
COMMUNITY FACILITIES DISTRICT NO. 2005-2
(DEL RIO SCHOOL FACILITIES)
OF ORANGE UNIFIED SCHOOL DISTRICT**

The following sets forth the Rate and Method of Apportionment for the levy and collection of Special Taxes of Orange Unified School District ("School District") in Community Facilities District ("CFD") No. 2005-2 (Del Rio School Facilities) of Orange Unified School District ("CFD No. 2005-2"). An Annual Special Tax shall be levied on and collected in CFD No. 2005-2 each Fiscal Year in an amount determined through the application of the Rate and Method of Apportionment described below. All of the real property in CFD No. 2005-2, unless exempted by law or by the provisions hereof, shall be taxed for the purposes, to the extent, and in the manner herein provided.

**SECTION A
DEFINITIONS**

The terms hereinafter set forth have the following meanings:

"Acreage" means the number of acres of land area of an Assessor's Parcel as shown on an Assessor's Parcel Map, or if the land area is not shown on an Assessor's Parcel Map, the Board may rely on the land area shown on the applicable Final Subdivision Map, parcel map, condominium plan, or other recorded County parcel map.

"Act" means the Mello-Roos Communities Facilities Act of 1982 as amended, being Chapter 2.5, Division 2 of Title 5 of the Government Code of the State of California.

"Administrative Expenses" means any ordinary and necessary expense incurred by the School District on behalf of CFD No. 2005-2 related to the determination of the amount of the levy of Special Taxes, the collection of Special Taxes including the reasonable expenses of collecting delinquencies, the administration of Bonds, the proportionate payment of salaries and benefits of any School District employee whose duties are directly related to the administration of CFD No. 2005-2, and costs otherwise incurred in order to carry out the authorized purposes of CFD No. 2005-2.

"Annual Special Tax" means the Special Tax actually levied in any Fiscal Year on any Assessor's Parcel.

"Assessor's Parcel" means a lot or parcel of land designated on an Assessor's Parcel Map with an assigned Assessor's Parcel Number within the boundaries of CFD No. 2005-2.

"Assessor's Parcel Map" means an official map of the Assessor of the County designating parcels by Assessor's Parcel Number.

"Assessor's Parcel Number" or **"APN"** means that number assigned to an Assessor's Parcel by the County for purposes of identification.

"Assigned Annual Special Tax" means the Special Tax of that name described in Section D.

"Attached Unit" means a Unit that is located within a building in which each of the individual Units has or shall have at least one common wall with another Unit.

"Backup Annual Special Tax" means the Special Tax of that name described in Section E.

"Board" means the Board of Education of Orange Unified School District or its designee as the legislative body of CFD No. 2005-2.

"Bond Index" means the national Bond Buyer Revenue Bond Index, commonly referenced as the 25-Bond Revenue Index. In the event the Bond Index ceases to be published, the index used shall be based on a comparable index for revenue bonds maturing in 30 years with an average rating equivalent to Moody's A1 and S&P's A-plus, as reasonably determined by the Board.

"Bonds" means any obligation to repay a sum of money, including obligations in the form of bonds, notes, certificates of participation, long-term leases, loans from government agencies, or loans from banks, other financial institutions, private businesses, or individuals, or long-term contracts, or any refunding thereof, which obligation may be incurred by CFD No. 2005-2.

"Building Permit" means a permit for the construction of one or more Units issued by the City for the construction of Units within the City, or another public agency in the event the City no longer issues permits for the construction of Units within CFD No. 2005-2. For purposes of this definition, "Building Permit" shall not include permits for construction or installation of commercial/industrial structures, parking structures, retaining walls, utility improvements, or other such improvements not intended for human habitation.

"Building Square Footage" or **"BSF"** means the square footage of assessable internal living space of a Unit, exclusive of any carports, walkways, garages, overhangs, patios, enclosed patios, detached accessory structure, or other structures not used as living space, as determined by reference to the Building Permit for such Unit.

"Calendar Year" means the period commencing January 1 of any year and ending the following December 31.

"CFD No. 2005-2" means Community Facilities District No. 2005-2 (Del Rio School Facilities) of Orange Unified School District.

"City" means the City of Orange.

"County" means the County of Orange, State of California.

"Detached Unit" means a Unit which is not an Attached Unit.

"Developed Property" means all Assessor's Parcels of Taxable Property for which Building Permits were issued on or before May 1 of the prior Fiscal Year, provided that such Assessor's Parcels were created on or before January 1 of the prior Fiscal Year and that each such Assessor's Parcel is associated with a Lot, as determined reasonably by the Board.

"Exempt Property" means all Assessors' Parcels designated as being exempt from Special Taxes

in Section K.

"Final Subdivision Map" means a final tract map, parcel map, lot line adjustment, or functionally equivalent map or instrument that creates building sites, recorded in the County Office of the Recorder.

"Fiscal Year" means the period commencing on July 1 of any year and ending the following June 30.

"Lot" means an individual legal lot created by a Final Subdivision Map for which a Building Permit for residential construction has been or could be issued. Notwithstanding the foregoing, in the case of an individual legal lot created by such a Final Subdivision Map upon which condominium units are entitled to be developed but for which a condominium plan has not been recorded, the number of Lots allocable to such legal lot for purposes of calculating the Backup Special Tax applicable to such Final Subdivision Map shall equal the number of condominium units which are permitted to be constructed on such legal lot as shown on such Final Subdivision Map.

"Maximum Annual Special Tax" means the maximum Special Tax, determined in accordance with Section C that can be levied by CFD No. 2005-2 in any Fiscal Year on any Assessor's Parcel of Taxable Property.

"Minimum Annual Special Tax Requirement" means the amount required in any Fiscal Year to pay: (i) the debt service or the periodic costs on all outstanding Bonds, (ii) Administrative Expenses of CFD No. 2005-2, (iii) the costs associated with the release of funds from an escrow account, and (iv) any amount required to establish or replenish any reserve funds established in association with the Bonds, less (v) any amount available to pay debt service or other periodic costs on the Bonds pursuant to any applicable bond indenture, fiscal agent agreement, or trust agreement.

"Partial Prepayment Amount" means the amount required to prepay a portion of the Annual Special Tax obligation for an Assessor's Parcel, as described in Section I.

"Prepayment Administrative Fees" means the fees and expenses associated with the prepayment, including the costs of computation of the Prepayment Amount, costs of redeeming Bonds, and costs of recording any notices to evidence the prepayment and redemption of Bonds.

"Prepayment Amount" means the amount required to prepay the Annual Special Tax obligation in full for an Assessor's Parcel, as described in Section H.

"Present Value of Taxes" means the present value of any Special Tax applicable to such Assessor's Parcel in the current Fiscal Year not yet received by the School District for CFD No. 2005-2, plus the expected Annual Special Tax applicable to such Assessor's Parcel in each remaining Fiscal Year until the termination date specified in Section J, using as the discount rate the lesser of (i) the Yield On The Bonds after Bond issuance or (ii) the most recently published Bond Index prior to Bond issuance.

"Proportionately" means that the ratio of the actual Annual Special Tax levy to the applicable Assigned Annual Special Tax is equal for all applicable Assessors' Parcels.

"Reserve Fund Credit" (if any) means, for each owner of an Assessor's Parcel wishing to prepay

the Annual Special Tax obligation of such Assessor's Parcel, an amount equal to the reduction in the reserve requirement for the outstanding Bonds resulting from the redemption of Bonds with the applicable prepaid Special Taxes. In the event that a surety bond of other credit instrument satisfies the reserve requirement or the reserve requirement is under-funded at the time of the prepayment, no Reserve Fund Credit shall be given.

"School District" means Orange Unified School District

"Special Tax" means any of the special taxes authorized to be levied by CFD No. 2005-2 pursuant to the Act and this Rate and Method of Apportionment.

"Taxable Property" means all Assessors' Parcels which are not Exempt Property.

"Undeveloped Property" means all Assessors' Parcels of Taxable Property which are not Developed Property.

"Unit" means each separate residential dwelling unit which comprises an independent facility capable of conveyance separate from adjacent residential dwelling units.

"Yield On The Bonds" means the arbitrage yield for the last series of Bonds issued.

SECTION B CLASSIFICATION OF ASSESSOR'S PARCELS

For each Fiscal Year, beginning with Fiscal Year 2006-07, each Assessor's Parcel within CFD No. 2005-2 shall be classified as Taxable Property or Exempt Property. Furthermore, each Assessor's Parcel of Taxable Property shall be classified as Developed Property or Undeveloped Property. For each Assessor's Parcel of Developed Property, it shall be assigned to a Special Tax class based on the Building Square Footage of the Unit as listed on the Building Permit(s) issued for each Assessor's Parcel.

SECTION C MAXIMUM SPECIAL TAXES

1. Developed Property

The Maximum Special Tax for each Assessor's Parcel classified as Developed Property for any Fiscal Year shall be the amount determined by the greater of (i) the application of the Assigned Annual Special Tax or (ii) the application of the Backup Annual Special Tax.

2. Undeveloped Property

The Maximum Special Tax for each Assessor's Parcel classified as Undeveloped Property for any Fiscal Year shall be the amount determined by the application of the Assigned Annual Special Tax.

SECTION D
ASSIGNED ANNUAL SPECIAL TAXES

1. Developed Property

The Assigned Annual Special Tax in Fiscal Year 2005-06 for each Assessor's Parcel of Developed Property shall be the amount determined by reference to Table 1.

TABLE 1

**ASSIGNED ANNUAL SPECIAL TAX FOR
DEVELOPED PROPERTY
FOR FISCAL YEAR 2005-06**

Unit Type	Building Square Footage	Assigned Annual Special Tax
Attached Unit	< 1,500 BSF	\$411.40 per Unit
Attached Unit	1,500 – 1,699 BSF	\$593.48 per Unit
Attached Unit	>= 1,700 BSF	\$688.68 per Unit
Detached Unit	< 1,300 BSF	\$414.72 per Unit
Detached Unit	1,300 – 1,499 BSF	\$527.62 per Unit
Detached Unit	1,500 – 1,699 BSF	\$621.18 per Unit
Detached Unit	1,700 – 1,899 BSF	\$706.30 per Unit
Detached Unit	1,900 – 2,099 BSF	\$797.24 per Unit
Detached Unit	2,100 – 2,299 BSF	\$920.28 per Unit
Detached Unit	>= 2,300 BSF	\$999.22 per Unit

For each Fiscal Year, commencing with Fiscal Year 2006-07, the Assigned Annual Special Tax for all Developed Property shall be increased by two percent (2.00%) of the amount in effect in the prior Fiscal Year.

2. Undeveloped Property

The Assigned Annual Special Tax rate in Fiscal Year 2005-06 for an Assessor's Parcel classified as Undeveloped Property shall be \$12,627.22 per acre of Acreage.

For each Fiscal Year, commencing with Fiscal Year 2006-07, the Assigned Annual Special Tax for all Undeveloped Property shall be increased by two percent (2.00%) of the amount in effect in the prior Fiscal Year.

SECTION E BACKUP ANNUAL SPECIAL TAXES

Each Fiscal Year, each Assessor's Parcel of Developed Property shall be subject to a Backup Annual Special Tax. The Backup Annual Special Tax rate for Developed Property within a Final Subdivision Map shall be the rate per Lot calculated according to the following formula in Fiscal Year 2006-07 or such later Fiscal Year in which such Final Subdivision Map is created:

$$B = \frac{U \times A}{L}$$

The terms above have the following meanings:

B	=	Backup Annual Special Tax per Lot in each Fiscal Year
U	=	Assigned Annual Special Tax per acre of Acreage for Undeveloped Property in the Fiscal Year the calculation is performed
A	=	Acreage of Taxable Property in such Final Subdivision Map after subtracting the Exempt Property as determined by the Board in Section K
L	=	Lots in the Final Subdivision Map

Each July 1, commencing the July 1 first following the initial calculation of the Backup Annual Special Tax rate for an Assessor's Parcel of Developed Property, the Backup Annual Special Tax shall be increased by two percent (2.00%) of the amount in effect the prior Fiscal Year.

Notwithstanding the foregoing, if all or any portion of the Final Subdivision Map(s) described in the preceding paragraph is subsequently changed or modified, then the Backup Annual Special Tax for each Assessor's Parcel of Developed Property in such Final Subdivision Map area that is changed or modified shall be a rate per square foot of Acreage calculated as follows:

1. Determine the total Backup Annual Special Taxes anticipated to apply to the changed or modified Final Subdivision Map area prior to the change or modification.
2. The result of paragraph 1 above shall be divided by the Acreage of Taxable Property which is ultimately expected to exist in such changed or modified Final Subdivision Map area, as reasonably determined by the Board.
3. The result of paragraph 2 above shall be divided by 43,560. The result is the Backup Annual Special Tax per square foot of Acreage which shall be applicable to Assessor's Parcels of Developed Property in such changed or modified Final Subdivision Map area for all remaining Fiscal Years in which the Special Tax may be levied. Each July 1, commencing the July 1 first following the initial calculation of the revised Backup Annual Special Tax rate for an Assessor's Parcel of Developed Property, the Backup Annual Special Tax shall be increased by two percent (2.00%) of the amount in effect the prior Fiscal Year. The Backup Annual Special Tax for an Assessor's

Parcel of Developed Property in a Final Subdivision Map that is not changed or modified shall not be recalculated.

SECTION F
EXCESS ASSIGNED ANNUAL SPECIAL TAX FROM
DEVELOPED PROPERTY

In any Fiscal Year, when proceeds of Assigned Annual Special Tax for Developed Property are greater than the Minimum Annual Special Tax Requirement, then such amount shall be paid to the School District. The proceeds shall be used for acquisition, construction or financing school facilities in accordance with the Act and other applicable law as determined by the School District.

SECTION G
METHOD OF APPORTIONMENT OF THE ANNUAL SPECIAL TAX

Commencing Fiscal Year 2006-07 and for each subsequent Fiscal Year, the Board shall levy Annual Special Taxes as follows:

- Step One: The Board shall levy an Annual Special Tax on each Assessor's Parcel of Developed Property in an amount equal to the Assigned Annual Special Tax applicable to each such Assessor's Parcel.
- Step Two: If the sum of the amounts levied in step one is insufficient to satisfy the Minimum Annual Special Tax Requirement, then the Board shall Proportionately levy an Annual Special Tax on each Assessor's Parcel of Undeveloped Property, up to the Maximum Special Tax applicable to each such Assessor's Parcel, to satisfy the Minimum Annual Special Tax Requirement.
- Step Three: If the sum of the amounts levied in steps one and two is insufficient to satisfy the Minimum Annual Special Tax Requirement, then the Board shall Proportionately levy an Annual Special Tax on each Assessor's Parcel of Developed Property whose Maximum Special Tax is derived by application of the Backup Annual Special Tax, up to the Maximum Special Tax applicable to each such Assessor's Parcel, to satisfy the Minimum Annual Special Tax Requirement.

SECTION H
PREPAYMENT OF ANNUAL SPECIAL TAXES

The Annual Special Tax obligation of an Assessor's Parcel of Developed Property or an Assessor's Parcel of Undeveloped Property for which a Building Permit has been issued may be prepaid. An owner of an Assessor's Parcel intending to prepay the Annual Special Tax obligation shall provide CFD No. 2005-2 with written notice of intent to prepay. Within thirty (30) days of receipt of such written notice, the Board shall reasonably determine the Prepayment Amount of such Assessor's Parcel and shall notify such owner of such Prepayment Amount. In addition, any property owner prepaying his or her Annual Special Tax obligation must also pay all delinquent Special Taxes, interest and penalties owing on the Assessor's Parcel on which payment is being made, if any. The Prepayment Amount shall be calculated according to the following formula:

$$P = PVT - RFC + PAF$$

The terms above have the following meanings:

P	=	Prepayment Amount
PVT	=	Present Value of Taxes
RFC	=	Reserve Fund Credit
PAF	=	Prepayment Administrative Fees

Notwithstanding the foregoing, no prepayment will be allowed unless the amount of Annual Special Taxes that may be levied on Taxable Property, net of Administrative Expenses, shall be at least 1.1 times the regularly scheduled annual interest and principal payments on all currently outstanding Bonds in each future Fiscal Year and such prepayment will not impair the security of all currently outstanding Bonds, as reasonably determined by the Board. Such determination shall include identifying all Assessors' Parcels that are expected to become Exempt Property.

SECTION I PARTIAL PREPAYMENT OF ANNUAL SPECIAL TAXES

The Annual Special Tax obligation of an Assessor's Parcel may be partially prepaid at the times and under the conditions set forth in this section, provided that there are no delinquent Special Taxes, penalties, or interest charges outstanding with respect to such Assessor's Parcel at the time the Annual Special Tax obligation would be prepaid.

1. Partial Prepayment Times and Conditions

Prior to the issuance of the first Building Permit for the construction of a production Unit on a Lot within a Final Subdivision Map area, the owner of no less than all the Taxable Property within such Final Subdivision Map area may elect in writing to the Board to prepay a portion of the Annual Special Tax obligations for all the Assessor's Parcels within such Final Subdivision Map area, as calculated in Section I.2. below. The partial prepayment of each Annual Special Tax obligation shall be collected prior to the issuance of the first Building Permit with respect to each Assessor's Parcel.

2. Partial Prepayment Amount

The Partial Prepayment Amount shall be calculated according to the following formula:

$$PP = P_H \times F$$

The terms above have the following meanings:

PP	=	the Partial Prepayment Amount
P _H	=	the Prepayment Amount calculated according to Section H
F	=	the percent by which the owner of the Assessor's Parcel is partially prepaying the Annual Special Tax obligation

3. Partial Prepayment Procedures and Limitations

With respect to any Assessor's Parcel that is partially prepaid, the Board shall indicate in the

records of CFD No. 2005-2 that there has been a partial prepayment of the Annual Special Tax obligation and shall cause a suitable notice to be recorded in compliance with the Act to indicate the partial prepayment of the Annual Special Tax obligation and the partial release of the Annual Special Tax lien on such Assessor's Parcel, and the obligation of such Assessor's Parcel to pay such prepaid portion of the Annual Special Tax shall cease. Additionally, the notice shall indicate that the Assigned Annual Special Tax and the Backup Annual Special Tax for the Assessor's Parcels have been reduced by an amount equal to the percentage which was partially prepaid.

Notwithstanding the foregoing, no partial prepayment will be allowed unless the amount of Annual Special Taxes that may be levied on Taxable Property after such partial prepayment, net of Administrative Expenses, shall be at least 1.1 times the regularly scheduled annual interest and principal payments on all currently outstanding Bonds in each future Fiscal Year.

SECTION J TERMINATION OF SPECIAL TAX

Annual Special Taxes shall be levied for a period of thirty-three (33) Fiscal Years after Bonds have been issued, provided that Annual Special Taxes shall not be levied after Fiscal Year 2050-51.

SECTION K EXEMPTIONS

The Board shall classify as Exempt Property (i) Assessor's Parcels owned by the State of California, Federal or other local governments, (ii) Assessor's Parcels which are used as places of worship and are exempt from *ad valorem* property taxes because they are owned by a religious organization, (iii) Assessor's Parcels used exclusively by a homeowners' association, (iv) Assessor's Parcels with public or utility easements making impractical their utilization for other than the purposes set forth in the easement, (v) Assessor's Parcels developed or expected to be developed exclusively for non-residential use, including any use directly servicing any non-residential property, such as parking, as reasonably determined by the Board, and (vi) any other Assessor's Parcels at the reasonable discretion of the Board, provided that no such classification would reduce the sum of all Taxable Property to less than 36.41 acres of Acreage. Notwithstanding the above, the Board shall not classify an Assessor's Parcel as Exempt Property if such classification would reduce the sum of all Taxable Property to less than 36.41 acres of Acreage. Assessor's Parcels which cannot be classified as Exempt Property because such classification would reduce the Acreage of all Taxable Property to less than 36.41 acres of Acreage will continue to be classified as Developed Property or Undeveloped Property, as applicable, and will continue to be subject to Special Taxes accordingly.

SECTION L CLAIMS

Any property owner claiming that the amount or application of the Special Tax is not correct may file a written notice of appeal with the Board not later than twelve months after having paid the first installment of the Special Tax that is disputed. In order to be considered sufficient, any claim of appeal must: (i) specifically identify the property by address and Assessor's Parcel Number; (ii) state the amount in dispute and whether it is the whole amount or only a portion of the Special Tax; (iii) state all grounds on which the property owner is disputing the amount or application of the

Special Tax, including a reasonably detailed explanation as to why the amount or application of such Special Tax is incorrect; (iv) include all documentation, if any, in support of the claim; and (v) be verified under penalty of perjury by the person who paid the Special Tax or his or her guardian, executor or administrator. A representative(s) of CFD No. 2005-2 ("Representative") shall promptly review the claim, and if necessary, meet with the property owner, consider written and oral evidence regarding the amount of the Special Tax, and rule on the claim. The decisions of the Representative(s) shall be final and binding. If the Representative's decision requires that the Special Tax for an Assessor's Parcel be modified or changed in favor of the property owner, a cash refund shall not be made (except for the last year of levy), but an adjustment shall be made to the Annual Special Tax on that Assessor's Parcel in the subsequent Fiscal Year(s) as the Representative's decisions shall indicate.

SECTION M MANNER OF COLLECTION

The Annual Special Tax shall be collected in the same manner and at the same time as ordinary *ad valorem* property taxes, provided, however, that CFD No. 2005-2 may collect Annual Special Taxes at a different time or in a different manner if necessary to meet its financial obligations, including the ability to direct bill the properties in CFD No. 2005-2.

J:\CLIENTS\ORANGE.USD\Mello\Del Rio\RMA_FINAL.doc

RESOLUTION NO. 31-05-06

A RESOLUTION OF THE BOARD OF EDUCATION OF THE ORANGE UNIFIED SCHOOL DISTRICT DECLARING ITS INTENTION TO INCUR BONDED INDEBTEDNESS OF THE PROPOSED COMMUNITY FACILITIES DISTRICT NO. 2005-2 (DEL RIO SCHOOL FACILITIES) OF THE ORANGE UNIFIED SCHOOL DISTRICT

WHEREAS, this Board of Education has this date adopted its Resolution entitled "A RESOLUTION OF THE ORANGE UNIFIED SCHOOL DISTRICT DECLARING ITS INTENTION (i) TO ESTABLISH COMMUNITY FACILITIES DISTRICT NO. 2005-2 (DEL RIO SCHOOL FACILITIES) OF THE ORANGE UNIFIED SCHOOL DISTRICT, (ii) TO LEVY A SPECIAL TAX TO PAY FOR CERTAIN PUBLIC FACILITIES AND (iii) TO ISSUE BONDS SECURED BY A SPECIAL TAX TO FINANCE CERTAIN FACILITIES" stating its intention to form a community facilities district pursuant to the Mello-Roos Community Facilities Act of 1982 (the "Law"), for the purpose of financing a portion of the costs of certain public improvements (the "Facilities"), as further provided in said Resolution; and

WHEREAS, this Board of Education estimates the amount required for the financing of the portion of costs of the Facilities to be funded by the District (as defined below) to be not in excess of \$9,000,000; and

WHEREAS, in order to finance said portion of the costs of the Facilities it is necessary to incur bonded indebtedness for the District in the amount of not to exceed \$9,000,000.

NOW, THEREFORE, BE IT RESOLVED by the Board of Education of the Orange Unified School District as follows:

Section 1. It is necessary to incur bonded indebtedness within the boundaries of the proposed Community Facilities District No. 2005-2 (Del Rio School Facilities) of the Orange Unified School District (the "District") in the amount of not to exceed \$9,000,000 to finance a portion of the costs of the Facilities.

Section 2. The bonded indebtedness described in Section 1 is proposed to be incurred for the purpose of financing a portion of the costs of the Facilities, including costs incidental to or connected with the accomplishment of said purposes and of the financing thereof.

Section 3. This Board of Education, acting as legislative body for the District, intends to authorize the issuance and sale of one or more series of the bonds in the maximum aggregate principal amount of \$9,000,000, bearing interest payable semi-annually or in such other manner as this Board of Education shall determine, at a rate not to exceed the maximum rate of interest as may be authorized by applicable law at the time of sale of such bonds, and maturing not to exceed thirty-three (33) years from the date of the issuance of said bonds.

Section 4. Thursday, February 9, 2006, at 7:30 p.m. or as soon thereafter as the matter may be heard, in the regular meeting place of this Board of Education, Orange Unified School District, 1401 North Handy Street, Orange, California, be, and the same are hereby appointed and fixed as the time and place when and where this Board of Education, as legislative body for the District, will conduct a public hearing on the proposed debt issue for the District and consider and finally determine whether the public interest, convenience and necessity require the issuance of bonds of the District.

Section 5. The Clerk is hereby directed to cause notice of said public hearing to be given by publication one time in a newspaper of general circulation circulated within the District. The publication of said notice shall be completed at least seven (7) days before the date herein set for said public hearing. The notice shall be substantially in the form of Exhibit A hereto.

Section 6. This Resolution shall take effect upon its adoption.

PASSED, APPROVED AND ADOPTED, by the Board of Education of the Orange Unified School District at a meeting held on the 5th day of January, 2006.

Kimberlee Nichols, President of the Board of
Education of the Orange Unified School District

ATTEST:

Wes Poutsma, Clerk of the Board of Education of
the Orange Unified School District

CLERK'S CERTIFICATE

I, Wes Poutsma, Clerk of the Board of Education of the Orange Unified School District, Orange County, California, hereby certify that the foregoing Resolution is a full, true and correct copy of a resolution duly adopted at a regular meeting of the Board of said School District duly and regularly held on the 5th day of January, 2006, of which meeting all of the members of said Board had due notice and at which a majority thereof were present; and that at said meeting said resolution was adopted by the following vote:

AYES:

NOES:

ABSENT:

ABSTAIN:

An agenda of said meeting was posted at least 72 hours before said meeting at 1401 North Handy Street, Orange, California, locations freely accessible to members of the public, and a brief general description of said resolution appeared on said agenda.

I further certify that I have carefully compared the same with the original minutes of said meeting on file and of record in my office; that the foregoing resolution is a full, true and correct copy of the original resolution adopted at said meeting and entered in said minutes; and that said resolution has not been amended, modified or rescinded since the date of its adoption, and the same is now in full force and effect.

Dated: January 5, 2006

Wes Poutsma, Clerk of the Board of Education of
the Orange Unified School District

EXHIBIT A

COMMUNITY FACILITIES DISTRICT NO. 2005-2 (DEL RIO SCHOOL FACILITIES) OF THE ORANGE UNIFIED SCHOOL DISTRICT

NOTICE OF PUBLIC HEARING

Notice is hereby given that on January 5, 2006, the Board of Education of the Orange Unified School District adopted a Resolution entitled "A Resolution of the Board of Education of the Orange Unified School District Declaring Its Intention To Incur Bonded Indebtedness of the Proposed Community Facilities District No. 2005-2 (Del Rio School Facilities) of the Orange Unified School District" pursuant to the Mello-Roos Community Facilities Act of 1982, the Board of Education hereby gives notice as follows:

A. The text of said Resolution is as follows:

RESOLUTION NO. 31-05-06

A RESOLUTION OF THE BOARD OF EDUCATION OF THE ORANGE UNIFIED SCHOOL DISTRICT DECLARING ITS INTENTION TO INCUR BONDED INDEBTEDNESS OF THE PROPOSED COMMUNITY FACILITIES DISTRICT NO. 2005-2 (DEL RIO SCHOOL FACILITIES) OF THE ORANGE UNIFIED SCHOOL DISTRICT

WHEREAS, this Board of Education has this date adopted its Resolution entitled "A RESOLUTION OF THE ORANGE UNIFIED SCHOOL DISTRICT DECLARING ITS INTENTION (i) TO ESTABLISH COMMUNITY FACILITIES DISTRICT NO. 2005-2 (DEL RIO SCHOOL FACILITIES) OF THE ORANGE UNIFIED SCHOOL DISTRICT, (ii) TO LEVY A SPECIAL TAX TO PAY FOR CERTAIN PUBLIC FACILITIES AND (iii) TO ISSUE BONDS SECURED BY A SPECIAL TAX TO FINANCE CERTAIN FACILITIES" stating its intention to form a community facilities district pursuant to the Mello-Roos Community Facilities Act of 1982 (the "Law"), for the purpose of financing a portion of the costs of certain public improvements (the "Facilities"), as further provided in said Resolution; and

WHEREAS, this Board of Education estimates the amount required for the financing of the portion of costs of the Facilities to be funded by the District (as defined below) to be not in excess of \$9,000,000; and

WHEREAS, in order to finance said portion of the costs of the Facilities it is necessary to incur bonded indebtedness for the District in the amount of not to exceed \$9,000,000.

NOW, THEREFORE, BE IT RESOLVED by the Board of Education of the Orange Unified School District as follows:

Section 1. It is necessary to incur bonded indebtedness within the boundaries of the proposed Community Facilities District No. 2005-2 (Del Rio School Facilities) of the Orange Unified School District (the "District") in the amount of not to exceed \$9,000,000 to finance a portion of the costs of the Facilities.

Section 2. The bonded indebtedness described in Section 1 is proposed to be incurred for the purpose of financing a portion of the costs of the Facilities, including costs incidental to or connected with the accomplishment of said purposes and of the financing thereof.

Section 3. This Board of Education, acting as legislative body for the District, intends to authorize the issuance and sale of one or more series of the bonds in the maximum aggregate principal amount of \$9,000,000, bearing interest payable semi-annually or in such other manner as this Board of Education shall determine, at a rate not to exceed the maximum rate of interest as may be authorized by applicable law at the time of sale of such bonds, and maturing not to exceed thirty-three (33) years from the date of the issuance of said bonds.

Section 4. Thursday, February 9, 2006, at 7:30 p.m. or as soon thereafter as the matter may be heard, in the regular meeting place of this Board of Education, Orange Unified School District, 1401 North Handy Street, Orange, California, be, and the same are hereby appointed and fixed as the time and place when and where this Board of Education, as legislative body for the District, will conduct a public hearing on the proposed debt issue for the District and consider and finally determine whether the public interest, convenience and necessity require the issuance of bonds of the District.

Section 5. The Clerk is hereby directed to cause notice of said public hearing to be given by publication one time in a newspaper of general circulation circulated within the District. The publication of said notice shall be completed at least seven (7) days before the date herein set for said public hearing. The notice shall be substantially in the form of Exhibit A hereto.

Section 6. This Resolution shall take effect upon its adoption.

PASSED, APPROVED AND ADOPTED, by the Board of Education of the Orange Unified School District at a meeting held on the 5th day of January, 2006.

Kimberlee Nichols, President of the Board of
Education of the Orange Unified School District

ATTEST:

Wes Poutsma, Clerk of the Board of Education
of the Orange Unified School District

B. The hearing referred to in the aforesaid Resolution shall be at the time and place specified in the Resolution.

C. At that time and place any person interested, including persons owning property in the proposed community facilities district, will be heard upon the proposed debt issues.

Dated: January 5, 2006

Wes Poutsma, Clerk of the Board of Education of
the Orange Unified School District

TOPIC:	SCHOOL BOARD POLICY PROPOSED REVISION - THE 2000 SERIES, ADMINISTRATION – FIRST READING
DESCRIPTION:	<p>On June 8, 2004, the Board discussed the need for updating the current policy manual and various means of addressing this task. At the July 15, 2004 meeting, the Board approved the law firm, Parker & Covert, to work throughout the 2004-05 school year in conjunction with appropriate staff members to revise or redraft policies, with Parker & Covert providing recommended revisions or redrafting of the policies in question.</p> <p>Parker & Covert has submitted its recommendations in conjunction with appropriate staff members' input for Board consideration. (The new language is shown in italics.)</p>
FISCAL IMPACT:	There is no fiscal impact to change the wording of the Board Policies.
RECOMMENDATION:	It is recommended that the Board of Education accept the proposed Board Policy revisions for the 2000 series for a first reading.

AdministrationAdministrative Staff Organization

The Superintendent shall organize the administrative staff in a manner which best enables the District to provide an effective program of instruction. (cf. 2230 - Representative and Deliberative Groups)

Authority originates with the publicly elected Board of Education. Through the Superintendent, authority and responsibility are delegated to the administration and staff.

The Superintendent or designee may adjust staff responsibilities temporarily or permanently to accommodate the workload and/or individual capabilities.

Legal Reference:

EDUCATION CODE

35020	<i>Duties of employees fixed by governing board</i>
35028	<i>Qualifications for employment</i>
35031	<i>Term of employment</i>
35160	<i>Authority of governing boards</i>
35160.1	<i>Broad authority of school Districts</i>
35161	<i>Powers and duties generally</i>

Approved: (7-88) 11-92

ORANGE UNIFIED SCHOOL DISTRICT
Orange, California

AdministrationOrganizational Chart/Lines of Responsibility

The Superintendent shall maintain a current District organization chart. The organization chart shall clearly designate lines of primary responsibility and the relationships between all District positions.

The organization chart should clarify working relationships and functions. It is not intended to indicate all the lines of communication and cooperation which must exist to create successful and effective schools.

The Superintendent or designee shall insure that all personnel understand to whom they are responsible and for what functions. Lines of responsibility should in no way prevent staff members at all levels from cooperating to develop the best possible school programs and services. (cf. 2120 - Superintendent of Schools) (cf. 2210 - Administrative Leeway in Absence of Board Policy) (cf. 4119.3 - Duties of Personnel) (cf. 4144 - Grievances/Complaints)

The Superintendent may delegate any of his/her responsibilities and duties to other District staff but remains accountable to the Board for all areas of operation under the Superintendent's authority.

Legal Reference:

EDUCATION CODE

35010	Control of District; prescription and enforcement of rules
35020	Duties of employees fixed by governing board
35035	Powers and duties of superintendent
35160	Authority of governing boards
35160.1	Board authority of school Districts

ORANGE UNIFIED SCHOOL DISTRICT
Orange, California

Adopted: (7-88) 11-92

Administration

Superintendent Governance Standards

The Board of Education recognizes that effective District governance requires strong collaboration and teamwork with the Superintendent. Because the Board and Superintendent each have their unique roles and responsibilities, both contribute to the responsible governance of the District and the quality of education provided to the community's students.

The Superintendent is expected to hold himself/herself to the highest standards of ethical conduct and professionalism.

To support the Board in the governance of the District, the Superintendent:

- 1. Promotes the success of all students and supports the efforts of the Board to keep the District focused on learning and achievement*
- 2. Values, advocates and supports public education and all stakeholders*
- 3. Recognizes and respects the differences of perspective and style on the Board and among staff, students, parents/guardians and the community - and ensures that the diverse range of views inform Board decisions*
- 4. Acts with dignity, treats everyone with civility and respect, and understands the implications of demeanor and behavior*
- 5. Serves as a model for the value of lifelong learning and supports the Board's continuous professional development*
- 6. Works with the Board as a "governance team" and assures collective responsibility for building a unity of purpose, communicating a common vision and creating a positive organizational culture*
- 7. Recognizes that the Board/Superintendent governance relationship is supported by the management team in the District*
- 8. Understands the distinction between Board and staff roles, and respects the role of the Board as the representative of the community*
- 9. Understands that authority rests with the Board as a whole; provides guidance to the Board to assist in decision-making; and provides leadership based on the direction of the Board as a whole*

BP 2111(b)

10. *Communicates openly with trust and integrity, including providing all members of the Board with equal access to information and recognizing the importance of both responsive and anticipatory communications*
11. *Accepts leadership responsibility and accountability for implementing the vision, goals and policies of the District*

Legal Reference:

EDUCATION CODE

35020 Duties of employees set by governing board

Adopted:

ORANGE UNIFIED SCHOOL DISTRICT
Orange, California

Administration

Superintendent of Schools

The Superintendent is the chief executive officer and educational leader of the school district. He/she executes all Board of Education decisions and is accountable to the Board for managing the schools in accordance with the Board's policies. He/she informs the Board about school programs, practices and problems and offers professional advice on items requiring Board action, with appropriate recommendations based on thorough study and analysis.

The Board of Education delegates to the Superintendent the power to make decisions concerning internal operations of the district. The Superintendent may delegate to other school staff any duties imposed upon him/her by the policies or vote of the Board, as far as the law permits. This delegation of power or duty shall not relieve the Superintendent of the responsibility for actions taken by his/her designees.

The Superintendent shall have general supervision of all personnel and shall develop and execute consistent, fair and fiscally sound personnel procedures and practices, including hiring, retention and an evaluation program for all district employees. He/she shall oversee all financial operations of the district and actively seek out new funding sources for the schools.

The Superintendent shall take an active leadership role in the development and improvement of the instructional program. He/she is expected to create a feeling of unity and enthusiasm among students and staff for the accomplishment of district goals, by having a visible presence in schools and offices.

The Superintendent shall articulate educational issues and values before the community and other governmental agencies. He/she shall be visible and accessible to community members and shall work with them to further the district's goals and build a strong, positive community attitude toward the school system.

The Board expects the Superintendent to remain current on educational thought and practices by reading educational publications, attending educational conferences and visiting other school systems in the interest of improving the district's instructional program and overall operation. The Superintendent shall inform the Board and staff of new developments and significant events in the field of education.

(Legal Reference next page)

Legal Reference:

EDUCATION CODE

35020	Duties of employees set by governing board
35026	Employment of district superintendent by certain districts
35028	Qualifications for employment
35029	Waiver of certification requirement for chief administrative office of the district
35031	Term of employment (up to four years)
35032	Salary increases
30035	Additional powers and duties of superintendent

Adopted: (7-88, 11-92) 10-02

ORANGE UNIFIED SCHOOL DISTRICT
Orange, California

Administration

Superintendent's Contract

The Board of Education shall employ a Superintendent for a term not to exceed four years. (E.C. 35031)

Non-renewal of Contract

The Board shall notify the Superintendent no less than forty-five (45) days before his/her current contract expires, *and as otherwise provided for in the Superintendent's employment contract*, of its intention not to renew the contract. If the above notice has not been given, the Superintendent shall be reelected for a term of the same length as the one completed, under the same terms and with the same compensation. (E.C. 35031)

The Board shall evaluate the Superintendent's performance early enough to ensure compliance with this notice requirement and any requirements of the existing contract.

Legal Reference:

EDUCATION CODE

35031 Term of employment

Adopted: 11-92

ORANGE UNIFIED SCHOOL DISTRICT
Orange, California

AdministrationEvaluation of The Superintendent

The Board of Education shall annually conduct a formal evaluation of the Superintendent's performance in order to assess his/her effectiveness in leading the district toward established goals. The Board and Superintendent shall establish an appropriate schedule for the annual evaluation process.

Evaluation criteria shall be based on district goals and success indicators agreed upon by the Board and Superintendent prior to the evaluation. The evaluation shall provide commendations in areas of strength, provide recommendations for improving effectiveness, and serve as a basis for making decisions about salary increases and/or contract extension.

The Board and Superintendent shall annually consider what evaluation method(s) will best serve the district and agree on the specific written instrument to be used.

Prior to the evaluation, the Superintendent shall be responsible for preparing and distributing to the Board for its review a report of progress toward district goals, the Superintendent's self-appraisal of accomplishments and performance, and a review of action taken to address any Board recommendations from the previous evaluation. The Board shall also review the Superintendent's current contract and any relevant Board policies.

Each Board member shall independently evaluate the Superintendent's performance. The Board shall determine who will summarize and combine the individual evaluations to create a consensus document and how that consensus document will be formatted. The evaluation shall be a composite of individual Board members' opinions, but there shall be only one final evaluation representing the Board's collective judgment. This final evaluation shall be provided to the Superintendent for his/her response.

The Board shall meet in closed session with the Superintendent to discuss the evaluation. (Government Code 54957)

The Superintendent shall have an opportunity to ask questions, respond verbally and in writing to the evaluation, and present additional evidence of his/her performance or district progress.

The Board president and Superintendent shall sign the evaluation as evidence that the evaluation has been discussed. The Superintendent shall place the evaluation in his/her personnel file.

After each evaluation has been completed, the Board shall meet in open session to give the Board and Superintendent an opportunity to jointly identify performance goals for the next year.

Legal Reference:

GOVERNMENT CODE

54957 Closed session, personnel matters

ORANGE UNIFIED SCHOOL DISTRICT
Orange, California

Adopted:

Administration

Administrative Staff Organization

The Superintendent shall organize the administrative staff in a manner that best supports the educational program through efficient operations, effective communications and direct assistance to schools.

The Superintendent shall maintain a current District organization chart which designates lines of primary responsibility and the relationships between all District positions. Lines of responsibility shall in no way prevent staff members at all levels from collaborating, communicating and cooperating to develop the best possible programs and provide efficient services.

The Superintendent or designee may adjust staff responsibilities temporarily or permanently as needed to accommodate the workload and/or individual capabilities.

Legal Reference:

EDUCATION CODE

35010 Control of District; prescription and enforcement of rules

35020 Duties of employees fixed by governing board

35035 Powers and duties of superintendent

Adopted:

ORANGE UNIFIED SCHOOL DISTRICT
Orange, California

Administration

Representative and Deliberative Groups

The Board of Education believes that broad input on District operations and policy from staff, parents/guardians, students and members of the public can provide the District with a diversity of viewpoints and expertise, help build a sense of ownership of the schools, enhance District efficiency and assist District communications. As desired, the Superintendent or designee may establish a management team, administrative councils, task forces, cabinets or committees in accordance with law.

The membership, composition and responsibilities of these groups shall be defined by the Superintendent or designee. The Superintendent or designee may establish, change or dissolve these groups at his/her discretion.

Groups established by the Superintendent or designee shall act in an advisory capacity unless specifically authorized to act on behalf of the Superintendent or designee. Advisory groups shall submit their recommendations to the Superintendent or designee, who may report the recommendations to the Board as appropriate.

Expenses incurred for consulting services, materials, travel or other related operations shall be approved by the Superintendent or designee in advance.

Legal Reference:

EDUCATION CODE

35160.1 *Broad authority of school districts*

45100.5 *Senior classified management positions*

45256.5 *Designation of certain senior classified management positions*

GOVERNMENT CODE

3540.1 *Definitions*

54952 *Legislative body, definition*

ORANGE UNIFIED SCHOOL DISTRICT
Orange, California

Adopted:

AdministrationConflict of Interest Code: Designated Personnel

Certain positions may require an employee's participation in decisions affecting individual financial interests. These positions are designated below. Employees holding *positions designated in the District's Conflict of Interest Code and members of the Board of Education* shall report their financial interests as specified in the District's Conflict of Interest Code. (BB 9270 - Conflict of Interest Code)

Legal Reference:

GOVERNMENT CODE

1090-1097 Prohibitions applicable to specified officers
 1125-1128 Incompatible activities
 82028 Definitions "Gift"
 82030 Definitions "Income"
 82033 Definitions "Interest in real property"
 82034 Definitions "Investment"
 87100-87500 Conflicts of interest
 87200-87210 Disclosure
 87300-87313 Conflict of interest codes
 91000-91015 Enforcement

Adopted: (7-88) 11-92

ORANGE UNIFIED SCHOOL DISTRICT
 Orange, California

INFORMATION/DISCUSSION ITEMS

TOPIC:	REPORT ON AVID (ADVANCEMENT VIA INDIVIDUAL DETERMINATION)
DESCRIPTION	Granger Ward, AVID California State Director, Sally Arellanes, OCDE AVID Coordinator and OUSD AVID students will present an overview of the AVID program. AVID is an in-school academic support program for grades 5-12 that prepares students for college eligibility and success. AVID is currently in place at Orange, Canyon, Villa Park and El Modena High Schools as well as Cerro Villa, Yorba, Portola and Santiago Charter Middle Schools. We are especially proud that Orange High School has been named as an AVID National Demonstration Site.
FISCAL IMPACT:	This item has no fiscal impact to the school district.
RECOMMENDATION:	It is recommended that the Board of Education receive this report as presented

TOPIC: BOARD OF EDUCATION SELF-EVALUATION

DESCRIPTION: In accordance with Board Bylaw 9400, the Board of Education shall conduct an annual self-evaluation to demonstrate accountability to the community and to ensure that District governance supports student achievement and the attainment of the District's goals.

At the December 8, 2005 Board meeting, the Board Self-Evaluation Instrument was distributed to all Board members, as required. The instrument was completed and returned to the Superintendent's Office. As Board President during 2005, Mrs. Moffat tallied the results as a whole. She will present her findings at tonight's meeting.

Following the evaluation, the Board shall discuss strategies for strengthening Board performance and establishing District goals and objectives.

FISCAL IMPACT: None

RECOMMENDATION: It is recommended that the Board of Education discuss the results of the Board Self-Evaluation Instrument.

CONSENT ITEMS

ROUTINE ITEMS ACTED UPON IN ONE MOTION UNLESS PULLED FOR DISCUSSION AND SEPARATE ACTION.

TOPIC: PURCHASE ORDERS LIST

DESCRIPTION: Purchase orders have been processed in accordance with the rules and regulations of the Board of Education and applicable legal requirements of the State of California.

District procedures and computer system controls require that an approved purchase order, pay voucher, current liability, or credit memo exist on the District's computer system prior to the issuance of warrants. There may be a multiple number of warrants drawn against a given purchase order up to the maximum amount for that purchase order. The system restricts the processing of payment amounts in excess of the issued purchase order.

It should be noted that the purchase order system allows for a one-line description of the services or items to be procured. The issued purchase order forms a contract between the District and the vendor.

FISCAL IMPACT: \$1,124,476.16

RECOMMENDATION: It is recommended that the Board of Education approve the Purchase Orders List dated November 28 through December 11, 2005 in the amount of \$1,124,476.16.

TOPIC: **WARRANTS LIST**

DESCRIPTION: Warrants have been processed in accordance with the rules and regulations of the Board of Education and applicable legal requirements of the State of California and the Orange County Department of Education.

District procedures and computer system controls require that an approved purchase order, pay voucher, current liability, or credit memo exist on the District's computer system prior to the issuance of warrants. There may be a multiple number of warrants drawn against a given purchase order up to the maximum amount for that purchase order. The processing of the warrant is in compliance with the contractual agreement that has been formed by the issuance of the purchase order.

FISCAL IMPACT: \$6,906,464.06

RECOMMENDATION: It is recommended that the Board of Education approve the Warrants List dated November 28, 2005 through December 11, 2005 in the amount of \$6,906,464.06.

TOPIC:

GIFTS

DESCRIPTION:

The gifts of equipment, educational materials, and/or cash as delineated on the attached list were donated to the Orange Unified School District for use as indicated. These items will be repaired or replaced at District expense only if economically feasible.

- Contract services of mathematics magician, Prof. Arthur Benjamin (\$650), to the OUSD Curriculum Dept., donated by Linda Stoterau

FISCAL IMPACT:

This item has no fiscal impact.

RECOMMENDATION:

It is recommended the Board of Education accept these gifts of cash, equipment, and/or instructional materials and that a letter of appreciation be forwarded to each benefactor.

DONATIONS

November 2005

To: Thomas A. Godley, Ed.D.
Superintendent of Schools

From: Joe Sorrera
Administrative Director, Fiscal Services

We have received the following donated monies. Please prepare the resolution for the following:

[illegible]

TOPIC: **CONTRACT SERVICES REPORT – BUSINESS SERVICES**

DESCRIPTION: The following is a report of contract service items for Business Services.

EMPIRE ECONOMICS, INC. On October 13, 2005, the Board of Education approved a list of consultants to work with staff to create and form Community Facilities District 2005-2 (Del Rio School Facilities). An additional consultant, Empire Economics, is needed to perform a price point analysis and absorption study to assure bond purchasers of the security of the investments. All costs will be reimbursed from the bond sale proceeds.
Special Reserve Fund.....not to exceed.....\$15,000
(including reimbursables)
40.00-0000-0-6200-9827-8500-416-416-000
(Christensen)

NYBERG ARCHITECTS The new shade structure with integrated PV system at El Rancho Charter School will require the services of a qualified Division of the State Architect (DSA) to prepare architectural drawings, structural drawings, electrical drawings, specifications and obtain DSA approval. Nyberg Architects can provide these services for the District.
General Fund (El Rancho Charter MS).....\$22,000
01.00-0910-0-5850-1132-8200-387-202-000 (Harlin)

FISCAL IMPACT: \$37,000

RECOMMENDATION: It is recommended that the Board of Education approve the Contract Services Report – Business Services as presented.

TOPIC: **ACCEPTANCE OF COMPLETED CONTRACT(S) AND FILING OF NOTICE(S) OF COMPLETION**

DESCRIPTION: The contract(s) listed below have been completed and require acceptance by the Board of Education prior to filing of appropriate notice(s) of completion:

EMERGENCY RESOLUTION 16-04-05 – ROOFING – GYMNASIUM

Project(s):	El Modena High School
Original Board Approval:	November 18, 2004
Original Purchase Order:	505577
Completion Date:	November 11, 2005
Contractor:	Danny Letner, Inc.
Original Project Amount:	\$82,948
Change Order(s) Amount:	\$ -0-
Total Project Amount:	\$82,948
Fund(s):	Deferred Maintenance (14)

EMERGENCY RESOLUTION 16-04-05 – INSTALL WOOD CURBS, INSTALL RAISE PLATFORMS & NEW DRAIN PANS – GYMNASIUM

Project(s):	El Modena High School
Original Board Approval:	November 18, 2004
Original Purchase Order:	507542
Completion Date:	November 11, 2005
Contractor:	Danny Letner, Inc.
Original Project Amount:	\$38,101
Change Order(s) Amount:	\$ -0-
Total Project Amount:	\$38,101
Fund(s):	Deferred Maintenance (14)

BID 564 – REFINISH GYM FLOOR

Project(s):	Canyon High School
Original Board Approval:	July 14, 2005
Original Purchase Order:	601233
Completion Date:	October 11, 2005
Contractor:	Geary Floors
Original Project Amount:	\$27,333
Change Order(s) Amount:	\$ 2,700 <i>(Additional floor board repair)</i>
Total Project Amount:	\$30,033
Fund(s):	General Fund (01)

ANAHEIM HILLS ELEMENTARY SCHOOL – PLAYFIELDS

Project(s): Anaheim Hills ES
Original Board Approval: May 23, 2000
Completion Date: October 27, 2005
Contractor: SunCal Companies

Note: As a condition of the original grading agreement entered into on May 23, 2000, the Anaheim Hills Elementary School playfields were reconstructed per DSA approved plans and specifications. Cost of installation being reimbursed to SunCal by the sale of bonds from Community Facilities District 2005-1 (Tremont).

The Public Contract Code allows school districts to issue contract change orders for up to ten percent of the original contract value. The District typically funds change orders with monies from the original source. If there were no additional monies available, then the District would fund the change through the balance reserve account.

In accordance with Public Contract Code Section 7107, the final payment of the ten percent (10%) retention of the value of the work done under these agreements shall be made thirty-five (35) days after recording by the District of the Notice(s) of Completion at the County of Orange Recorder's Office.

FISCAL IMPACT: No additional fiscal impact.

RECOMMENDATION: It is recommended that the Board of Education accept the above contract(s) as complete, authorize staff to file appropriate notice(s) of completion and release the retention payment(s) to the contractor(s).

TOPIC: APPROVAL OF AGREEMENT BETWEEN ORANGE UNIFIED SCHOOL DISTRICT AND OTHER ORANGE COUNTY SCHOOL DISTRICTS FOR TRANSPORTATION SERVICES

DESCRIPTION: Orange County School Districts have needs for unanticipated special education, athletic, field trip, homeless, special event, and student activity transportation services. Districts may lack the necessary school buses and bus drivers to meet these unanticipated and sometimes emergency needs. In order to avoid any disruption to student transportation service districts have agreed to participate in a county-wide transportation services agreement. Orange County Department of Education has provided the legal expertise to develop an agreement for all districts. The agreement outlines the terms of participation and rates for each participating district. Participation by any district is voluntary.

The Orange Unified School District (OUSD) has the capacity to provide unanticipated transportation services and also has a need for unanticipated student transportation services.

The agreement would be for an initial one and one-half year (1.5) term, followed by renewable one-year (1.0) options.

The arrangement may be terminated for convenience by any participating party, effective immediately upon written notice.

FISCAL IMPACT: None

RECOMMENDATION: It is recommended that the Board authorize participation in a county-wide transportation services agreement with other Orange County school districts.

TOPIC: PERSONNEL REPORT

DESCRIPTION: All actions listed in the Personnel Report, representing a cost to the District, have been reviewed by the Business Department and have been assigned a budget number. Appropriate funds exist in all budget areas presented in this Personnel Report. Some items on the report represent the maximum amount that could be encumbered for that item, the actual expenditure may be less, and in no instance will the expenditure be more than the requested amount without an additional request being generated.

This report may require actions for extra pay projects, separation from service, short-term employment, leaves of absence, change of status, and new hires. All requests are generated by individuals, school sites, or various District departments.

All of the above requests have been processed in accordance with the rules and regulations of the Board of Education and the applicable legal requirements of the State of California and the Orange County Department of Education.

FISCAL IMPACT: Certificated: \$141,354

Classified: \$38,238

RECOMMENDATION: It is recommended that the Board of Education approve the Personnel Report as presented.

CLASSIFIED AND CERTIFICATED PERSONNEL REPORT
CERTIFICATED PERSONNEL

	Name	Position	Administrative Unit	Schedule/Step/Column	Rate	Eff. From	Date To	Comments		
	EMPLOYMENT									
1	Duncan, Shannon	Teacher	Taft/James		30,078.00	11/29/05	6/19/06	Temp		
2	Omeste-Dorr, Jackie	Teacher	Canyon HS/Rohlander		23,784.00	11/30/05	6/16/06	Temp		
	CHANGE OF STATUS									
1	Diamond, Laura	Teacher	SpEd/Bittel			1/9/06	6/22/06	Contract Status 60% to 100%		
2	Doan, Julie	Teacher	SpEd/Bittel			1/3/06	6/19/06	Contract Status 80% to 100%		
3	Malamatenios, Beth	Teacher	SpEd/Bittel			1/3/06	6/19/06	Contract Status 80% to 60%		
4	McGinley, Danielle	Teacher	SpEd/Bittel			1/3/06	6/19/06	Contract Status 70% to 40%		
	LEAVE OF ABSENCE									
1	Goodger, Elisha	Teacher	Taft/James			1/9/06	6/19/06	Return from FMLA Child Care		
2	Kim, Jennifer	Teacher	California/Fisher			1/9/06	6/19/06	Return from FMLA Child Care		
3	Nelson, Robin	Teacher	Crescent Inter/Pail			1/9/06	6/19/06	Return from FMLA Child Care		
4	Parke, Laurel	Teacher	Imperial/Salata			11/21/05	12/9/05	Unpaid FMLA Child Care W/Benefit		
5	Parke, Laurel	Teacher	Imperial/Salata			12/12/05	6/19/06	Return from FMLA Child Care		
6	Patterson, Nicole	Teacher	Fairhaven/Stoces			4/27/05	6/19/06	Unpaid LOA Child Care W/O Benefit		
7	Sary-Amoroso, Linda	Teacher	Chapman Hills/Merkow			11/28/05	3/9/06	Unpaid FMLA Child Care W/Benefit		
	SEPARATIONS									
1	McKee, Rachel	Teacher	Anaheim Hills/Larson			12/16/05		Resignation		

Staff Responsibility:
Ed Kisse, Assistant Superintendent-Human Resource

CLASSIFIED AND CERTIFICATED PERSONNEL REPORT
CERTIFICATED PERSONNEL

	Name	Position	Administrative Unit	Schedule/Step/Column	Rate	Eff. From	Date To	Comments	# of Units	Salary
	EXTRA PAY									
1	Abel, Christy	Teacher	Esplanade/Van Eck	misc hrly rate	32.51	3/1/06	6/1/06	Grade Level Planning	4	130.04
2	Aiken Pease, Susan	Teacher	Portola/Van Eck	misc hrly rate	32.51	12/8/05	12/8/05	Parent Education Festival	2	65.02
3	Alvarez, Allison	Teacher	Esplanade/Van Eck	misc hrly rate	32.51	3/1/06	6/1/06	Grade Level Planning	4	130.04
4	Anderson, Robin	Teacher	Fairhaven/Van Eck	misc hrly rate	32.51	1/3/06	5/26/06	Kindergarten Intervention	96	3,120.96
5	Armenta, Cynthia	Teacher	La Veta/Ochoa	misc hrly rate	32.51	9/1/05	5/31/06	Teaching Study Skills	185	6,014.35
6	Avalos, Alejandra	Teacher	Esplanade/Van Eck	misc hrly rate	32.51	3/1/06	6/1/06	Grade Level Planning	4	130.04
7	Babayan, Anastasia	Teacher	Spec Prog/Ochoa	misc hrly rate	32.51	10/20/05	10/20/05	EL Advisors Meeting	1	32.51
8	Beaty, Tracy	Teacher	Spec Prog/Ochoa	misc hrly rate	32.51	10/20/05	10/20/05	EL Advisors Meeting	1	32.51
9	Beaumont, Carol	Teacher	Prospect/Van Eck	misc hrly rate	32.51	11/1/05	5/31/06	After School Tutoring	30	975.30
10	Bennett, Suzanne	Teacher	California/Van Eck	misc hrly rate	32.51	12/1/05	12/1/05	Parent Training	1	32.51
11	Berner, Michelle	Teacher	Cambridge/McNealy	payment	110.00	1/1/06	6/30/06	Off Track Training	3	330.00
12	Bledsoe, Mickie	Teacher	SpEd/Rohlander	noon sup rate	22.03	10/18/05	6/30/06	Noon Supervision	150	3,304.50
13	Bloom, Nancy	Teacher	Portola/Van Eck	misc hrly rate	32.51	11/10/05	6/16/06	SES Site Coordinator	30	975.30
14	Bloom, Nancy	Teacher	Portola/Van Eck	misc hrly rate	32.51	12/8/05	12/8/05	Parent Education Festival	3	97.53
15	Boothe, Julie	Teacher	Cambridge/Van Eck	misc hrly rate	32.51	11/15/05	11/15/05	Literacy Night	2	65.02
16	Borden, Sara	Teacher	Esplanade/Van Eck	misc hrly rate	32.51	3/1/06	6/1/06	Grade Level Planning	4	130.04
17	Boucher, Michael	Teacher	Portola/Van Eck	misc hrly rate	32.51	12/8/05	12/8/05	Parent Education Festival	3	97.53
18	Bowman, Bess	Teacher	Esplanade/Van Eck	misc hrly rate	32.51	3/1/06	6/1/06	Grade Level Planning	4	130.04
19	Brunner, Kathy	Teacher	Spec Prog/Ochoa	misc hrly rate	32.51	10/20/05	10/20/05	EL Advisors Meeting	1	32.51
20	Buchmiller, Marie	Teacher	Esplanade/Van Eck	misc hrly rate	32.51	3/1/06	6/1/06	Grade Level Planning	4	130.04
21	Buhr, Rhiannon	Teacher	California/Van Eck	misc hrly rate	32.51	12/1/05	12/1/05	Parent Training	1	32.51
22	Byrne, Cynthia	Teacher	Portola/Van Eck	misc hrly rate	32.51	12/8/05	12/8/05	Parent Education Festival	3	97.53
23	Carlson, Amanda	Teacher	Linda Vista/Rohlander	payment	110.00	11/11/05	11/11/05	Off Track Conference	1	110.00
24	Cazares, Claudia	Teacher	Portola/Van Eck	misc hrly rate	32.51	12/8/05	12/8/05	Parent Education Festival	2	65.02
25	Clark, Scott	Teacher	Portola/Van Eck	misc hrly rate	32.51	12/8/05	12/8/05	Parent Education Festival	3	97.53
26	Cody, Mary	Teacher	Spec Prog/Ochoa	misc hrly rate	32.51	10/20/05	10/20/05	EL Advisors Meeting	1	32.51
27	Cooley, Steve	Teacher	Fairhaven/Rohlander	misc hrly rate	32.51	11/14/05	6/30/06	Home Teaching	50	1,625.50
28	Cycenas, Joan	Teacher	Spec Prog/Ochoa	misc hrly rate	32.51	10/20/05	10/20/05	EL Advisors Meeting	1	32.51
29	Davis, Heather	Teacher	Canyon HS/Davis	misc hrly rate	32.51	11/1/05	6/30/06	Digital Math Project	20	650.20
30	Davis, Kathy	Teacher	Esplanade/Van Eck	misc hrly rate	32.51	3/1/06	6/1/06	Grade Level Planning	4	130.04
31	Delaney, Meghan	Teacher	Imperial/Salata	stipend	345.00	11/14/05	11/18/05	Outdoor Ed	1	345.00

Staff Responsibility:
Ed Kissee, Assistant Superintendent-Human Resources

CLASSIFIED AND CERTIFICATED PERSONNEL REPORT
CERTIFICATED PERSONNEL

	Name	Position	Administrative Unit	Schedule/Step/ Column	Rate	Eff. From	Date To	Comments	# of Units	Salary
32	Dieppa, Laurie	Teacher	Spec Prog/Ochoa	misc hrly rate	32.51	10/20/05	10/20/05	EL Advisors Meeting	1	32.51
33	Dowell, Rachel	Teacher	Anaheim Hills/Eslick	misc hrly rate	32.51	11/1/05	12/16/05	Native American Tutoring	10	325.10
34	Erickson, Rene	Teacher	Prospect/Van Eck	misc hrly rate	32.51	11/1/05	5/31/06	After School Tutoring	30	975.30
35	Espinoza, Elsie	Teacher	Spec Prog/Ochoa	misc hrly rate	32.51	10/20/05	10/20/05	EL Advisors Meeting	1	32.51
36	Evans, Joshua	Teacher	Spec Prog/Ochoa	misc hrly rate	32.51	10/20/05	10/20/05	EL Advisors Meeting	1	32.51
37	Felton, Jennifer	Teacher	Imperial/Salata	misc hrly rate	32.51	10/27/05	10/27/05	Literacy Night	4	130.04
38	Filson, Katherine	Teacher	Esplanade/Van Eck	misc hrly rate	32.51	3/1/06	6/1/06	Grade Level Planning	4	130.04
39	Flowers, Kimberly	Teacher	California/Ochoa	misc hrly rate	32.51	10/25/05	10/25/05	Parent Training	1	32.51
40	Fordham, Andrea	Teacher	Running Springs/Van E	misc hrly rate	32.51	10/26/05	10/26/05	Literacy Night	4	130.04
41	Francoeur, Jacquelin	Teacher	Information Serv/Davis	misc hrly rate	32.51	10/1/05	6/30/06	Blackboard/Laptop Training	250	8,127.50
42	Fusco, Judith	Teacher	Villa Park HS/Rich	hourly rate	69.87	8/29/05	6/17/06	Extra Period	185	12,925.40
43	Garcia, Adriana	Teacher	California/Van Eck	misc hrly rate	32.51	12/1/05	12/1/05	Parent Training	1	32.51
44	Gould, Sara	Teacher	Cambridge/Van Eck	misc hrly rate	32.51	11/15/05	11/15/05	Literacy Night	2	65.02
45	Gout, Heather	Teacher	Spec Prog/Ochoa	misc hrly rate	32.51	10/20/05	10/20/05	EL Advisors Meeting	1	32.51
46	Guffey, Laura	Teacher	Fairhaven/Rohlander	payment	110.00	11/11/05	11/11/05	Off Track Conference	1	110.00
47	Guiltinan, Eva	Teacher	Imperial/Salata	misc hrly rate	32.51	10/27/05	10/27/05	Literacy Night	2	65.02
48	Guzman, Kristen	Teacher	Cambridge/Van Eck	misc hrly rate	32.51	11/15/05	11/15/05	Literacy Night	2	65.02
49	Haitbrink, Barbara	Teacher	Spec Prog/Ochoa	misc hrly rate	32.51	10/20/05	10/20/05	EL Advisors Meeting	1	32.51
50	Heid, Brenna	Teacher	Canyon HS/McNealy	payment	110.00	11/1/05	12/31/05	BTSA/Induction Service	2	220.00
51	Henderson, Annie	Teacher	Cambridge/Van Eck	misc hrly rate	32.51	11/15/05	11/15/05	Literacy Night	2	65.02
52	Heslip, Darrian	Teacher	Portola/Van Eck	misc hrly rate	32.51	12/8/05	12/8/05	Parent Education Festival	3	97.53
53	Higgins, Michael	Teacher	Chapman Hills/Merkow	stipend	345.00	3/6/06	3/10/06	Outdoor Ed	1	345.00
54	Houston, Jacque	Teacher	Cambridge/Van Eck	misc hrly rate	32.51	11/15/05	11/15/05	Literacy Night	2	65.02
55	Hughes, Sarah	Teacher	Imperial/Salata	misc hrly rate	32.51	10/27/05	10/27/05	Literacy Night	2	65.02
56	Hughson, Sally	Teacher	Spec Prog/Ochoa	misc hrly rate	32.51	10/20/05	10/20/05	EL Advisors Meeting	1	32.51
57	Hull, Lenora	Teacher	Spec Prog/Ochoa	misc hrly rate	32.51	10/20/05	10/20/05	EL Advisors Meeting	1	32.51
58	Iadevia, Debbie	Teacher	Esplanade/Van Eck	misc hrly rate	32.51	3/1/06	6/1/06	Grade Level Planning	4	130.04
59	Irwin, Heather	Teacher	Parkside/Rohlander	misc hrly rate	32.51	11/28/05	12/2/05	IEP'S & Assessments	10	325.10
60	Jones, Marietta	Teacher	Imperial/Salata	misc hrly rate	32.51	10/27/05	10/27/05	Literacy Night	2	65.02
61	Kaping, Kristen	Teacher	Spec Prog/Ochoa	misc hrly rate	32.51	10/20/05	10/20/05	EL Advisors Meeting	1	32.51
62	Kavanaugh, Clifford	Teacher	Olive/Ochoa	misc hrly rate	32.51	11/17/05	3/31/06	Tutoring	30	975.30
63	Kenyon, Kami	Teacher	Spec Prog/Ochoa	misc hrly rate	32.51	10/20/05	10/20/05	EL Advisors Meeting	1	32.51
64	Kerckhoff, Stephanie	Teacher	Nutrition/Pollock	misc hrly rate	32.51	12/1/05	6/15/06	Network Grant	138	4,486.38
65	Kindsfather, Susan	Teacher	Imperial/Salata	stipend	345.00	11/14/05	11/18/05	Outdoor Ed	1	345.00

Staff Responsibility:

Ed Kissee, Assistant Superintendent-Human Resources

CLASSIFIED AND CERTIFICATED PERSONNEL REPORT
CERTIFICATED PERSONNEL

	Name	Position	Administrative Unit	Schedule/Step/Column	Rate	Eff. From	Date To	Comments	# of Units	Salary
66	Kruhmin-Sweaza, Liz	Teacher	Fairhaven/Van Eck	misc hrly rate	32.51	1/6/06	6/17/06	Lunch Time Writing Club	45	1,462.95
67	Lantz, Leigh	Teacher	Prospect/Van Eck	misc hrly rate	32.51	11/1/05	5/31/06	After School Tutoring	30	975.30
68	Lear, Charlene	Teacher	California/Ochoa	misc hrly rate	32.51	10/25/05	10/25/05	Parent Training	1	32.51
69	Lipson, Gayle	Teacher	Spec Prog/Ochoa	misc hrly rate	32.51	10/20/05	10/20/05	EL Advisors Meeting	1	32.51
70	Loneragan, Cathy	Teacher	West Orange/Koester	payment	110.00	8/25/05	8/26/05	Off Track Training	2	220.00
71	Lukenbill, Amy	Teacher	Cambridge/Van Eck	misc hrly rate	32.51	11/15/05	11/15/05	Literacy Night	2	65.02
72	Lydia, Herrera	Teacher	Esplanade/Van Eck	misc hrly rate	32.51	3/1/06	6/1/06	Grade Level Planning	4	130.04
73	Mahru, Cheryl	Teacher	Esplanade/Van Eck	misc hrly rate	32.51	3/1/06	6/1/06	Grade Level Planning	4	130.04
74	Mannen, David	Teacher	Portola/Van Eck	misc hrly rate	32.51	12/8/05	12/8/05	Parent Education Festival	3	97.53
75	Martina, Anaclea	Teacher	Portola/Van Eck	misc hrly rate	32.51	12/8/05	12/8/05	Parent Education Festival	3	97.53
76	McClure, Pamela	Teacher	Esplanade/Van Eck	misc hrly rate	32.51	3/1/06	6/1/06	Grade Level Planning	4	130.04
77	McCullough, Mary	Teacher	Esplanade/Van Eck	misc hrly rate	32.51	3/1/06	6/1/06	Grade Level Planning	4	130.04
78	McDonald, David	Teacher	Chapman Hills/Merkow	stipend	345.00	3/6/06	3/10/06	Outdoor Ed	1	345.00
79	McGuire, Akira	Teacher	Prospect/Van Eck	misc hrly rate	32.51	11/1/05	5/31/06	After School Tutoring	30	975.30
80	Meehleis, Anthony	Teacher	Esplanade/Van Eck	misc hrly rate	32.51	3/1/06	6/1/06	Grade Level Planning	4	130.04
81	Meiderhoff, Victoria	Teacher	Cambridge/Van Eck	misc hrly rate	32.51	11/15/05	11/15/05	Literacy Night	2	65.02
82	Meyer, Elizabeth	Teacher	Spec Prog/Ochoa	misc hrly rate	32.51	10/20/05	10/20/05	EL Advisors Meeting	1	32.51
83	Miller, Daniel	Teacher	Portola/Van Eck	misc hrly rate	32.51	12/8/05	12/8/05	Parent Education Festival	2	65.02
84	Miyamoto, Kristen	Teacher	Esplanade/Van Eck	misc hrly rate	32.51	3/1/06	6/1/06	Grade Level Planning	4	130.04
85	Moll, Vanessa	Teacher	Esplanade/Van Eck	misc hrly rate	32.51	3/1/06	6/1/06	Grade Level Planning	4	130.04
86	Moran, Jody	Teacher	Cambridge/Van Eck	misc hrly rate	32.51	12/8/05	2/28/06	Support for At-Risk Students	300	9,753.00
87	Morley, Michelle	Teacher	Imperial/Salata	misc hrly rate	32.51	10/27/05	10/27/05	Literacy Night	2	65.02
88	Narkun, Christy	Teacher	Portola/Van Eck	misc hrly rate	32.51	12/8/05	12/8/05	Parent Education Festival	2	65.02
89	Navarro, Michelle	Teacher	Spec Prog/Ochoa	misc hrly rate	32.51	10/20/05	10/20/05	EL Advisors Meeting	1	32.51
90	Navarro, Michelle	Teacher	California/Ochoa	misc hrly rate	32.51	10/25/05	10/25/05	Parent Training	1	32.51
91	Noxxel, Kathryn	Teacher	La Veta/Ochoa	misc hrly rate	32.51	10/1/05	6/30/06	Coordinator for Study Skills	10	325.10
92	Okamura, Lynn	Teacher	Running Springs/Van E	misc hrly rate	32.51	10/26/05	10/26/05	Literacy Night	4	130.04
93	Parrish, Karen	Teacher	Spec Prog/Ochoa	misc hrly rate	32.51	10/20/05	10/20/05	EL Advisors Meeting	1	32.51
94	Payton, Hedy	Teacher	Panorama/Van Eck	misc hrly rate	32.51	10/17/05	6/14/06	Instructional Support	96	3,120.96
95	Peck, Maria	Teacher	Esplanade/Van Eck	misc hrly rate	32.51	3/1/06	6/1/06	Grade Level Planning	4	130.04
96	Prelesnik, Vicki	Teacher	Running Springs/Van E	misc hrly rate	32.51	10/26/05	10/26/05	Literacy Night	4	130.04
97	Rathbun, Misty	Teacher	California/Ochoa	misc hrly rate	32.51	10/25/05	10/25/05	Parent Training	1	32.51
98	Regus, Dennis	Teacher	Portola/Van Eck	misc hrly rate	32.51	12/8/05	12/8/05	Parent Education Festival	3	97.53
99	Reyes, Jane	Teacher	Esplanade/Van Eck	misc hrly rate	32.51	3/1/06	6/1/06	Grade Level Planning	4	130.04

Staff Responsibility:
Ed Kisse, Assistant Superintendent-Human Resources

CLASSIFIED AND CERTIFICATED PERSONNEL REPORT
CERTIFICATED PERSONNEL

	Name	Position	Administrative Unit	Schedule/Step/ Column	Rate	Eff. From	Date To	Comments	# of Units	Salary
100	Robbins, Debby	Teacher	Imperial/Salata	misc hrly rate	32.51	10/27/05	10/27/05	Literacy Night	2	65.02
101	Robinson, Bonnie	Teacher	Spec Prog/Ochoa	misc hrly rate	32.51	10/20/05	10/20/05	EL Advisors Meeting	1	32.51
102	Robinson, Bonnie	Teacher	Fairhaven/Van Eck	misc hrly rate	32.51	12/1/05	6/30/06	SES Facilitator	45	1,462.95
103	Rockwell, Pamela	Teacher	Spec Prog/Ochoa	misc hrly rate	32.51	10/20/05	10/20/05	EL Advisors Meeting	1	32.51
104	Rohrig, Toni	Teacher	Spec Prog/Ochoa	misc hrly rate	32.51	10/20/05	10/20/05	EL Advisors Meeting	1	32.51
105	Roney, Genie	Teacher	Cambridge/Van Eck	misc hrly rate	32.51	11/15/05	11/15/05	Literacy Night	2	65.02
106	Roney, Julie	Teacher	Cambridge/Van Eck	misc hrly rate	32.51	11/15/05	11/15/05	Literacy Night	2	65.02
107	Sarkissian, Sarah	Teacher	Spec Prog/Ochoa	misc hrly rate	32.51	10/20/05	10/20/05	EL Advisors Meeting	1	32.51
108	Schram, Heather	Teacher	Esplanade/Van Eck	misc hrly rate	32.51	3/1/06	6/1/06	Grade Level Planning	4	130.04
109	Schultz, Phil	Teacher	Spec Prog/Ochoa	misc hrly rate	32.51	10/26/05	11/16/05	CLAD III Trainer	9	292.59
110	Scott Griffith, Christie	Teacher	Esplanade/Van Eck	misc hrly rate	32.51	9/1/04	6/1/05	SAIT Meetings	24	780.24
111	Scott Griffith, Christie	Teacher	Esplanade/Van Eck	misc hrly rate	32.51	9/1/05	6/1/06	SAIT Meetings	15	487.65
112	Scott Griffith, Christie	Teacher	Esplanade/Van Eck	misc hrly rate	32.51	3/1/06	6/1/06	Grade Level Planning	4	130.04
113	Scott, Margaret	Teacher	Esplanade/Van Eck	misc hrly rate	32.51	3/1/06	6/1/06	Grade Level Planning	4	130.04
114	Silva, Marianne	Teacher	Olive/Van Eck	misc hrly rate	32.51	1/12/06	6/30/06	CBET Teacher	80	2,600.80
115	Simmons, LaMonda	Teacher	Handy/Van Eck	misc hrly rate	32.51	10/17/05	10/28/05	Plan/Schedule Tutoring	5	162.55
116	Sinnema, Tracy	Teacher	California/Van Eck	misc hrly rate	32.51	12/1/05	12/1/05	Parent Training	1	32.51
117	Smith, Julie	Teacher	Esplanade/Van Eck	misc hrly rate	32.51	3/1/06	6/1/06	Grade Level Planning	4	130.04
118	Smith, Sherry	Teacher	Cambridge/Van Eck	misc hrly rate	32.51	11/15/05	11/15/05	Literacy Night	2	65.02
119	Snyder, Jana	Teacher	Parkside/Rohlander	misc hrly rate	32.51	11/28/05	12/2/05	IEP'S & Assessments	10	325.10
120	Stomp, Melissa	Teacher	Esplanade/Van Eck	misc hrly rate	32.51	3/1/06	6/1/06	Grade Level Planning	4	130.04
121	Thayer, Sonja	Teacher	Orange HS/Eslick	misc hrly rate	32.51	10/1/05	6/30/06	Native American Tutoring	30	975.30
122	Thomsen, Travis	Teacher	Portola/Van Eck	misc hrly rate	32.51	12/8/05	12/8/05	Parent Education Festival	3	97.53
123	Toovey, Cynthia	Teacher	Esplanade/Van Eck	misc hrly rate	32.51	9/1/04	6/1/05	SAIT Meetings	24	780.24
124	Toovey, Cynthia	Teacher	Esplanade/Van Eck	misc hrly rate	32.51	9/1/05	6/1/06	SAIT Meetings	15	487.65
125	Toovey, Cynthia	Teacher	Esplanade/Van Eck	misc hrly rate	32.51	3/1/06	6/1/06	Grade Level Planning	4	130.04
126	Topor, Sarah	Teacher	Spec Prog/Ochoa	misc hrly rate	32.51	10/20/05	10/20/05	EL Advisors Meeting	1	32.51
127	Torres, Rick	Teacher	Cambridge/Van Eck	misc hrly rate	32.51	11/15/05	11/15/05	Literacy Night	2	65.02
128	Turner, Gena	Teacher	Prospect/Van Eck	misc hrly rate	32.51	11/1/05	5/31/06	After School Tutoring	30	975.30
129	Vitullo, Mary	Teacher	Cambridge/Van Eck	misc hrly rate	32.51	11/15/05	11/15/05	Literacy Night	2	65.02
130	Wadkins, Nyra	Teacher	Running Springs/Van E	misc hrly rate	32.51	10/26/05	10/26/05	Literacy Night	4	130.04
131	Widdall, Kenneth	Teacher	El Modena HS/Ochoa	misc hrly rate	32.51	10/10/05	6/10/06	ELAC Mtgs/Tutoring	75	2,438.25
132	Williams, Danna	Teacher	Spec Prog/Ochoa	misc hrly rate	32.51	10/20/05	10/20/05	EL Advisors Meeting	1	32.51
133	Zedek, Ilene	Teacher	Prospect/Van Eck	misc hrly rate	32.51	11/1/05	5/31/06	After School Tutoring	30	975.30

Staff Responsibility:

Ed Kissee, Assistant Superintendent-Human Resources

CLASSIFIED AND CERTIFICATED PERSONNEL REPORT
CERTIFICATED PERSONNEL

Name	Position	Administrative Unit	Schedule/ Step/ Column	Rate	Eff. From	Date To	Comments	# of Units	Salary
EXTRA PAY PROJECT - COACHING STIPENDS									
Davies, Larry	Teacher	Villa Park HS/Rich	Stipend	2,105.00	11/1/05	2/28/06	Freshman Basketball Boys	1	2,105.00
Petrella, Sara	Teacher	Villa Park HS/Rich	Stipend	1,800.00	2/1/06	5/30/06	JV Girls Softball/Booster Paid	1	1,800.00

CLASSIFIED AND CERTIFICATED PERSONNEL REPORT
CLASSIFIED PERSONNEL

Name	Position	Administrative Unit	Range/Ste	Rate	Eff. From	Eff. To	Comments
EMPLOYMENT							
Hourly							
Francian, Virginia	Inst. Asst-Inclusion/ Anaheim Hills ES	Special Education/ Rohlander	26/1 (53)	\$ 12.06	11/15/2005		New position for new inclusion student
Gomez, Christina	Child Care Aide/ School Age Care	School Age Care/ Stephens	14/1 (53)	\$ 8.99	11/14/2005		Replacement for J. Molina
Gregg, Helen	Inst. Asst-SDC/ Special Programs	Special Education/ Rohlander	26/1 (53)	\$ 12.06	10/31/2005		Replacement for M. Olsen
Skvarla, Bridget	Inst. Asst-Inclusion/ Anaheim Hills ES	Special Education/ Rohlander	26/2 (53)	\$ 12.69	11/29/2005		New position for new inclusion student
Urias, Erick	Custodian/ Maintenance & Operations	Maintenance & Operations/ Torres	31/1 (51)	\$ 12.99	11/28/2005		Replacement for A. De La Vega
SHORT TERM EMPLOYMENT							
Davis, Andrew	AVID Tutor/ Yorba MS	Yorba MS/ Huerta	Per Hour	\$ 10.00	10/17/2005	6/15/2006	Not to Exceed \$2,000.00
Polcari, Jeffrey	Fire Science-EMT Aide/ R.O.P.	Career Education Center/ Snyder	Per Hour	\$ 11.00	9/1/2005	6/13/2006	Not to Exceed \$1,650.00
Williams, Preston	Fire Science-EMT Aide/ R.O.P.	Career Education Center/ Snyder	Per Hour	\$ 11.00	9/1/2005	6/13/2006	Not to Exceed \$1,650.00

Name	From	To	Eff. From	Date To	Comments
EMPLOYMENT CHANGE					
Hourly					
Alvarez, Ruth	CDC Aide	Unpaid LOA	11/22/2005		Unpaid Leave of Absence
	Child Development Center				
	22/6 (51)				
	12 mos/3.75 hrs				
Burns, Maurine	Inst. Asst. Coach	Inst. Asst. Coach	9/26/2005		Increase in work hours to meet student needs
	Workability	Workability			
	28/6 (51)	28/6 (51)			
	9.5 mos/5 hrs	9.5 mos/6 hrs			
Toscano, Alicia	Sr Central Kitchen Assistant	Central Cook/Baker	11/28/2005		Promotion, replacing M. Varela
	Crescent Intermediate	Crescent Intermediate			
	24/6 (51)	27/6 (51)			
	9.5 mos/8 hrs	11.5 mos/8 hrs			
Monthly					
Castillo, Yesenia	Insurance Technician	Unpaid LOA	11/2/2005		Unpaid Leave of Absence
	Business Services				
	42/3 (50)				
	12 mos/8 hrs				

Staff Responsibility: Ed Kisse
Assistant Superintendent - Human Resources

Staff Responsibility: Ed Kisse
Assistant Superintendent - Human Resources

CLASSIFIED AND CERTIFICATED PERSONNEL REPORT
CLASSIFIED PERSONNEL

Name	Position	Administrative Unit	Schedule/ Step/ Column	Rate	Eff. From	Date To	Comments	# of Units	Salary
	EXTRA PAY PROJECT-COACHING STIPENDS								
Davidson, Blair	Walk-On Coach	Villa Park HS/Rich	Stipend	2,041.00	11/1/05	2/28/06	VA Girls Waterpolo	1	2,041.00

TOPIC:	STUDENT TEACHER ASSIGNMENTS/AGREEMENTS
DESCRIPTION:	<p>It has long been the policy of the Orange Unified School District to cooperate with neighboring colleges/universities in assisting with teacher-training programs to provide educational fieldwork experiences in our schools for student teachers.</p> <p>These experiences are under the direct supervision and instruction of certificated employees of the District for a period not to exceed one semester. The college/university is responsible to direct, supervise and evaluate the performance of the student teacher cooperatively with District employees.</p>
FISCAL IMPACT:	This item has no fiscal impact.
RECOMMENDATION:	It is recommended that the Board of Education approve the attached student teaching assignment lists.

CLASSIFIED AND CERTIFICATED PERSONNEL REPORT
CERTIFICATED PERSONNEL

School	Student Teacher	Assignment	Begin Date	End Date	Master Teacher	University	Units
STUDENT TEACHER PLACEMENTS							
California	Sharpe, Jennifer	4th Gr.	1/30/06	3/24/06	Charlene Lear	Biola	5.0
California	Hughes, Sara	1st Gr.	1/30/06	3/24/06	Nanette Fryer	Biola	5.0
Handy	Wray, Richard	6th Gr.	1/9/06	3/8/06	Sandy Clark	Univ. of Phoenix	5.0
Handy	Cantrell, Luz	6th Gr.	12/1/05	2/16/06	Amber Cooper	Univ. of Phoenix	5.0

TOPIC: OUT-OF-STATE TRAVEL/CONFERENCE ATTENDANCE

DESCRIPTION: Staff members may attend inservices and conferences which are directly related to the school/site comprehensive development plan. At times the conference may require travel out of state.

Board Policy 4133/4233/4333 requires Board approval for all out-of-state travel. A request to attend an out-of-state conference is initially approved by the site administrator and subsequently by the appropriate cabinet-level administrator. Permission to travel out of state to perform authorized services for the District or attend an educational conference is requested below.

Haberer, Kathy/Pupil Services

Sopris West 2005 National Conference

Savannah, GA

January 12-16, 2006

Conference expense: \$1,175

(This conference will strengthen staff's background knowledge with the "Language!" intervention program currently being used with English Learners and special education students.)

FISCAL IMPACT: \$1,175 from budgeted accounts

RECOMMENDATION: It is recommended that the Board of Education approve the out-of-state travel for the individual as indicated above.

APPROVAL DATE: 01/05/06
Out-of-State Travel

**ORANGE UNIFIED SCHOOL DISTRICT
CONFERENCE REQUESTS**

CONFERENCE	LOCATION	DATE	PERSONNEL	NOT TO EXCEED/ # OF SUB DAYS	BUDGET NUMBER/ SUB BUDGET
Sopris West 2005 Natl Conf	Savannah, GA	1/12-1/16/05	Haberer, Kathy/Pupil Svcs	1,175.00	01.00-6500-0-5220-5770-1120-207-207

Approved as Submitted _____
Thomas A. Godley, Ed.D.
Superintendent

TOPIC:	STUDENT TEACHING AGREEMENT - UNIVERSITY OF LA VERNE
DESCRIPTION:	<p>The University of La Verne has been approved by the Western Association of Schools and Colleges.</p> <p>By entering into this Student Teaching Agreement, the Orange Unified School District agrees to provide teaching experience through practice teaching to students enrolled in teacher training curricula of the University of La Verne. The term of this agreement is effective November 30, 2005 and will remain in effect until terminated upon mutual consent of both parties.</p>
FISCAL IMPACT:	This item has no fiscal impact.
RECOMMENDATION:	It is recommended that the Board of Education approve Student Teaching Agreement with the University of La Verne.

Supervised Teaching / Fieldwork Agreement

THIS AGREEMENT entered into this day **November 30, 2005**, **Orange Unified School District**, by and between the University of La Verne through its Dean of the College of Education and Organizational Leadership on behalf of the Board of Trustees hereinafter called the University and, hereafter called the District, referred to in the collective as the Parties.

WITNESSETH

WHEREAS, the University is accredited by the State Board of Education as a teacher education institution and desires to provide teaching experience through directed teaching and/or fieldwork to its students enrolled in the University's teacher training curricula; and

WHEREAS, District agrees to allow University's students to gain the necessary teaching experience by teaching classes at its schools; and

WHEREAS, the parties agree to provide for the payment in money or in services for the services rendered by the District of an amount not to exceed the actual cost to the District of the services rendered; and

WHEREAS, it has been determined between the parties hereto that the payments to be made to the District under this agreement do not exceed the actual cost of the District of the services rendered by the District;

NOW, THEREFORE, it is mutually agreed between the parties hereto as follows:

1. The District shall provide teaching experience through directed teaching and fieldwork in schools and classes of the District for students of the University qualified for such assignments and assigned by the University to directed teaching or fieldwork in schools or classes of the District, and under the direct supervision and instruction of such employees of the District, as the district and the University through their duly authorized representatives may agree upon.

The District may, in its sole discretion, refuse to accept for directed teaching or fieldwork, any student of the University assigned in the district. Upon request of the District, the University shall terminate the directed teaching or fieldwork assignment of any student of the University in the District.

Directed Teaching, Directed Teaching in Reading, or Fieldwork in teacher education, school counseling, special education, administration and child development programs as used herein and elsewhere in this agreement mean active participation in the duties and function of classroom teaching

under the direct supervision and instruction of employees of the District holding valid credential, with a minimum of three years of exemplary teaching, issued by the State Board of Education, other than emergency or provisional credentials, authorizing them to serve as classroom teachers in the schools or classes in which the directed teaching or fieldwork are provided.

2. The University will pay the District for the performance by the District of all services required to be performed by the District under this agreement. (The supervised teaching experience ordinarily consists of two different teaching assignments and may take place in two different schools). There is no payment provision for the University's fieldwork assignments that must be completed in the University's coursework.

The number of semester units of directed teaching or fieldwork to be provided for each student of the University assigned to directed teaching or fieldwork under this agreement shall be determined by the University.

3. An assignment of a student of the University to directed teaching or fieldwork in schools or classes of the District shall be at the discretion of the University. A student may be given more than one assignment by the University to directed teaching or fieldwork in such schools or classes. The requirement for directed teaching in reading is the successful completion of specified reading and language arts objectives in a minimum of fifty clock hours. The assignment of a student of the University to directed teaching in the District shall be deemed to be effective for the purposes of this Agreement as of the date the student presents to the proper authorities of the District the assignment card or other document given him by the University effecting such assignments, but not earlier than the date of such assignments as shown on such card or other document.

In the event the assignment of a student of the University to directed teaching is terminated by the University or the District for any reason, the District shall receive payment on account of such student as though there had been no termination of the assignment, except that if such assignment is terminated before half the term of the assignment is completed, the District shall receive payment for an assignment for one-half services only.

4. Within a reasonable time following the close of each semester of the University the District shall submit an invoice, in duplicate, to the University for payment at the rate provided herein, for all students who participated in directed teaching provided by the District under and in accordance with this Agreement during said semester or quarter.

The District shall attach to the invoice a certificate, in duplicate, executed by a duly authorized representative of the District certifying that the District expended or became obligated to expend in providing such directed teaching an amount not less than the amount of the invoice.

2042 Credential Program

ED 468: Introductory Supervised Teaching - \$100.00 per student teaching assignment for each student in full-day introductory directed teaching. This is a five-week introductory teaching experience completed during the second semester of the program. ED 468 Introductory Supervised Teaching students have: passed CBEST, verified TB clearance, verified fingerprint clearance through DOJ clearance or certificate of clearance, completed two university courses.

ED 478: Advanced Supervised Teaching - \$200.00 per student teaching assignment for each student in full-day directed teaching. This is a ten-week advanced teaching experience completed during the last semester of the program. ED 478 Advanced Supervised Teaching students have: passed CBEST, CSET or verified subject matter competency waiver in an approved single subject area, verified fingerprint clearance through a valid certificate of clearance, verified TB clearance, passed RICA for multiple subject candidates, completed all university coursework.

5. The term of the agreement shall commence on the **30th day of November 2005** and may be terminated by either District or University immediately for cause upon giving written notice to the other party. If not terminated, this contract will remain in effect until a new or altered contract is requested by either the District or the University.
6. Notwithstanding anything herein contained to the contrary, this Agreement may be terminated and the provisions of this agreement may be altered, changed, or amended, by mutual written consent of both parties hereto.
7. Notwithstanding any other provisions of this agreement, the University shall not be obligated by this agreement to pay the District any amount in excess of a total of Three Hundred (\$300.00) per student for ED 409 and Two Hundred (\$200.00) for ED 478 or One Hundred (\$100.00) per student for ED 468.
8. Parties agree District is not responsible for maintaining workers' compensation coverage for students of the University.

Approval of this contract is hereby indicated by the following signature:

University of La Verne

Orange Unified School District

UNIVERSITY

DISTRICT

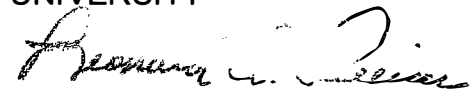

By _____

By _____

Thomas A. Godley, Ed.D.

Dean College of Education and
Organizational Leadership

Superintendent of Schools

TITLE

CERTIFICATION

I, the duly appointed and acting Secretary to the Governing Board of the School District listed below, do hereby certify that the following is a true and exact copy of a portion of the Minutes of the regular meeting of said Board held on
January 5, 2006.

It was moved, seconded and carried that the attached contract with **Orange Unified School District** whereby the University may assign students to the schools in the School District for directed teaching and / or fieldwork, be approved; and the Secretary to the Board is hereby authorized to execute the same.

Orange Unified School District
DISTRICT

Orange
COUNTY

BY
Thomas A. Godley, Ed.D.
Superintendent of Schools
TITLE

TOPIC: TEACHER ASSIGNMENT/CONSENT - PROVISIONAL INTERNSHIP PERMIT

DESCRIPTION: The Provisional Internship Permit is authorized under the provisions of Title 5, Section 80021.1, of the California Code of Regulations. The Provisional Internship Permit was created in response to the phasing out of emergency permits in the State of California and became effective on July 1, 2005. It allows a school district to fill an immediate staffing need by hiring an individual who has not yet met the subject matter competence requirement needed to enter an internship program. Prior to requesting a Provisional Internship Permit, the employing agency must verify that a diligent search has been made, and a fully-credentialed teacher cannot be found. The Provisional Internship Permit is only available at the request of a school district. Individuals may not apply directly to the Commission on Teacher Credentialing for this document. Holders of the Provisional Internship Permit are restricted to service within the school district requesting the permit.

The teacher(s) whose name(s) is/are listed on the following page has/have met the requirements for the Provisional Internship Permit and has/have consented to the assignment. Likewise, all other means of credentialing and reassignment have been explored. The approval of employment utilizing this permit will allow the District to remain compliant with SB 435, which requires that all teachers be appropriately assigned based upon each teacher holding a valid document for service as authorized by the Commission on Teacher Credentialing.

FISCAL IMPACT: This item has no fiscal impact.

RECOMMENDATION: It is recommended that the Board of Education approve the attached Provisional Internship Permits as presented.

**EMPLOYMENT BASED ON
PROVISIONAL INTERNSHIP PERMIT**

Board Agenda
January 5, 2006

<u>NAME</u>	<u>SITE</u>	<u>POSITION</u>	<u>CREDENTIAL SUBJECT AREA</u>
Blatnik, Melissa	Itinerant	Deaf and Hard of Hearing Specialist	Education Specialist Instruction – Deaf and Hard of Hearing
Uriostegui, Arturo	Orange High	RSP	Education Specialist Instruction – Mild/Moderate Disabilities

TOPIC:	CONTRACT SERVICES REPORT: EDUCATIONAL SERVICES
DESCRIPTION:	The following is a report of contract service items for Educational Services.
SPECIAL EDUCATION STUDENT ID # 309544	<p>As the result of a settlement agreement, the District has agreed to reimburse the parents for educational related expenses during the 2005/06 school year. Reimbursement will be based upon receipt of invoices and verification of payment made.</p> <p>Special Education not-to-exceed \$15,600 01-00-6500-0-5835-5001-2110-207-207-000 (Gee)</p>
LAW OFFICES OF DANIELLE AUGUSTIN	<p>As the result of a settlement agreement in SEHO Case No. SN05-01455, the District has agreed to pay reasonable and compensable attorney fees. Payment shall be made based on itemized billing statements submitted to the District.</p> <p>Special Education not-to-exceed \$5,500 01-00-6500-0-5835-5001-2110-207-207-000 (Gee)</p>
FISCAL IMPACT:	\$21,100
RECOMMENDATION:	It is recommended that the Board of Education approve the Contract Services Report - Educational Services as presented.

TOPIC:

STUDY TRIPS

DESCRIPTION:

El Modena High School – Speech and Debate Team
Union City, CA - January 13-15, 2006

El Modena High School's Speech and Debate team under the direction of their coach Molly Chertock would like to travel to James Logan High School for the Martin Luther King Invitational Speech Tournament. Students will be able to test speech skills against Northern California Schools in order to adapt speaking style for the State Tournament to be held in Northern California in April. Additionally, this is a pre-qualifying tournament for National Forensics League. The three (3) male and two (2) female students will be accompanied by one (1) adult female chaperone. Students and teacher will be staying at the Courtyard by Marriott in Newark, CA. Transportation will be provided by Katella High School Bus, who will share transportation. Cost is \$90 per student and scholarships will be available. The students will miss one school day and a substitute will also be required for one day. The cost will be funded by the Speech Team.

Canyon High School Girls' Varsity Softball Team – Bullhead City, AZ – March 9, 10, 11, 2006

Canyon High School Girls Varsity Softball Team under the direction of their coach Lance Eddy would like to travel to Bullhead City, AZ to compete in the Tournament of Champions Invitational Softball Tournament. This is a great opportunity for the team to compete against teams from across the U.S. as well as gain exposure to college scouts. The fifteen (15) female student/athletes will be accompanied by six (6) female and three (3) male adult chaperones. The students will be lodged at the Flamingo Hilton in Laughlin, Nevada and transportation will be provided parents. Any parent providing transportation to a student other than their own will have an approved Orange Unified School District Driver Certificate form completed and approved prior to this trip. The cost per student is \$75.00 is all inclusive and scholarships are available. The students will miss one full day and one partial day of school. No substitute will be required.

El Modena High School Pep Squad – Orlando, Florida –
February 3, 4, 5, 6, 7, 2006

El Modena High School Pep Squad, under the direction of their coach Clay Stiles would like to travel to Orlando, Florida to compete in the Universal Dance Association National Competition. The Varsity Cheerleaders qualified to compete based on their superior performance at the UDA Summer Camp. The student/athletes participation will encourage team building, leadership skills, and sportsmanship. The ten (10) female students/athletes will be accompanied by three (3) female and two (2) male adult chaperones. They will travel by air via Southwest Airlines from LAX to Orlando. They will be housed at Disney Caribbean Beach Resort and the cost per student will be \$1300.00 with scholarships available. The transportation to and from the airport will be provided by the parents with parents driving only their own child. A substitute will be required for three days and the expense will be funded by the El Modena High Cheer Boosters. The students will miss three days of school.

Canyon High School Wrestling Team – Lancaster, CA –
January 20, 21, 2006

Canyon High School Wrestling Team under the direction of their Coach Scott Lawson would like to participate in the Challenge Varsity Tournament to be held at Antelope Valley High School. The student/athletes will have the opportunity to compete against other athletes from across the state as well as gain exposure to college recruiters. The fourteen (14) male students will be accompanied by two (2) male adult chaperones. Transportation will be provided by the parents and the coaches. Any person driving a student other than their own will have an approved Orange Unified School District driver certificate form completed and approved prior to this trip. The students will be housed at the Holiday Inn Express in Lancaster and there is no cost to the students. The students will miss a partial day and no substitute will be required.

FISCAL IMPACT: These items have no fiscal impact to the district.

RECOMMENDATION: It is recommended that the Board of Education approve these study trips as presented.

TOPIC: **COURSE APPROVALS: ADVANCED ANNUAL (FORMERLY ANNUAL IV), ADVANCED JOURNALISM (FORMERLY JOURNALISM IV), ANNUAL I, JOURNALISM I, LANGUAGE ARTS**

DESCRIPTION: The revised course outlines described below have been reviewed by the District's Curriculum Council and are recommended to the Board of Education for approval.

REVISED COURSES

- **Advanced Annual (Formerly Annual IV)** is a year-long lecture and lab course in which students apply knowledge and skills acquired in Annual I and/or acquired through prior individual experience in the production of an actual yearbook as a creative and professional experience. Using significant works from past to present, students will analyze and implement historical and cultural elements of the visual and language arts as they apply to the production of an aesthetically pleasing publication that is distributed and seen by the campus and local community. Students will create original graphic works from rough draft to print using various forms of media, including but not limited to, graphic illustrations, photography, electronic and digital imaging equipment, and software and visual art concepts for various layouts throughout the publication. Students will learn the vocabulary connected to the arts and media to communicate with the contracted professional publisher and photo studio and their respective printing facilities and production coordinators. Students will also learn about technology in the visual arts, experience connections to the other arts and subjects, and explore related careers. Students will develop a personal portfolio, including the final yearbook, to be used for assessment, promotion, and exhibition.

All students are responsible for developing a plan, design, and theme for the book, assigning stories, gathering and processing information, writing copy, taking pictures, cropping and manipulating photos and other graphic elements using digital imaging software (i.e., Adobe, Microsoft, etc.), copy reading and fitting, proofreading, fundraising, including advertising and book sales, and book distribution.

In most cases, editorial positions are assigned to advanced yearbook students, who are encouraged to participate in summer camps (hosted by the publisher) and school site workshops (hosted by the advisor) to prepare them for the assumption of responsibilities for supervising the production and sale of the book. These include assigning deadline dates, collecting, proofing and correcting material for the printer, keeping financial records, and preparing and monitoring a budget.

- **Advanced Journalism (Formerly Journalism IV)** is a year-long lecture and lab course in which the student will explore graphic design and photography as a creative experience; learn the vocabulary of visual arts as applied to layout design and apply it to their own work and those of others; learn to use graphic design software to create visually stimulating and creative layouts; understand and learn to use photographic equipment and how to implement photo journalism as art; produce an original periodical; learn about the historical and cultural significance of media; chronicle events and issues that a modern day high school will encounter; learn the vocabulary connected to communicating with a professional printing company; produce an aesthetically pleasing completed publication using a variety of electronic and digital imaging equipment; and become educated consumers and active members of print and visual media.
- **Annual I** is a year-long introductory course designed to acquaint students with the various aspects of journalistic writing, page design, advertising, sale, and publication of a modern yearbook and news feature magazine. Through practical assignments, the student develops skill in research and interviewing as well as news, feature, sports, and mini-report writing. Fluency, accuracy, proper attribution, grammar, spelling, punctuation, and creativity are emphasized.

While improving student writing for publication is the primary focus of the course, consideration is also given to developing skills in design and organization. The student will be required to design a book, cover and content, incorporating all the elements of graphic design, software programs that utilize graphic style (i.e., Adobe, inDesign, Quark, etc.), layout style, photography, typography, and

writing style into a unified and appealing theme. The student will produce a mock-up of his/her design as well as the layouts, copy and communications to the publisher necessary for the production of his/her plan.

- **Journalism I** is a year-long introductory course designed to acquaint the student with the many aspects of news writing and publication of a modern newspaper. Students will practice and develop skills in different types of news gathering, news writing, fundamentals of photography, and the fundamentals of page design. All aspects of the course will focus on the ethics that are essential to the practice of journalism.
- **Language Arts 6** is a year-long course. In order for students to be successful in understanding and using all aspects of Language Arts, they should receive a *comprehensive balanced* program; *systematic* literature program; clearly communicated sense of common goals that respect diversity; an emphasis in the beauty and heritage of our language; instruction in the development of the writing process, including and incorporating the organization of ideas, the marshaling of evidence, and the choosing of the most appropriate words to express an idea; knowledge of language structure, language conventions (e.g., spelling and punctuation), media techniques, figurative language, and genre to create writing for a wide variety of purposes and audience; and techniques to become effective listeners and communicators as they apply these skills for a variety of purposes and their audiences.

FISCAL IMPACT: This item has no fiscal impact on the general fund.

RECOMMENDATION: It is recommended that the Board of Education approve the above-described courses presented by the District's Curriculum Council for use in the Orange Unified School District.

TOPIC:	IMMEX GRANT – SERRANO ELEMENTARY SCHOOL
DESCRIPTION:	<p>Serrano's application for a grant to participate in the IMMEX pilot program has been accepted and funded in the amount of \$600 from Project Tomorrow. Funds will be used for stipends for two Serrano teachers, Vick Schmuhl and Tracy Greer, to participate in a two-day IMMEX summer workshop. The school will also receive additional funds for collaboration time and computers to support the pilot effort.</p> <p>The IMMEX program is a web-based, problem-solving simulations that interweave California State Standards, curricular content and technological issues commonly encountered in careers in science, technology, engineering and mathematics for students in grades 1-8. IMMEX problem solving engages students in scientific inquiry, where students frame problems from a descriptive scenario, distinguish relevant from irrelevant information, plan a search strategy, gather information and reach a decision that demonstrates understanding.</p>
FISCAL IMPACT:	\$600 deposited into Serrano's grant budget.
RECOMMENDATION:	It is recommended that the Board of Education approve the grant to participate in the IMMEX pilot program on behalf of Serrano Elementary School.

TOPIC:	JOINT POWERS AGREEMENT BETWEEN ORANGE UNIFIED SCHOOL DISTRICT AND OTHER ORANGE COUNTY PUBLIC EDUCATIONAL AGENCIES
DESCRIPTION:	This proposed joint powers agreement establishes a collaborative to support legal change in special education by jointly supported special education cases through judicial and administrative processes. Examples of these functions include analyzing Special Education Hearing Office decisions that have negative impact on school districts, to determine if decisions have countywide significance and determine if legal appeals are needed; to assist school districts in funding of litigation for appeals in the above cases; to assist with the costs of filing amicus briefs in appropriate cases; and to assist school districts in resolving attorney fee and advocacy fee disputes.
FISCAL IMPACT:	The billing for the 2005/2006 year will be the \$.50 per actual ADA for the year (not to exceed \$16,000). Funding will be from the special education budget for legal costs.
RECOMMENDATION:	It is recommended that the Board of Education authorize the District to enter into the Joint Powers Agreement designated as the Orange County Special Education Legal Alliance.

TOPIC: TEXTBOOK ADOPTIONS – 30-DAY REVIEW BY PUBLIC

DESCRIPTION: Textbooks and supplementary instructional texts are reviewed by teacher committees from respective grade levels or departments, who screen available texts and materials for potential adoption. The selection committee(s) submits their recommendations to the District Instructional Materials Advisory Committee (IMAC) for review and consideration. The IMAC committee is composed of parents, principals, media specialists, and teachers whose responsibility is to recommend to the Board of Education approval of the considered texts.

It is at this juncture that the Board of Education places the texts and/or supplementary texts on "30-day review period," so members from the public may have an opportunity to review those texts, pending formal adoption. The texts are available for review in the Board Room this evening and after tonight in the offices of the Library Media Technology/G.A.T.E. Coordinator located in the Instructional Media Center. After the 30-day review period, the Board of Education takes formal action to adopt the textbooks and/or supplementary texts.

FISCAL IMPACT: Textbooks will be purchased from the textbook accounts during the 2005/2006 school year. Auxiliary adoption texts are used to supplement the basic textbook and are purchased with funds other than the state textbook monies.

District and State Textbook Account Numbers:
01.00-7156-0-4110-1110-1000-609-609-000,
01.00-7158-0-4210-1110-2420-609-609-000,
Other school textbook accounts are used for auxiliary adoptions.

RECOMMENDATION: It is recommended that the Board of Education place the attached list of textbooks on display for the 30-day review period and be considered for adoption at the February 9th Board Meeting.

Orange Unified School District

TEXTBOOK ADOPTIONS

Board Review – January 5, 2006

Final Approval – February 9, 2006

AUXILIARY ADOPTION

<i>Title</i>	<i>Subject</i>	<i>Grade Level</i>	<i>Publisher</i>	<i>Copyright</i>	<i>ISBN</i>	<i>Funding Source</i>	<i>State Matrix</i>	<i>IMAC</i>
Ordinary People	Language Arts	12	Penguin Books	1976	0140065172	Non-Textbook Funds	No	12/5/05
Pudd'nhead Wilson	Language Arts	11	Signet Classics	1894	0553211587	Non-Textbook Funds	No	12/5/05

TOPIC:	SPECIAL EDUCATION NON-PUBLIC SCHOOLS & DESIGNATED INSTRUCTIONAL SERVICES- <u>2005-2006</u>
DESCRIPTION:	Pursuant to the requirements of California Education Code Section 56365(a) – Non-Public Schools/Agencies (NPS) and Designated Instruction and Services (DIS) – (i.e., speech/language, physical/occupational therapy, orientation mobility training, adaptive physical education) – the Board of Education is authorized to place individuals with exceptional needs in non-public schools/agencies when those pupils cannot be appropriately served within the programs available in the school district.
FISCAL IMPACT:	Special Education Funds: \$75,783 01.00-6500-0-5870-5750-1180-207-207-000 01.00-6500-0-5871-5770-1190-207-207-000
RECOMMENDATION:	It is recommended that the Board of Education authorize non-public school/agency placement for the student identification numbers listed on the attached report, as presented.

**Orange Unified School District
Report of Special Education
Non-Public Schools & Designated Instructional Services 2005/2006**

Board Date: January 5, 2006

<u>ID #</u>	<u>NON-PUBLIC SCHOOL</u>	<u>\$COST</u>	<u>PERIOD COVERED</u>
340206	Blind Children's Learning Center Santa Ana, California	8,100.00 Addendum	09/06/05-06/30/06
340775	Mardan Center of Ed. Therapy Irvine, California	22,560.00	11/09/05-06/30/06
312042	Rossier Park Elementary Orange, California	886.20	11/21/05-06/30/06
313468	Speech & Language Dev. Center Buena Park, California	2,079.00 Addendum	11/01/05-06/30/06
340822	Therapeutic Education Center Santa Ana, California	28,757.00	10/25/05-06/30/06

<u>ID #</u>	<u>DESIGNATED INSTRUCTION</u>	<u>\$COST</u>	<u>PERIOD COVERED</u>
332589	Gallagher Pediatric Therapy Fullerton, California	800.00	07/01/05-06/30/06
333732	Speech Pathology & Associates Irvine, California	12,600.00	10/04/05-06/30/06

OUSD/Cohen/Gee
Board Agenda
January 5, 2006

TOPIC:	EXPULSION OF STUDENT: CASE NO. 05-06-08
DESCRIPTION:	Violation of California Education Code 48900 (c), (d) and (k) and 48915 (c) (3).
FISCAL IMPACT:	The District will have a loss of ADA for two semesters.
RECOMMENDATION:	<p>It is recommended that the Board of Education uphold the recommendation that the student be expelled from the schools of the District for two semesters (June 16, 2006).</p> <p>A hearing panel of administrators met on Thursday, December 1, 2005, and determined that a recommendation for expulsion be presented to the Board of Education. The student will be permitted to attend an alternative program and maintain a 2.0 GPA, complete 20 community service hours validated in writing. The student is to have no further violations of penal codes or education codes. Student and parent/guardian are to meet with the Office of Child Welfare & Attendance at the end of the expulsion period. Student will be required to provide chemical testing at no cost to the district prior to re-enrollment into the Orange Unified School District.</p>

TOPIC: **EXPULSION OF STUDENT: CASE NO. 05-06-09**

DESCRIPTION: Violation of California Education Code 48900 (c), (j) and (k).

FISCAL IMPACT: The District will have a loss of ADA for two semesters.

RECOMMENDATION: It is recommended that the Board of Education uphold the recommendation that the student be expelled from the schools of the district for two semesters (June 16, 2006).

A hearing panel of administrators met on Thursday, December 1, 2005, and determined that a recommendation for expulsion be presented to the Board of Education. The student will be permitted to attend an alternative program and maintain a 2.0 GPA, complete 20 community service hours validated in writing. The student is to have no further violations of penal codes or education codes. Student and parent/guardian are to meet with the Office of Child Welfare & Attendance at the end of the expulsion period. Student will be required to provide chemical testing at no cost to the district prior to re-enrollment into the Orange Unified School District.

TOPIC:	EXPULSION OF STUDENT: CASE NO. 05-06-10
DESCRIPTION:	Violation of California Education Code 48900 (b), (k) and 48915 (a) (2).
FISCAL IMPACT:	The District will have a loss of ADA for two semesters.
RECOMMENDATION:	<p>It is recommended that the Board of Education uphold the recommendation that the student be expelled from the schools of the district for two semesters (June 16, 2006).</p> <p>A hearing panel of administrators met on Monday, December 5, 2005, and determined that a recommendation for expulsion be presented to the Board of Education. The student will be permitted to attend an alternative program and maintain a 2.0 GPA, complete 20 community service hours validated in writing. The student is to have no further violations of penal codes or education codes. Student and parent/guardian are to meet with the Office of Child Welfare & Attendance at the end of the expulsion period.</p>

TOPIC:	EXPULSION OF STUDENT: CASE NO. 05-06-11
DESCRIPTION:	Violation of California Education Code 48900 (b), (k) and 48915 (a) (2).
FISCAL IMPACT:	The District will not have a loss of ADA for two semesters.
RECOMMENDATION:	<p>It is recommended that the Board of Education uphold the recommendation that the student be expelled from the schools of the district for two semesters, however, the expulsion be suspended (June 16, 2006).</p> <p>A hearing panel of administrators met on Monday, December 5, 2005, and determined that a recommendation for expulsion be presented to the Board of Education. The student will be permitted to attend another middle school and maintain a 2.0 GPA, complete 20 community service hours validated in writing. The student is to have no further violations of penal codes or education codes. Student and parent/guardian are to meet with the Office of Child Welfare & Attendance at the end of the expulsion period.</p>

TOPIC:	EXPULSION OF STUDENT: CASE NO. 05-06-12
DESCRIPTION:	Violation of California Education Code 48900 (b), (k) and 48915 (a) (2).
FISCAL IMPACT:	The District will have a loss of ADA for two semesters.
RECOMMENDATION:	<p>It is recommended that the Board of Education uphold the recommendation that the student be expelled from the schools of the district for two semesters (June 16, 2006).</p> <p>A hearing panel of administrators met on Tuesday, December 6, 2005, and determined that a recommendation for expulsion be presented to the Board of Education. The student will be permitted to attend the ACCESS program and maintain a 2.50 GPA, complete 20 community service hours validated in writing. The student is not to be involved in gang affiliation of any kind and is not to have any further violations of penal codes or education codes. Student and parent/guardian are to meet with the Office of Child Welfare & Attendance at the end of the expulsion period.</p>

TOPIC: **EXPULSION OF STUDENT: CASE NO. 05-06-13**

DESCRIPTION: Violation of California Education Code 48900 (b), (k) and 48915 (a) (2).

FISCAL IMPACT: The District will have a loss of ADA for two semesters.

RECOMMENDATION: It is recommended that the Board of Education uphold the recommendation that the student be expelled from the schools of the district for two semesters (June 16, 2006).

A hearing panel of administrators met on Tuesday, December 6, 2005, and determined that a recommendation for expulsion be presented to the Board of Education. The student will be permitted to attend the ACCESS program and maintain a 2.0 GPA, complete 20 community service hours validated in writing. The student is not to be involved in gang affiliation of any kind and is not to have any further violations of penal codes or education codes. Student and parent/guardian are to meet with the Office of Child Welfare & Attendance at the end of the expulsion period.