

LPA

January 25, 2021



Orange Unified School District

Villa Park HS Feeder Area: Town Hall

Para servicios de traducción en español, por favor llame al número de abajo:

Tel +1 323-457-5029

Phone Conference ID: 688-846-55#



LPA

Superintendent Introduction



Gunn Marie Hansen, Ph.D.

Superintendent, Orange Unified School District

Para servicios de traducción en español, por favor llame al número de abajo:

Tel +1 323-457-5029

Phone Conference ID: 688-846-55#

Your Team



LPA



Jim Kisel
Principal
Director of K-12



Sabrina Leman
Project Manager



Samuel Lim
Associate
Managing Director



Lindsay Hayward
Associate
Educational Program Visioning



Lea Espinosa
Designer



Andrea Pippin
Educational Facilities Planner

**Para servicios de traducción en español, por favor llame al número de abajo:
Tel +1 323-457-5029
Phone Conference ID: 688-846-55#**



Town Hall Agenda

• District Welcome		
• Town Hall Purpose		
• Meeting Protocols	5 minutes	
• FMP Process Summary	5 minutes	
• OUSD Vision for Innovation	10 minutes	
• Planning for the Future & Educational Specifications	10 minutes	
• School Site Committee Role & Next Steps		
• Draft School Sites Opportunities Diagrams	60 minutes	1:30 Hours

Para servicios de traducción en español, por favor llame al número de abajo:
Tel +1 323-457-5029
Phone Conference ID: 688-846-55#



LPA

Town Hall Purpose

- To provide background information regarding the Facilities Master Plan (long term improvements to school facilities, not short-term re-openings)
- To provide the first drafts of the site master plan diagrams
- To address initial questions that you may have pertinent to these diagrams
- To explain the next steps in gathering input

Para servicios de traducción en español, por favor llame al número de abajo:

Tel +1 323-457-5029

Phone Conference ID: 688-846-55#

GoTo Webinar Participation Protocols



LPA

- Expand And Hide The Control Panel
- Audio And Video Are Turned On For Organizers
- Raise Your Hand If You Would Like To Speak
- We Will Unmute You When We're Ready For Your Question Or Comment
- Questions & Comments May Be Submitted And Will Be Answered At The End Of The Presentation
- Please Participate In The Polling Question; You May Have To Minimize Your Browser Window
- Your Voice Matters...

We Hope You Enjoy The Meeting!

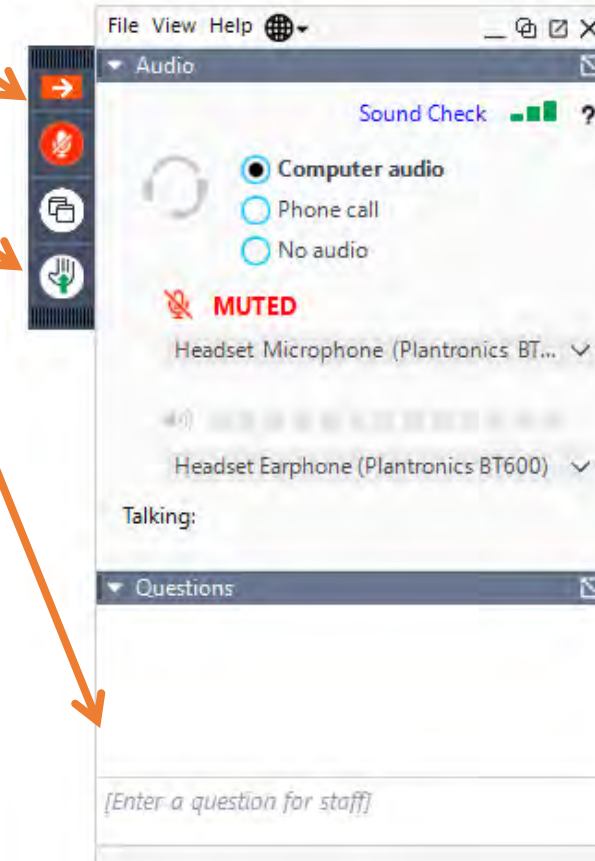

Para servicios de traducción en español, por favor llame al número de abajo:

Tel +1 323-457-5029

Phone Conference ID: 688-846-55#

Comments & Questions



LPA

- If you have additional questions or comments after this meeting, you can:
 - Contact your School Site Committee
 - Submit a question or comment to the Facilities & Planning Department:
 - Visit the Facilities & Planning website at OrangeUSD.org/departments/facilities-planning
 - Or use the QR code to the right



Para servicios de traducción en español, por favor llame al número de abajo:

Tel +1 323-457-5029

Phone Conference ID: 688-846-55#



Ice-Breaker Question

Which **hobby** did you pick up in 2020?

- Baking / Cooking
- Hiking / Fitness
- Reading
- Gardening
- Art / Painting



FMP Process Summary



FMP Schedule

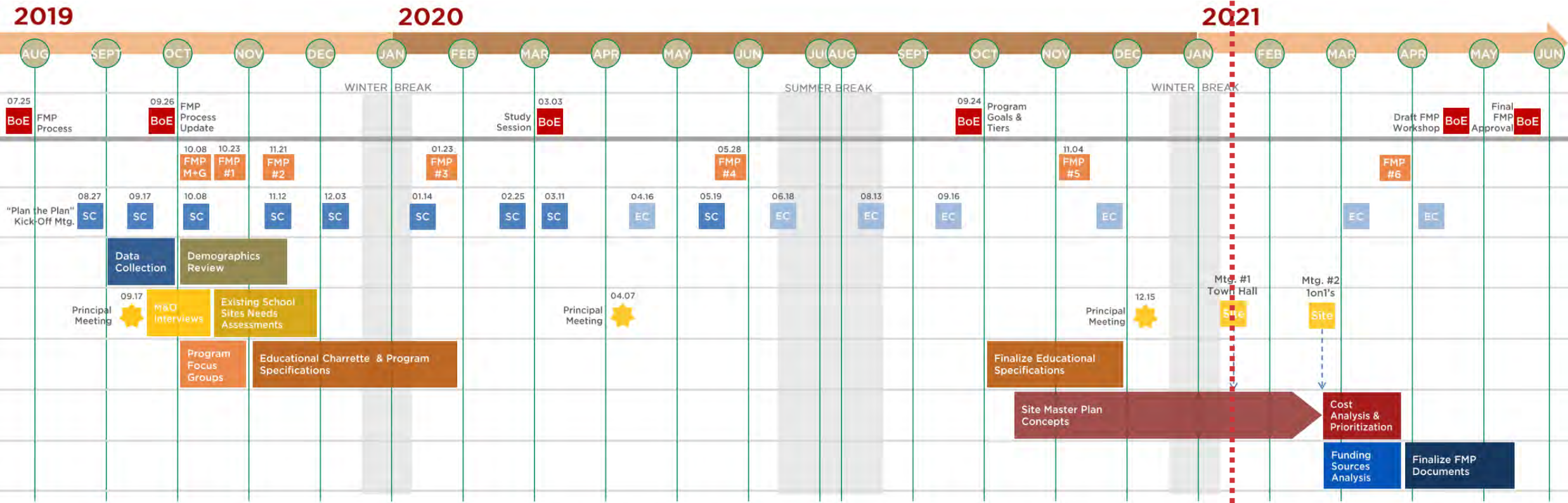

KEY

- FMP Facilities Master Plan Committee
- SC Steering Committee
- BoE Orange USD Board of Trustees
- Site School Site Committees
- EC Executive Cabinet

Board of Education
FMP Process
Program Goals & Visioning
Draft FMP
Final FMP Approval
4 TOTAL Meetings

Facilities Master Plan Committee (FMPC)
(Meets Monthly During the FMP Planning Process)
6 TOTAL Meetings

School Site Committees (SSC)
28 Elementary Schools
5 Middle Schools
4 High Schools
4 District Support Sites
42 SITES Total

PROPOSED FMP GROUPS MEETINGS
SSC Town Hall / Mtg's
Mtg. #1 - Process Overview & Draft Master Plans
Mtg. #2 - '1on1' Mtg. w/ SSC's Representatives

The Challenges We Are Facing



LPA

- Old sites with aging infrastructure
- Have not invested a lot of \$ into facilities improvements
- Some sites are not educationally appropriate for NextGen learning
- Projected decline in enrollment
- Surrounding Districts are rebuilding facilities and innovating programs
- Competing with other Districts and Private Schools for students
- Becoming ready to draw Draft Master Plans for each site

Guiding Principles



LPA

- Students are at the center of the District's Mission. Embrace the OUSD EDGE and translate its initiatives to facilities.
- Engage community in the process to foster ownership and support.
- Develop an actionable long-term plan, grounded in OUSD's Strategic Vision and built on previous accomplishments and successes.
- Create a positive student experience through development of innovative, adaptable, high-quality learning environments.
- Construct equitable, safe, welcoming and inclusive facilities that cultivate student, staff and community pride.
- **Promote stewardship** through the development of a responsible plan based on integrity and excellence.





LPA



OUSD Vision for Innovation

Translation of Guiding Principles into Actionable Goals for FMP

- Innovation in Planning and Programs
- Provide Educational Options for Students within their Communities
- Retain Resident Students
- Expand Middle School Enrollment
- Increase Capture of Private School and Out-of-District Students
- Decrease Westside/Eastside Student Movement
- Efficient Use and Good Stewardship of Community Dollars



LPA

ORANGE UNIFIED SCHOOL DISTRICT GRADUATE PROFILE

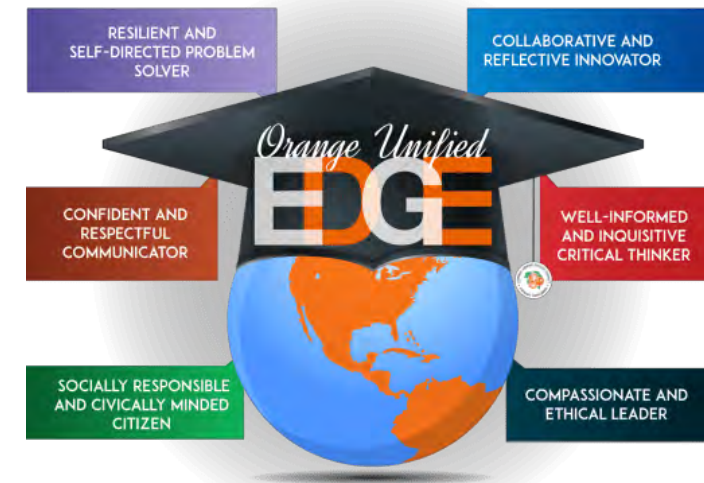

INSPIRING OUR LEARNERS OF TODAY TO BE PURPOSEFUL LEADERS OF TOMORROW
INTEGRITY • EQUITY • RESPECT • EXCELLENCE

WE EMBRACE A CULTURE OF ETHICAL AND TRANSPARENT DECISION MAKING AND ACTIONS.
WE PROMOTE INCLUSIVE AND CULTURALLY RELEVANT ENVIRONMENTS BY SUPPORTING THE SOCIAL-EMOTIONAL AND INTELLECTUAL NEEDS OF ALL.
WE ADVOCATE FOR STRONG, COMPASSIONATE RELATIONSHIPS THAT APPRECIATE THE UNIQUE QUALITIES OF OUR DIVERSE COMMUNITY.
WE STRIVE FOR THE HIGHEST STANDARDS IN ALL ENDEAVORS BY DELIBERATELY PURSUING CONTINUOUS GROWTH AND INNOVATION.

WWW.ORANGEUSD.ORG

Planning Assumptions



Equity and Choice:

Magnet Campuses
Academy Campuses

Program focus which draws District-Wide
Program focus which draw from within Feeder Community Boundary

Improvement Tiers:

Tier 1
Tier 2
Tier 3

Magnets and Academies
Targeted Enhancements
Modernization

Target Enrollments:

Elementary Schools	420 students	<i>2 classroom per grade</i>
	630 students	<i>3 classrooms per grade</i>
K-8 Schools	900 students	
Middle Schools	700 or 900 students	

Site Tiers Categorization



LPA

Tiers DO...

- Translate OUSD innovative sites vision into proposals at the various campuses.
- Organize sites into groupings by similar scope, program and master plan approach.
- Develop a unique plan for each campus based upon program and past improvement history.
- Recognize that funding for facilities improvements is not unlimited and that the District's culture of sharing will continue.

Tiers do NOT...

- Infer a striation of projects based on priority or level of improvement specified.
- Identify a date for potential improvements to begin once funding has been secured.
- Dictate the approach to scope or budget differently between the various Tiers.
- Create a standard improvement template but instead promote choice and variety within each feeder community.

OUSD Mission Statement:

*"In partnership with our community, we will provide a safe, equitable, and innovative culture of learning for each scholar to have a competitive **EDGE** as a leader."*

FACILITIES MASTER PLAN
VIRTUAL TOWN HALL MEETING: ANAHEIM HILLS AREA SCHOOLS
 JANUARY 12, 2021, 6:00-7:30 PM
 WWW.ORANGEUSD.ORG/FMP/CHS

EL BACHO CHARTER	ANAHEIM HILLS ELEMENTARY	CANYON RIM ELEMENTARY	CANYON HILLS SCHOOL
el rancho coyotes	ANES PANTHERS	CANYON RIM ELEMENTARY	Paw prints
CRESCENT ELEMENTARY	IMPERIAL ELEMENTARY	RUNNING SPRINGS ELEMENTARY	ORANGE PRE-K SOC
CRUISE CHALLENGER	IMPERIAL	Running Springs	Owl

FACILITIES MASTER PLAN
VIRTUAL TOWN HALL MEETING: CENTRAL & WEST ORANGE
 JANUARY 14, 2021, 6:00-7:30 PM
 WWW.ORANGEUSD.ORG/FMP/OHS

RICHLAND CONTINUATION	PORTOLA 6-8 MIDDLE	YORBA 6-8 MIDDLE	CAMBRIDGE ELEMENTARY	CALIFORNIA K-5
RICHLAND CONDORS	Portola	YORBA MIDDLE	CAMBRIDGE	California
FAIRHAVEN ELEMENTARY	HANDY ELEMENTARY	LAMPSON K-5	PALMYRA ELEMENTARY	SYCAMORE ELEMENTARY
Fairhaven	Handy	Lampson	Palmyra	Sycamore
			WEST ORANGE K-5	



FACILITIES MASTER PLAN
VIRTUAL TOWN HALL MEETING: EAST ORANGE AREA SCHOOLS
 JANUARY 13, 2021, 6:00-7:30 PM
 WWW.ORANGEUSD.ORG/FMP/EMHS

PARKSIDE EDUCATION CENTER	SANTIAGO CHARTER MIDDLE	MCPHERSON K-8 MAGNET	CHAPMAN HILLS ELEMENTARY	ESPLANADE ELEMENTARY
TITANS	SANTO CHARTER	MCPHERSON	CHAPMAN	ESPLANADE
JORDAN ACADEMY	LA VETA ELEMENTARY	LINDA VISTA ELEMENTARY	PANORAMA ELEMENTARY	PROSPECT STRONG
Jordan	La Veta	Linda Vista	Panorama	Prospect Strong

FACILITIES MASTER PLAN
VIRTUAL TOWN HALL MEETING: NORTH ORANGE & VILLA PARK
 RESCHEDULED FOR JANUARY 25
 JANUARY 25, 2021, 6:00-7:30 PM
 WWW.ORANGEUSD.ORG/FMP/VPHS

CERRO VILLA MIDDLE SCHOOL	FLETCHER ELEMENTARY	NOHL CANYON ELEMENTARY
Cerro Villa	Fletcher	Nohl Canyon
OLIVE ELEMENTARY	SERRANO ELEMENTARY	TAFT ELEMENTARY
Olive	Serrano	Taft
		VILLA PARK ELEMENTARY

Villa Park High School Feeder Area

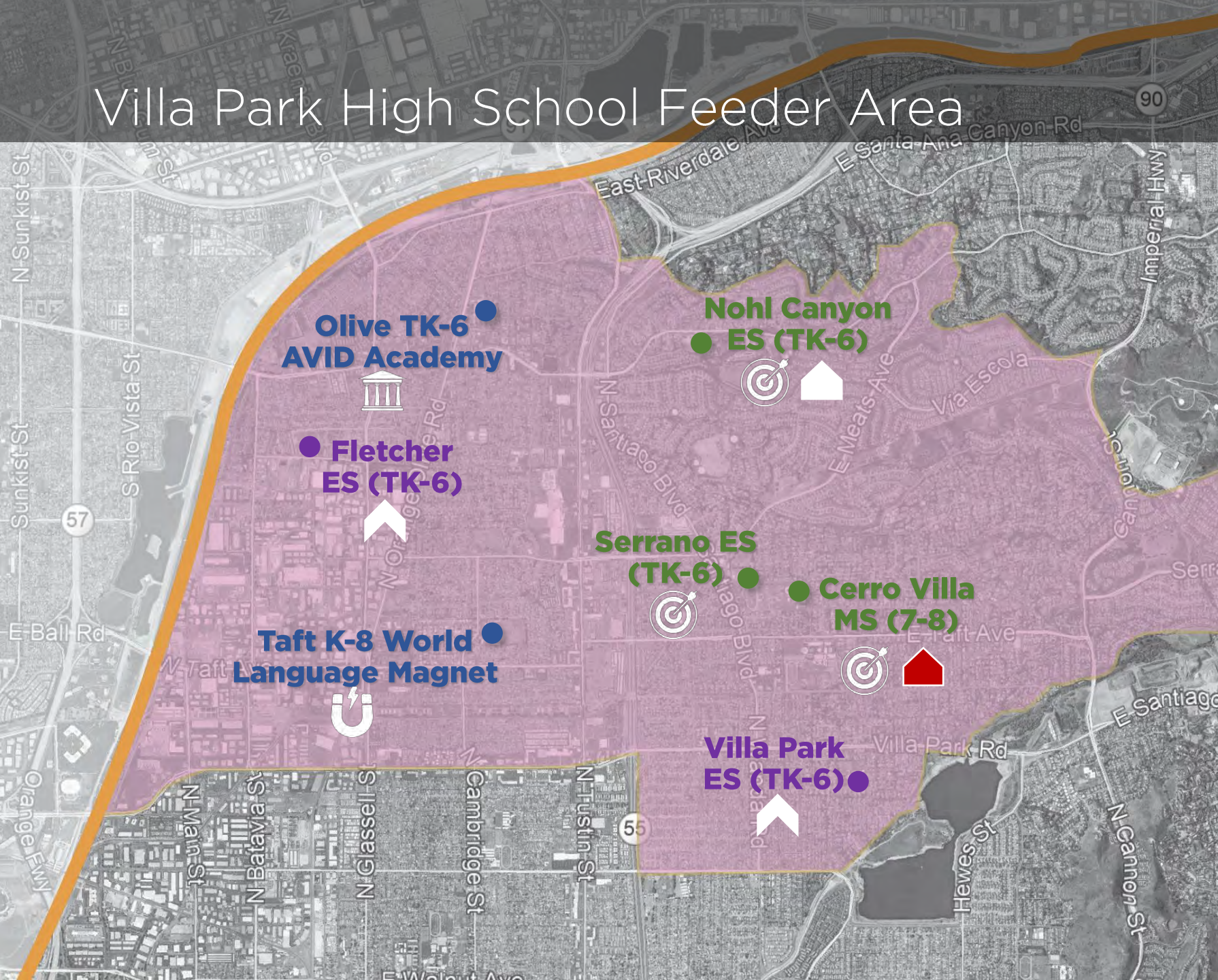

Tier 1 Magnets



Tier 1 Academies



Tier 2 Targeted Enhancements :

- All Sites: Modernization
- Nohl Canyon
 - Additional Capacity
 - Library Takes Over MPR
 - New MPR
 - After School Space
 - Address Walls and Acoustics

Serrano ES (K-6)

- Share MPR with Cerro Villa MS
- After School Space

Cerro Villa MS (6-8)

- New Gym/MPR to Share with Serrano ES



New GYM for Feeder Area



Tier 3 Modernization

Jump To Ed Specs

Villa Park High School Feeder Pattern

Olive TK-6 AVID Academy

- Olive Elementary will continue to have its current attendance boundary and would also continue to house the current grade levels (TK-6th).
- Continue to build strong college relationships to infuse the college going culture. Students have access to a career/college lab. Students also have the opportunity to take multiple field trips to colleges throughout the year.
- Strong AVID continuum built from Olive, to Cerro Villa and then on to Villa Park High School
- College tutors participating in classroom activities three times per week
- Olive Elementary will continue to be designated as an AVID National Demonstration School



Villa Park High School Feeder Pattern



Taft K-8 World Languages Magnet

- Pull Taft out of the current attendance boundaries (current elementary school students would split between existing school sites). Fill Taft to capacity: three classes of each grade level K-5th and 300 6th-8th grade students. Students accepted to Taft based on lottery system.
- Fletcher's Golden Bell Award winning 50:50 Mandarin Immersion program (two cohorts per grade level) to be housed here K-8th grade with middle school students taking a language and CTE Mandarin class (continuum built through 12th grade)
- An additional immersion program to be added (Portuguese, Latin, etc) to be built starting from kindergarten
- Cultural events to bring in the community around the language focus for example The Lunar New Year and possibly Portuguese Independence Day
- All subject matter taught through the World Languages Magnet Focus



Canyon High School Feeder Area

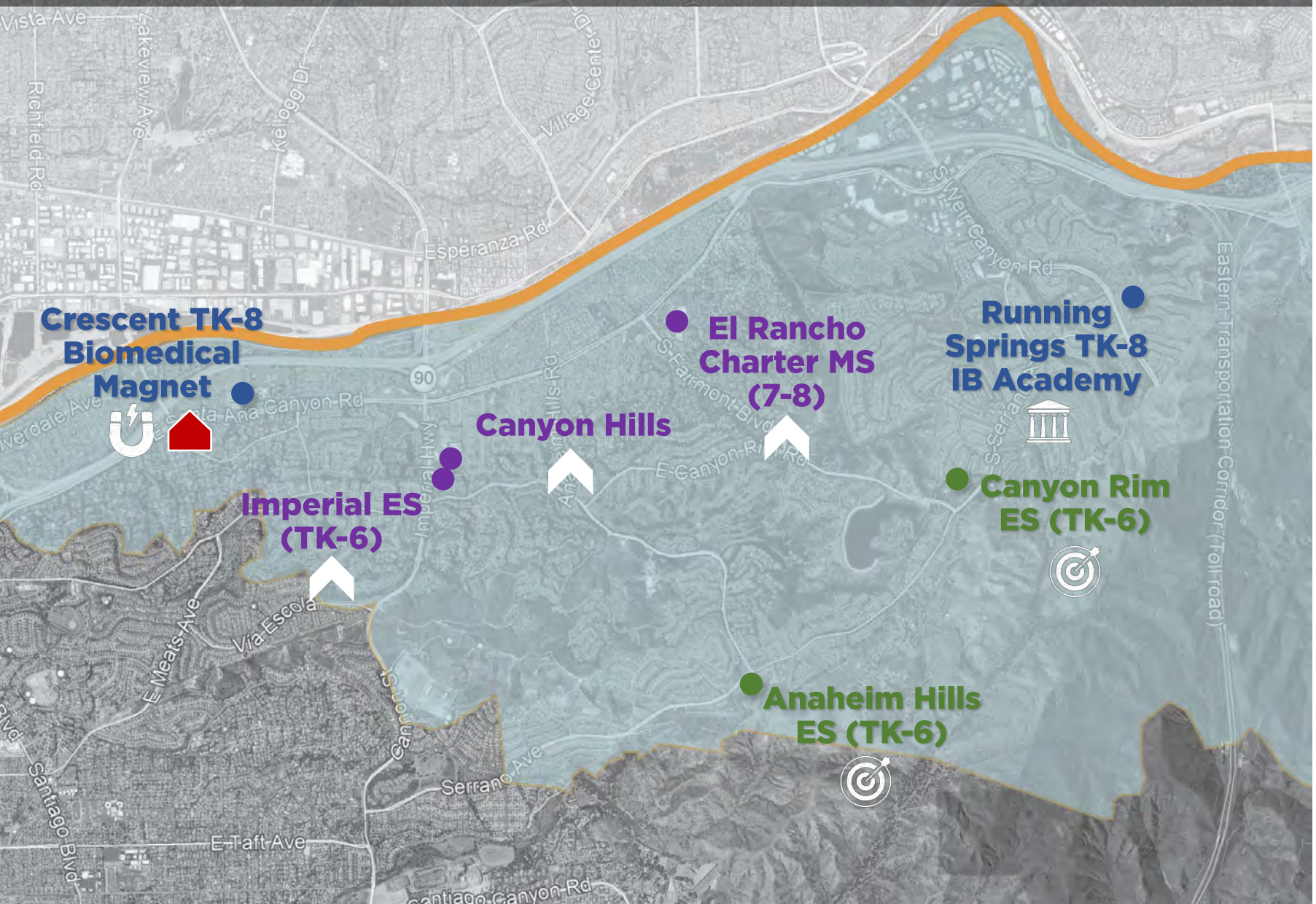

Tier 1 Magnets



Tier 1 Academies



Tier 2 Targeted Enhancements

- All Sites: Modernization
- Anaheim Hills ES (TK-6)
- Address Walls and Acoustics
- Canyon Rim ES (TK-6)
- Additional Capacity



New Gym for Feeder Area



Tier 3 Modernization

El Modena High School Feeder Area

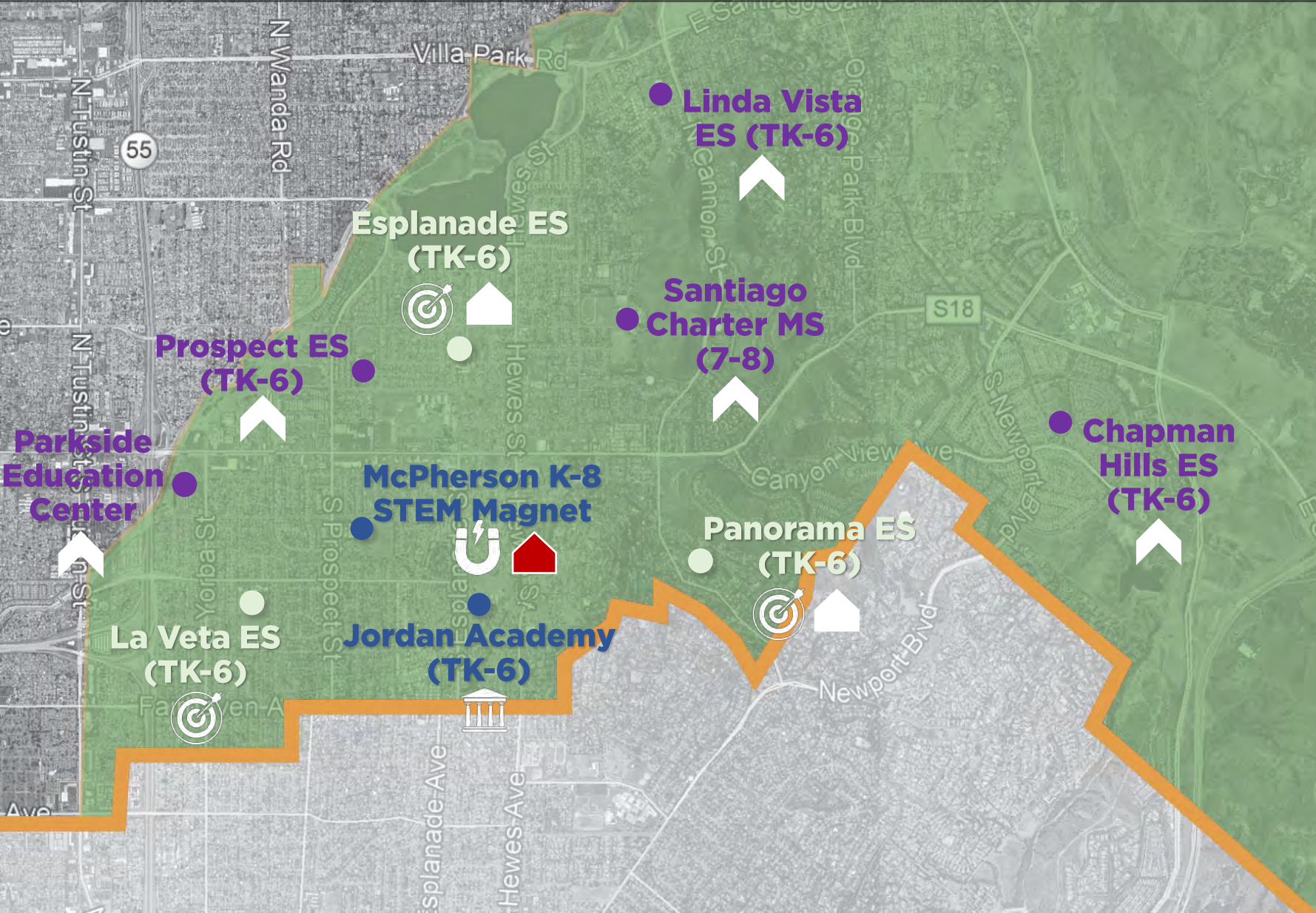

Tier 1 Magnets



Tier 1 Academies



Tier 2 Targeted Enhancements

- All Sites: Modernization
- Esplanade ES (TK-6)
 - Expand Admin, Library, LRC
 - New MPR
 - PK/After School Spaces

La Veta ES (TK-6)

- Shared MPR with McPherson

Panorama ES (TK-6)

- Rebuild as a New, Multi-Story Campus
- New Library & MPR



New Gym for Feeder Area



Tier 3 Modernization

Jump To Orange Feeder

Orange High School Feeder Area



Tier 1 Magnets



Tier 1 Academies



Tier 2 Targeted Enhancements

- All Sites: Modernization
- Cambridge ES (TK-6)
- New MPR
- PK/After School Spaces

Fairhaven ES (TK-6)

- New Library
- New MPR
- PK/After School Spaces

Richland Continuation HS

- New Gym (possibly shared)

Sycamore ES (TK-6)

- Expand Admin
- Expand Library
- PK/After School Spaces



New GYM for Feeder Area



Tier 3 Modernization

Jump To Villa Park Feeder



LPA



Planning for the Future & Education Specifications

Planning for the Future



LPA

Preschool

- ELC (OUSD program) will be planned with permanent classrooms

Transitional Kindergarten

- Every Elementary and K-8 Site will be planned with (1) TK classroom
- Elementary Schools with a higher projected enrollment will get (2) TK classrooms

Educational Specification Diagram a model to guide future site improvements

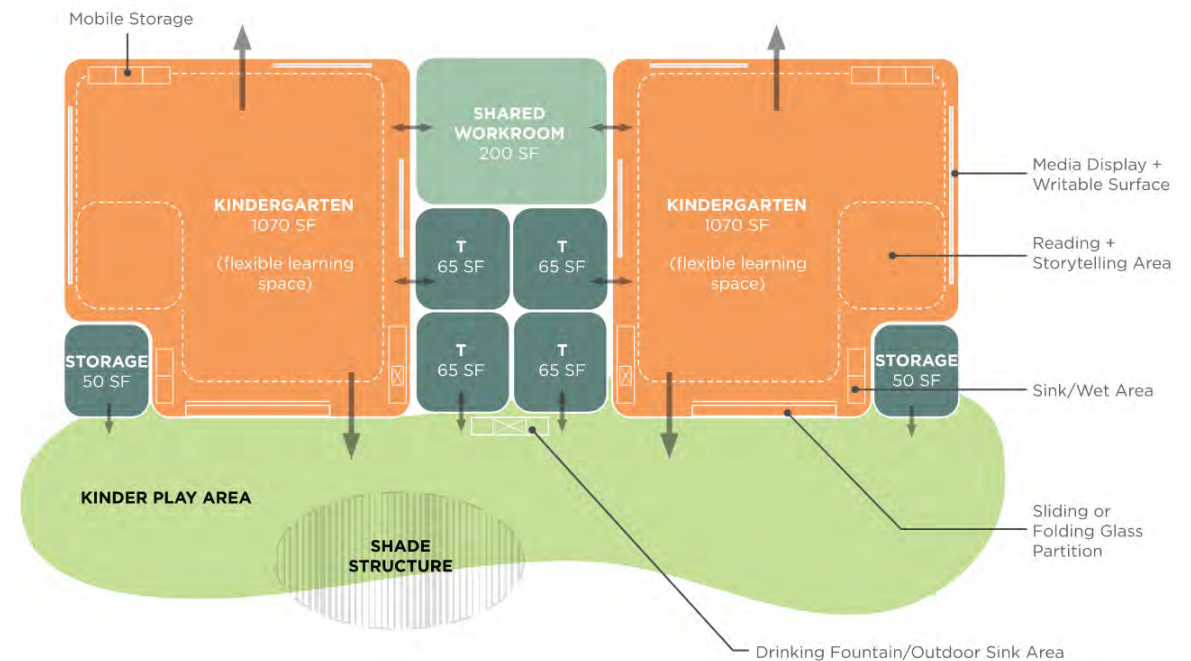

Planning for the Future



LPA

Special Education

- Plan for inclusion model → allows students to matriculate at the same school site
- Aligns with the Strategic Plan → 'Living our Values'
- Every campus regardless of current SDC needs will have a dedicated toilet facility with a lift for future flexibility

Educational Specification Diagram
a model to guide future site improvements

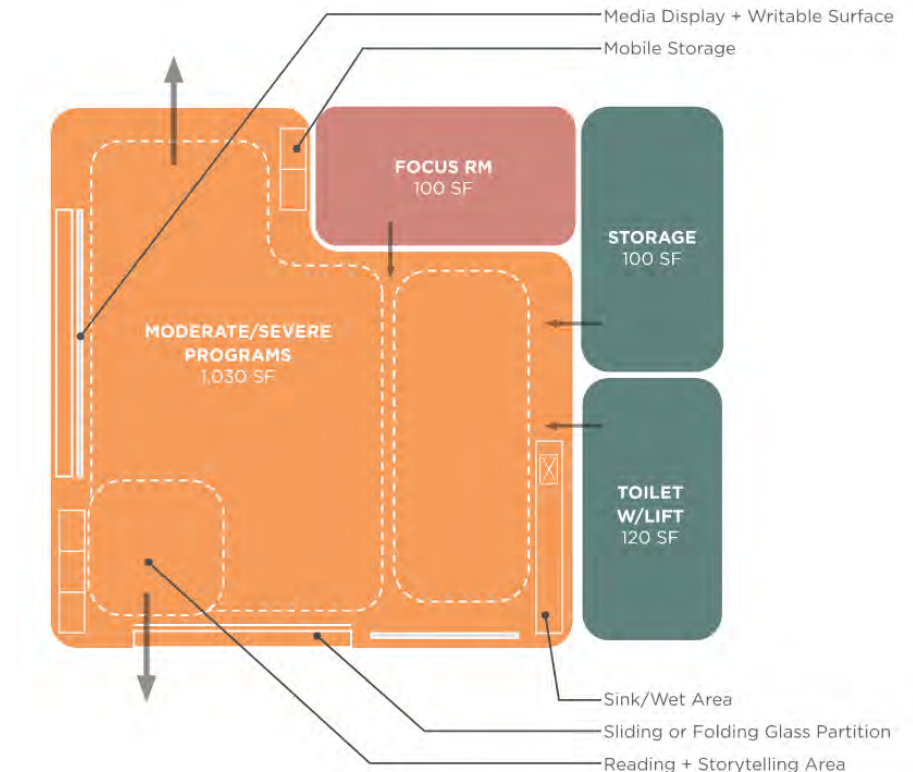

Planning for the Future



LPA

Learning Resource Center

- Learning Resource Center Model → includes space for RSP and a Flex Classroom to accommodate future flexibility
- Serves as a 'suite of offices' with shared common space to provide student services with a purpose-built home

*Educational Specification Diagram
a model to guide future site improvements*

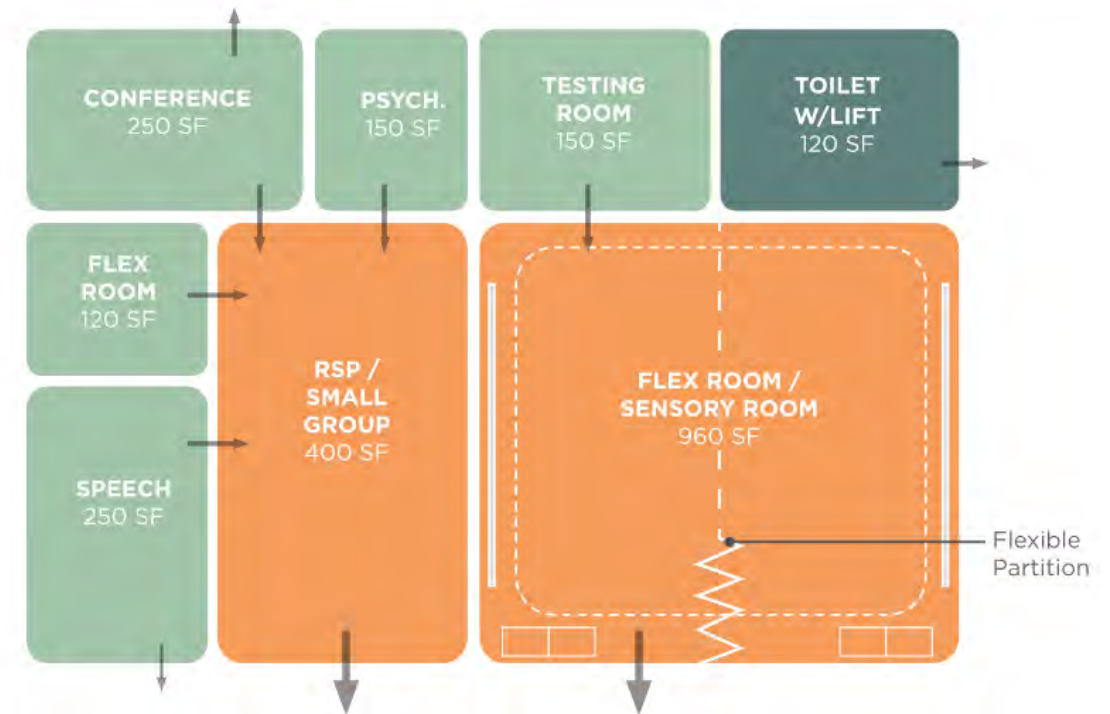

Planning for the Future



LPA

Media Center

- Evolving the Library into a multi-media hub of activity
- Host concurrent activities of varying noise levels:
 - Large group zone for an entire class
 - Reading and storytelling nook
 - Research and tech zone

Educational Specification Diagram
a model to guide future site improvements

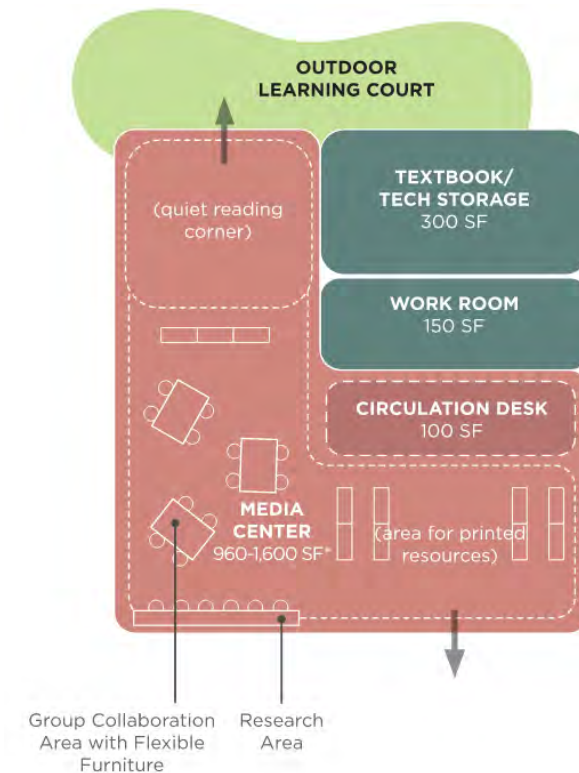

Planning for the Future



LPA

Collaboration Spaces

- Indoor or Outdoor spaces adjacent to classrooms serve as extensions of the classroom
- Highly flexible in nature, spaces can shift to accommodate small groups, large groups, and individual activities
- Visual connections from the classroom to the colabs eases supervision and promotes use of the space
- Promotes interdisciplinary, learner-centered instruction

Educational Specification Diagram a model to guide future site improvements

COLAB SPACE (A):

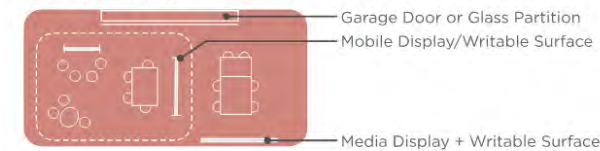

COLAB SPACE (B):



OUTDOOR LEARNING COURT
200 SF min.
to available outdoor space

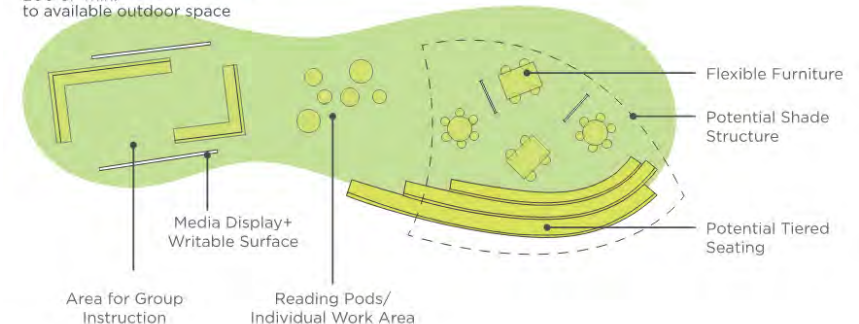

Planning for the Future



LPA

VAPA: Visual and Performing Arts / Elementary and K-8 Schools

- Set of spaces adjacent to the MPR to support performances

*Educational Specification Diagrams
a model to guide future site improvements*

Elementary Schools

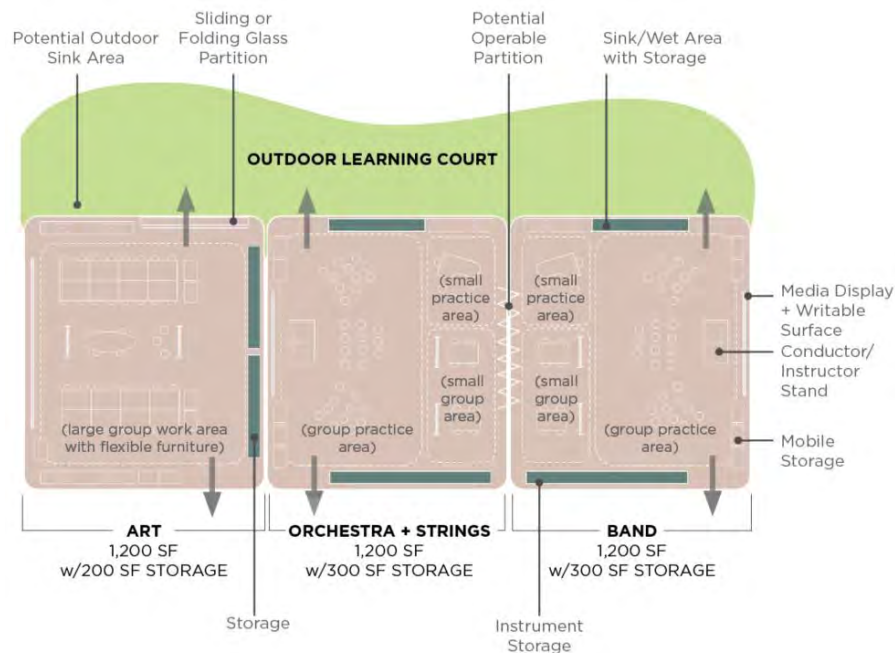

K-8 Schools

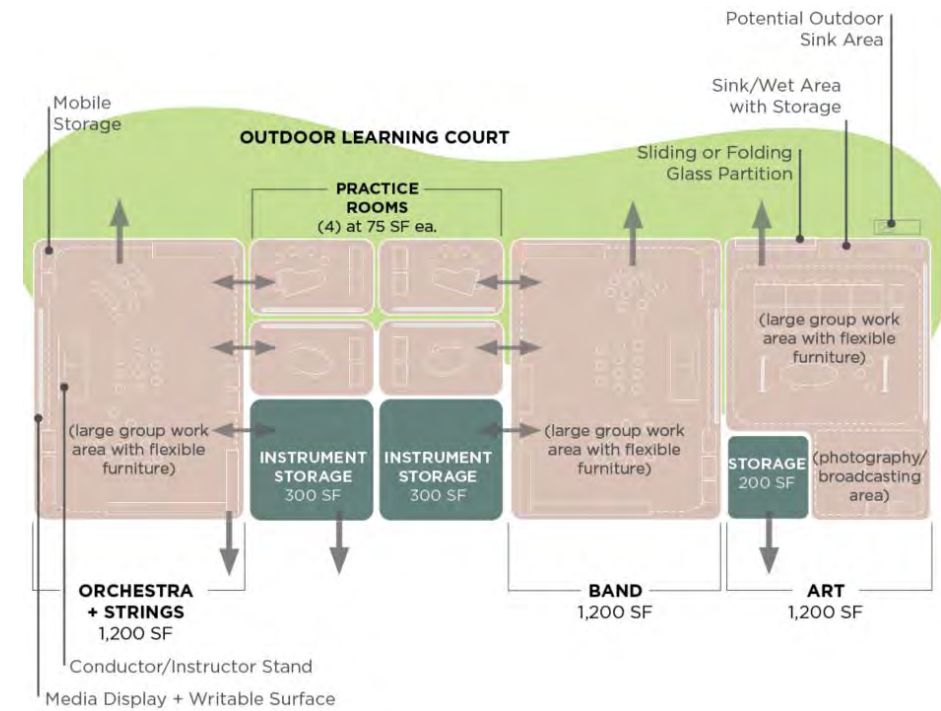

Planning for the Future



LPA

VAPA: Visual and Performing Arts / Middle Schools

- Variations of large electives to support unique program offerings

*Educational Specification Diagrams
a model to guide future site improvements*

2D, 3D & Digital Arts Focus

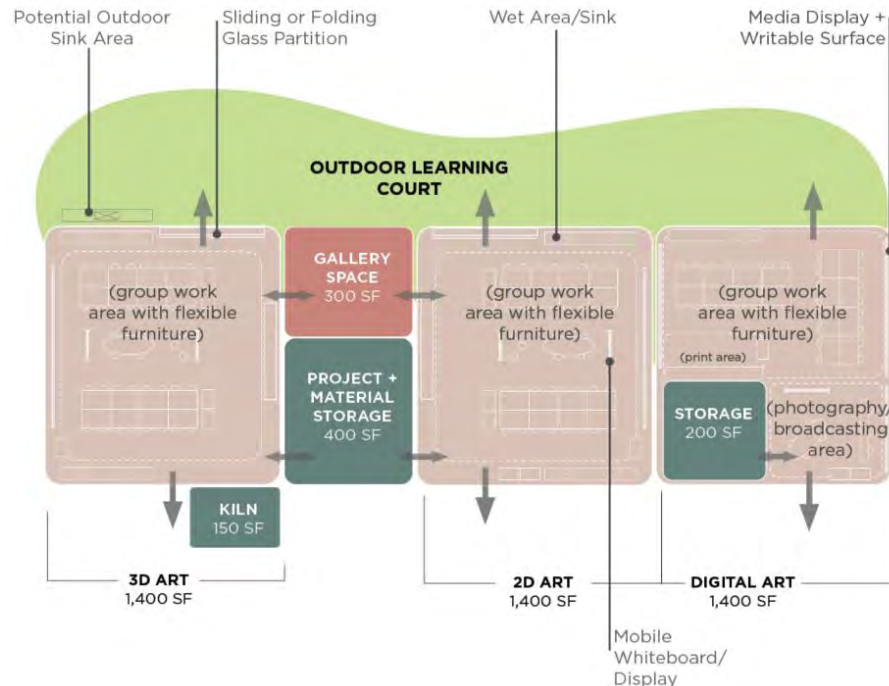

Music & Drama Focus

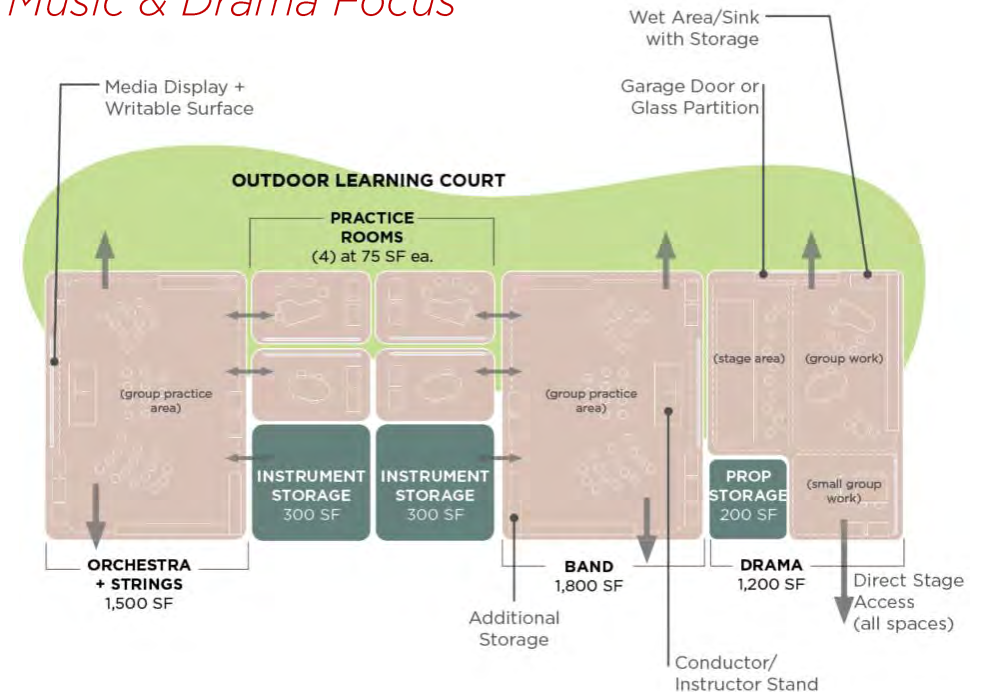

Planning for the Future



LPA

Innovation Lab

- For exploratory, hands-on, and project-based learning
- Pair with the After School 'home base' for enrichment programs when possible

*Educational Specification Diagram
a model to guide future site improvements*

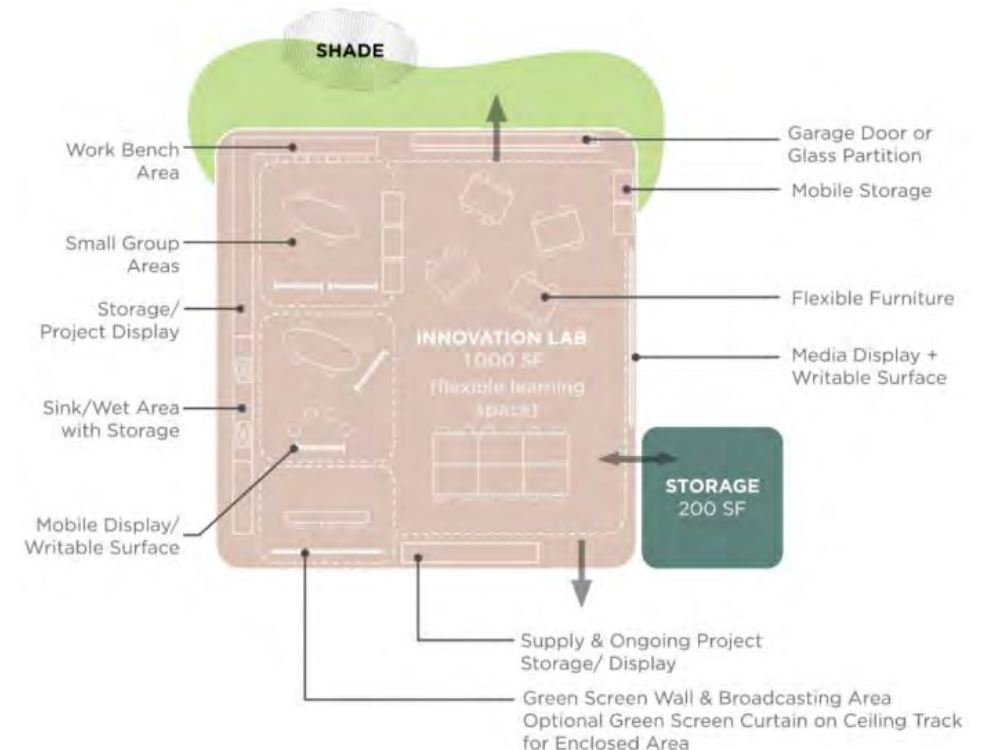

Planning for the Future



LPA

After School Programs

- Provide one dedicated 1,200sf 'home base' classroom near parking
- Share additional classrooms after school to accommodate the number of students
- Collocate the 'home base' classroom with the Innovation Lab when possible
- Access to restrooms are needed in addition to phone systems to be self-sustaining
- (4) campuses (1 per feeder area) will serve as the CARES Camp Hub for that region

Educational Specification Diagram a model to guide future site improvements

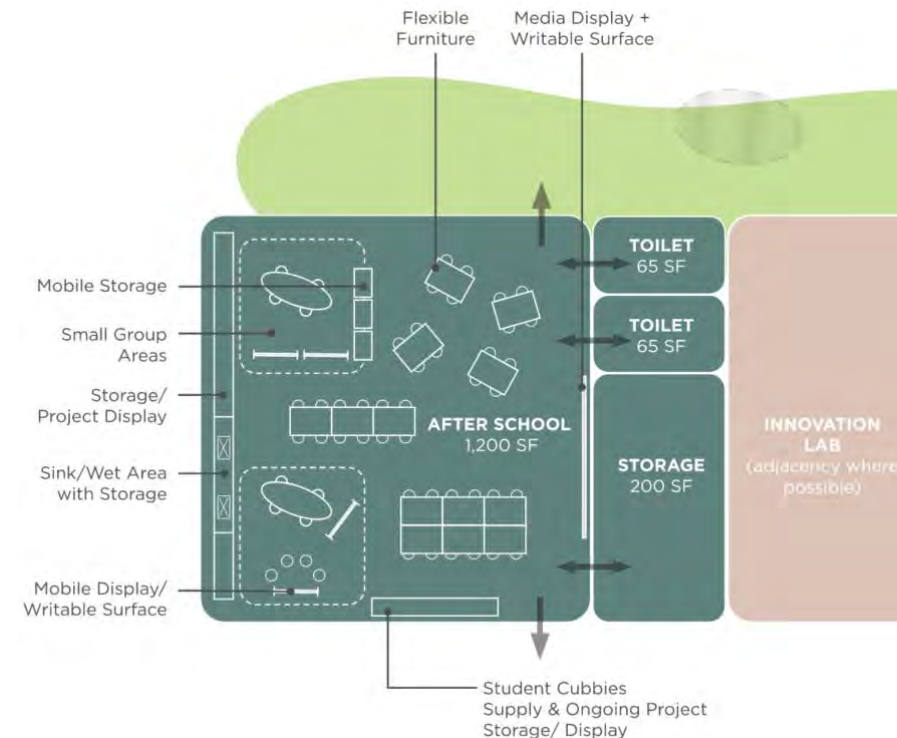



LPA

Q&A

- Use the Questions function in your GoTo Webinar dashboard, or
- Submit a question or comment to the Facilities & Planning Department:
 - Visit the Facilities & Planning website at OrangeUSD.org/departments/facilities-planning
 - Use the QR code below





Draft School Site Opportunities Diagrams

Next Steps: How Can You Participate?



LPA

- Engage with School Site Committee (contact your site Principal)
- Express Your Opinion on the DRAFT Master Plan Diagram
- Think Long-Term





School Site Committee: Role

- Review the DRAFT Master Plan Diagrams with School Site Committees and other community members (we'll kick this off in just a moment).
- Solicit input on the DRAFT diagrams from your stakeholders between now and mid-February.
- Use the follow-up questionnaire provided to Principals to help guide conversations.
- Principals will meet 1-on-1 with LPA to convey the feedback gathered.



School Site Committee: Materials

- Printed Existing and Proposed Plans
- Questionnaire
- Site Needs Assessment
- Education Specifications
- Town Hall Meeting Recordings Pertinent to Site (loaded to FMP website)

Interpreting the Diagrams



Key



MODERNIZATION

update finishes (flooring, walls, ceilings, lighting, etc)



RECONFIGURE

rearrange walls/spaces to align with ed specs



NEW CONSTRUCTION

new, stick-built construction



Big Planning Themes

- Build from the District's EDGE Strategic Plan Vision (2018).
- Implement the FMP Educational Program Specifications.
- Follow State "School Facility Program" Square Footage Standards.
- Co-locate Kindergarten/PK/TK in Appropriately Designed Spaces with Dedicated Play Area.
- Incorporate Interior and Exterior Environments for Collaboration.
- Inclusion Model for Special Education and Pre-K Programs.
- Parking / Drop-Off Configurations for Capacity and Flow.
- Safety / Security, Administration as the Front Door.

FLETCHER ELEMENTARY
EXISTING SITE PLAN

Orange Unified School District
Facilities Master Plan



- Classrooms, CR
 - PK Preschool
 - TK Transitional Kindergarten
 - K Kindergarten
 - CR Classroom (Grade Level)
 - SDC Special Day Class
 - OT/PT Occupational Therapy/Physical Therapy
 - VAC Vacant

- Specialty Spaces
 - COMP Computer Lab
 - STEAM Science/Tech/Engineering/Art/Math
 - VAPA Visual Arts/Performing Arts

- Shared Spaces
 - MPR Multi-Purpose Room
 - LIB Library

- Admin / Faculty
 - FW Faculty Work
 - FL Faculty Lounge
 - WR Workroom
 - O Office
 - N Nurse
 - PSY Psychologist
 - SPCH Speech
 - IS Instructional Support
 - CONF Conference Room
 - COUN Counselor
 - PTA Parent Teacher Association

- Support Spaces
 - CARES Expanded Learning Program
 - ASES After School Education & Safety
 - S Storage
 - T Toilet
 - U Utility
 - C Custodial
 - KIT Kitchen

Portable Classroom

★ Main Entry

→ Drop Off

Existing Enrollment:		451
Teaching Stations:		
Preschool, PK		0
Transitional Kinder, TK		1
Kindergarten, K		3
1 st -3 rd Grade		8
4 th -6 th Grade		8
STEAM Lab		1
VAPA		0
Computer Lab		0
SDC		0
RSP		1
Other (1-Spch/Wkrm, 1-PTA, 1-CARES)		3
Grand Total:		25

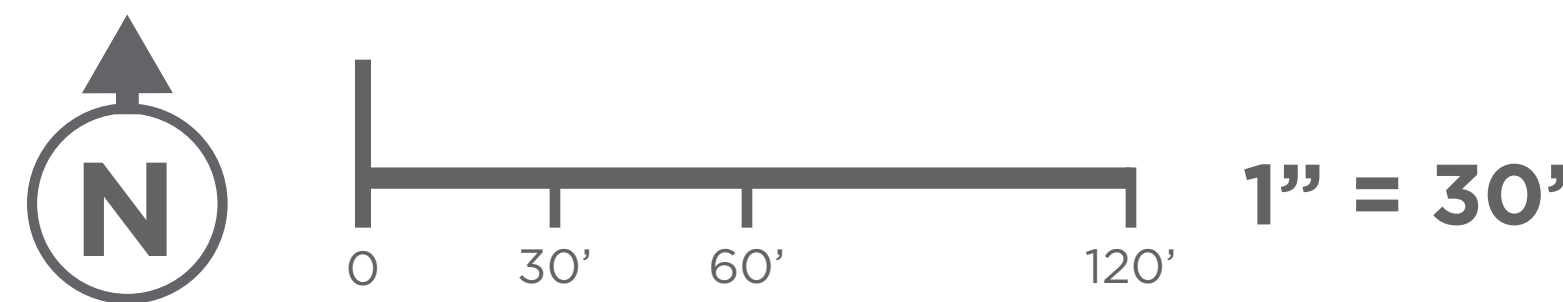

DRAFT DRAFT DRAFT DRAFT DRAFT DRAFT DRAFT DRAFT

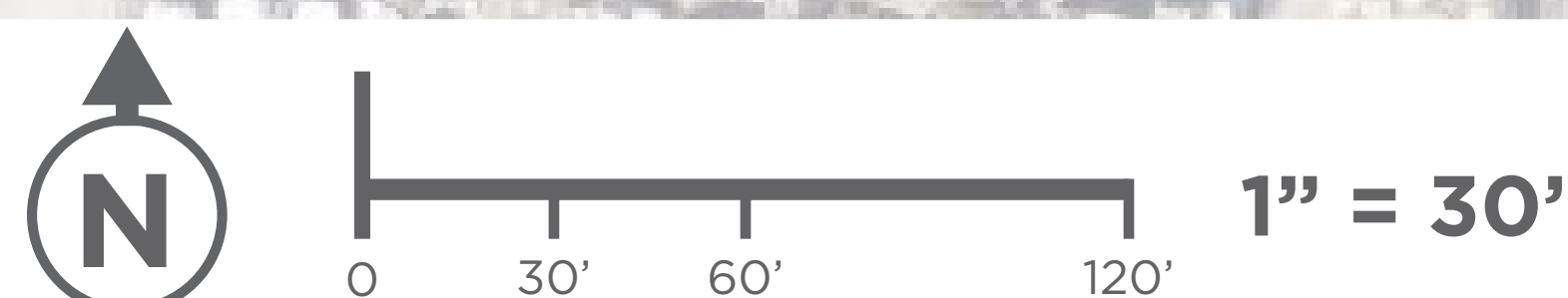

MODERNIZATION
RECONFIGURE
NEW CONSTRUCTION

Classrooms, CR
PK Preschool
TK Transitional Kindergarten
K Kindergarten
Classroom (Grade Level)
SDC Special Day Class

Specialty Spaces
IL Innovation Lab
VAPA Visual Arts/Performing Arts

Shared Spaces
MPR Multi-Purpose Room
LIB Library
LC Learning Center

Admin / Faculty
FW Faculty Work
FL Faculty Lounge
N Nurse
CONF Conference Room

Support Spaces
AS After School
S Storage
T Toilet
U Utility
C Custodial
KIT Kitchen
SERV Serving

No Work Required
Portable Classrooms

Main Entry
Drop-Off
Fence

Kinder Play
Play Apparatus
Learning Court Quad/Playfield
Hardcourts

Proposed Enrollment: 420	
Teaching Stations:	
Preschool, PK	1
Transitional Kinder, TK	1
Kindergarten, K	2
1 st -3 rd Grade	6
4 th -6 th Grade	6
Innovation Lab	1
VAPA	3
SDC Preschool	0
SDC	0
Other (1-After School)	1
Grand Total:	21

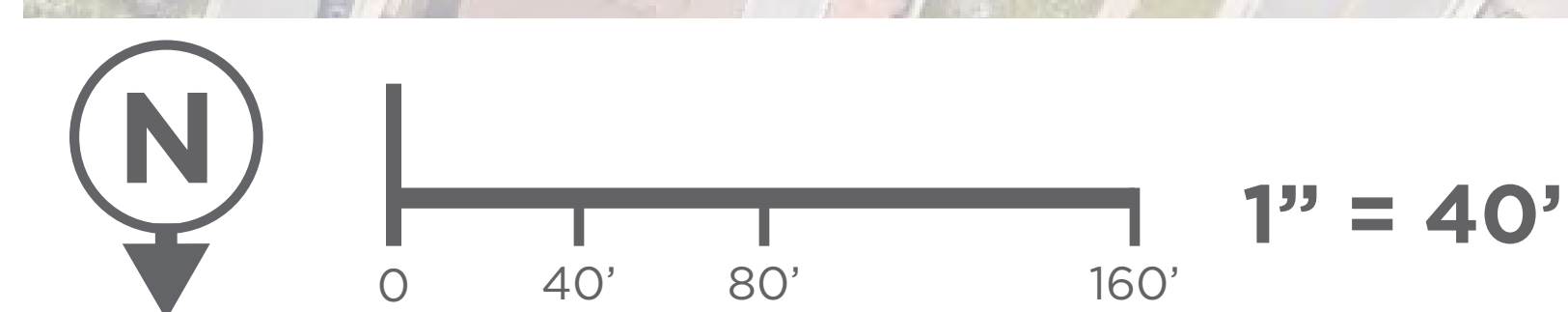

- | Existing Enrollment: | | 531 |
|--|--|-------------|
| Teaching Stations: | | |
| Preschool, PK | | 0 |
| Transitional Kinder, TK | | 0 |
| Kindergarten, K | | 4 |
| 1 st -3 rd Grade | | 8 |
| 4 th -6 th Grade | | 9 |
| STEAM Lab | | 0 |
| VAPA | | 0 |
| Computer Lab | | 1 |
| SDC | | 0 |
| RSP | | 1 |
| Other (0.5-Spch, 3-CARES) | | 3.5 |
| Grand Total: | | 26.5 |

DRAFT DRAFT DRAFT DRAFT DRAFT DRAFT DRAFT DRAFT



MODERNIZATION

RECONFIGURE

NEW CONSTRUCTION

Classrooms, CR

PK Preschool

TK Transitional Kindergarten

K Kindergarten

Classroom (Grade Level)

SDC Special Day Class

Specialty Spaces

IL Innovation Lab

VAPA Visual Arts/Performing Arts

Shared Spaces

MPR Multi-Purpose Room

LIB Library

LC Learning Center

Admin / Faculty

FW Faculty Work

FL Faculty Lounge

N Nurse

CONF Conference Room

Support Spaces

AS After School

S Storage

T Toilet

U Utility

C Custodial

KIT Kitchen

SERV Serving

No Work Required

Portable Classrooms

Main Entry

Drop-Off

Fence

Kinder Play

Play Apparatus

Learning Court Quad/Playfield

Hardcourts

Proposed Enrollment: 630	
Teaching Stations:	
Preschool, PK	0
Transitional Kinder, TK	2
Kindergarten, K	3
1 st -3 rd Grade	9
4 th -6 th Grade	9
Innovation Lab	1
VAPA	3
SDC Preschool	0
SDC	0
Other (1-After School)	1
Grand Total:	28

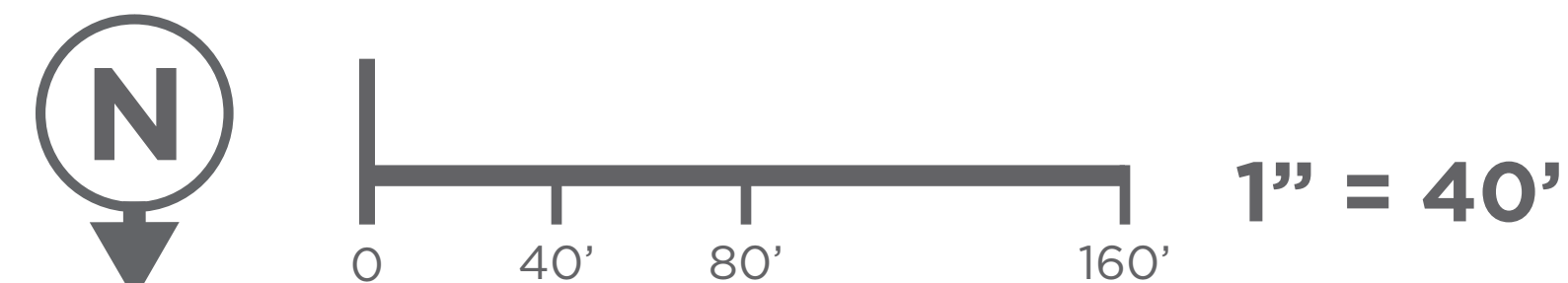

OLIVE ELEMENTARY
EXISTING SITE PLAN

Orange Unified School District
Facilities Master Plan



- Classrooms, CR
 - PK Preschool
 - TK Transitional Kindergarten
 - K Kindergarten
 - CR Classroom (Grade Level)
 - SDC Special Day Class
 - OT/PT Occupational Therapy/Physical Therapy
 - VAC Vacant

- Specialty Spaces
 - COMP Computer Lab
 - STEAM Science/Tech/Engineering/Art/Math
 - VAPA Visual Arts/Performing Arts

- Shared Spaces
 - MPR Multi-Purpose Room
 - LIB Library

- Admin / Faculty
 - FW Faculty Work
 - FL Faculty Lounge
 - WR Workroom
 - O Office
 - N Nurse
 - PSY Psychologist
 - SPCH Speech
 - IS Instructional Support
 - CONF Conference Room
 - COUN Counselor
 - PTA Parent Teacher Association

- Support Spaces
 - CARES Expanded Learning Program
 - ASES After School Education & Safety
 - S Storage
 - T Toilet
 - U Utility
 - C Custodial
 - KIT Kitchen

Portable Classroom

Main Entry

Drop Off

Existing Enrollment:	420
Teaching Stations:	
Preschool, PK	1
Transitional Kinder, TK	1
Kindergarten, K	2
1 st -3 rd Grade	5
4 th -6 th Grade	5
STEAM Lab	1
VAPA	1
Computer Lab	0.5
SDC	3
RSP	1
Other (1-Psych, 1-Instruct Spec/Spch, 1-Nurse)	3
Grand Total:	23.5



DRAFT DRAFT DRAFT DRAFT DRAFT DRAFT DRAFT DRAFT

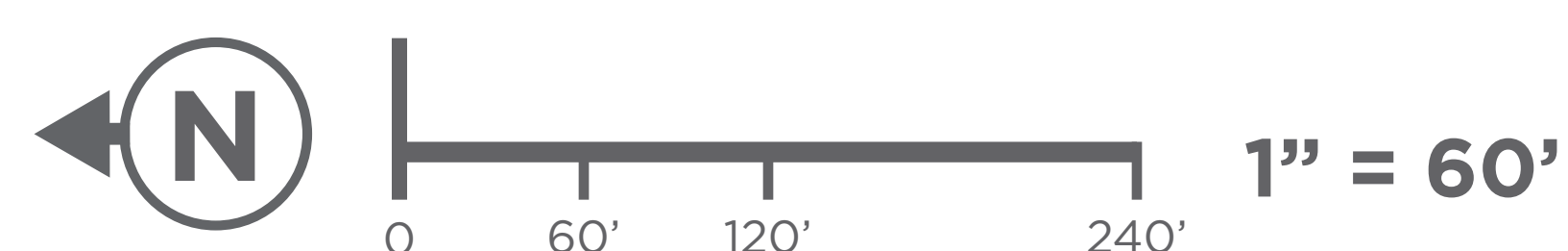

MODERNIZATION

RECONFIGURE

NEW CONSTRUCTION

Classrooms, CR

PK Preschool

TK Transitional Kindergarten

K Kindergarten

Classroom (Grade Level)

SDC Special Day Class

Specialty Spaces

IL Innovation Lab

VAPA Visual Arts/Performing Arts

Shared Spaces

MPR Multi-Purpose Room

LIB Library

LC Learning Center

Admin / Faculty

FW Faculty Work

FL Faculty Lounge

N Nurse

CONF Conference Room

Support Spaces

AS After School

S Storage

T Toilet

U Utility

C Custodial

KIT Kitchen

SERV Serving

No Work Required

Portables Classrooms

Main Entry

Drop-Off

Fence

Kinder Play

Play Apparatus

Learning Court Quad/Playfield

Hardcourts

Existing Enrollment:	420
Teaching Stations:	
Preschool, PK	1
Transitional Kinder, TK	1
Kindergarten, K	2
1 st -3 rd Grade	5
4 th -6 th Grade	5
Innovation Lab	1
VAPA	1
SDC Preschool	0.5
SDC	3
Other	1
(1-Psych, 1-Instruct Spec/Spch, 1-Nurse)	3
Grand Total:	23.5



DRAFT DRAFT DRAFT DRAFT DRAFT DRAFT DRAFT DRAFT



MODERNIZATION

RECONFIGURE

NEW CONSTRUCTION

Classrooms, CR

PK Preschool

TK Transitional Kindergarten

K Kindergarten

Classroom (Grade Level)

SDC Special Day Class

Specialty Spaces

IL Innovation Lab

VAPA Visual Arts/Performing Arts

Shared Spaces

MPR Multi-Purpose Room

LIB Library

LC Learning Center

Admin / Faculty

FW Faculty Work

FL Faculty Lounge

N Nurse

CONF Conference Room

Support Spaces

AS After School

S Storage

T Toilet

U Utility

C Custodial

KIT Kitchen

SERV Serving

⊗ No Work Required

⊞ Portable Classrooms

★ Main Entry

→ Drop-Off

— Fence

Kinder Play

Play Apparatus

Learning Court Quad/Playfield

Hardcourts

Proposed Enrollment: 630	
Teaching Stations:	
Preschool, PK	1
Transitional Kinder, TK	2
Kindergarten, K	3
1 st -3 rd Grade	9
4 th -6 th Grade	9
Innovation Lab	1
VAPA	3
SDC Preschool	1
SDC	4
Other (1-CARES, 1-College Center)	2
Grand Total:	35



SERRANO ELEMENTARY
EXISTING SITE PLAN

Orange Unified School District
Facilities Master Plan



- Classrooms, CR
 - PK Preschool
 - TK Transitional Kindergarten
 - K Kindergarten
 - CR Classroom (Grade Level)
 - SDC Special Day Class
 - OT/PT Occupational Therapy/Physical Therapy
 - VAC Vacant

- Specialty Spaces
 - COMP Computer Lab
 - STEAM Science/Tech/Engineering/Art/Math
 - VAPA Visual Arts/Performing Arts

- Shared Spaces
 - MPR Multi-Purpose Room
 - LIB Library

- Admin / Faculty
 - FW Faculty Work
 - FL Faculty Lounge
 - WR Workroom
 - O Office
 - N Nurse
 - PSY Psychologist
 - SPCH Speech
 - IS Instructional Support
 - CONF Conference Room
 - COUN Counselor
 - PTA Parent Teacher Association

- Support Spaces
 - CARES Expanded Learning Program
 - ASES After School Education & Safety
 - S Storage
 - T Toilet
 - U Utility
 - C Custodial
 - KIT Kitchen

Portable Classroom

★ Main Entry

→ Drop Off

Existing Enrollment: 539

Teaching Stations:

Preschool, PK	0
Transitional Kinder, TK	1
Kindergarten, K	3
1 st -3 rd Grade	8
4 th -6 th Grade	7
STEAM Lab	1
VAPA	0
Computer Lab	1
SDC	0
RSP	1
Other (1-CARES)	1

Grand Total: 23

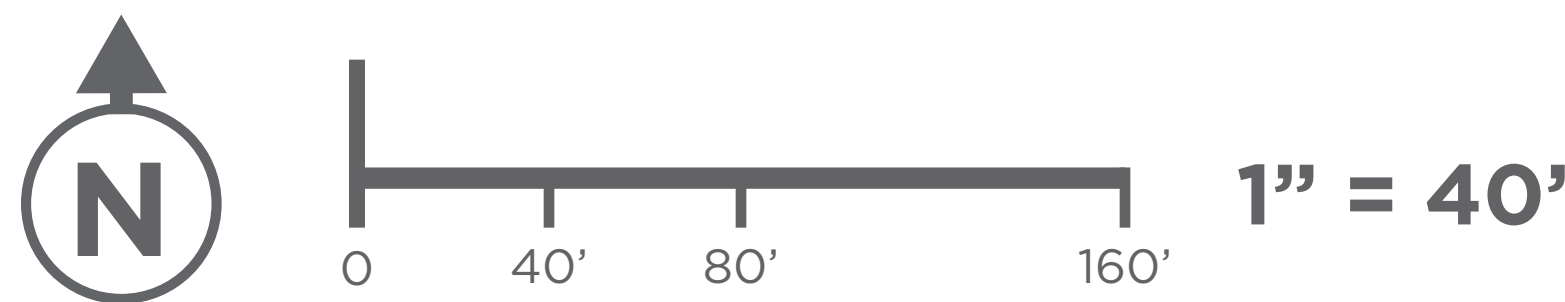

DRAFT DRAFT DRAFT DRAFT DRAFT DRAFT DRAFT DRAFT



MODERNIZATION

RECONFIGURE

NEW CONSTRUCTION

Classrooms, CR

PK Preschool

TK Transitional Kindergarten

K Kindergarten

Classroom (Grade Level)

SDC Special Day Class

Specialty Spaces

IL Innovation Lab

VAPA Visual Arts/Performing Arts

Shared Spaces

MPR Multi-Purpose Room

LIB Library

LC Learning Center

Admin / Faculty

FW Faculty Work

FL Faculty Lounge

N Nurse

CONF Conference Room

Support Spaces

AS After School

S Storage

T Toilet

U Utility

C Custodial

KIT Kitchen

SERV Serving

No Work Required

Portable Classrooms

Main Entry

Drop-Off

Fence

Kinder Play

Play Apparatus

Learning Court Quad/Playfield

Hardcourts

Proposed Enrollment:	420
Teaching Stations:	
Preschool, PK	1
Transitional Kinder, TK	1
Kindergarten, K	2
1 st -3 rd Grade	6
4 th -6 th Grade	6
Innovation Lab	1
VAPA	3
SDC Preschool	0
SDC	0
Other (1-After School)	1
Grand Total:	21

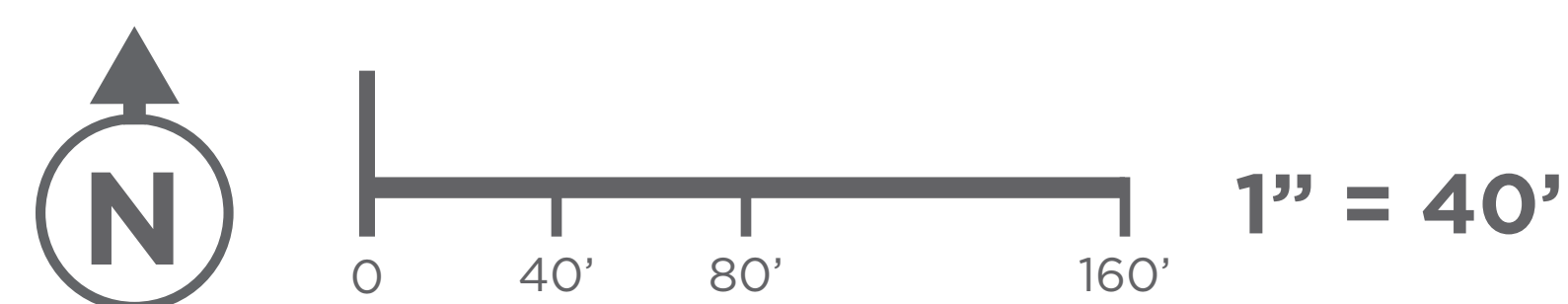

VILLA PARK ELEMENTARY
EXISTING SITE PLAN

Orange Unified School District
Facilities Master Plan



- Classrooms, CR**
- PK Preschool
 - TK Transitional Kindergarten
 - K Kindergarten
 - CR Classroom (Grade Level)
 - SDC Special Day Class
 - OT/PT Occupational Therapy/Physical Therapy
 - VAC Vacant

- Specialty Spaces**
- COMP Computer Lab
 - STEAM Science/Tech/Engineering/Art/Math
 - VAPA Visual Arts/Performing Arts

- Shared Spaces**
- MPR Multi-Purpose Room
 - LIB Library

- Admin / Faculty**
- FW Faculty Work
 - FL Faculty Lounge
 - WR Workroom
 - O Office
 - N Nurse
 - PSY Psychologist
 - SPCH Speech
 - IS Instructional Support
 - CONF Conference Room
 - COUN Counselor
 - PTA Parent Teacher Association

- Support Spaces**
- CARES Expanded Learning Program
 - ASES After School Education & Safety
 - S Storage
 - T Toilet
 - U Utility
 - C Custodial
 - KIT Kitchen

Portable Classroom

Main Entry

Drop Off

Existing Enrollment:		609
Teaching Stations:		
Preschool, PK		0
Transitional Kinder, TK		0
Kindergarten, K		3
1 st -3 rd Grade		9
4 th -6 th Grade		9
STEAM Lab		0
VAPA		0
Computer Lab		1
SDC		0
RSP		1
Other (1-Spch, 1-CARES)		2
Grand Total:		25

DRAFT DRAFT DRAFT DRAFT DRAFT DRAFT DRAFT DRAFT



MODERNIZATION

RECONFIGURE

NEW CONSTRUCTION

Classrooms, CR

PK Preschool

TK Transitional Kindergarten

K Kindergarten

Classroom (Grade Level)

SDC Special Day Class

Specialty Spaces

IL Innovation Lab

VAPA Visual Arts/Performing Arts

Shared Spaces

MPR Multi-Purpose Room

LIB Library

LC Learning Center

Admin / Faculty

FW Faculty Work

FL Faculty Lounge

N Nurse

CONF Conference Room

Support Spaces

AS After School

S Storage

T Toilet

U Utility

C Custodial

KIT Kitchen

SERV Serving

No Work Required

Portable Classrooms

Main Entry

Drop-Off

Fence

Kinder Play

Play Apparatus

Learning Court Quad/Playfield

Hardcourts

Proposed Enrollment: 630	
Teaching Stations:	
Preschool, PK	0
Transitional Kinder, TK	2
Kindergarten, K	3
1 st -3 rd Grade	9
4 th -6 th Grade	9
Innovation Lab	1
VAPA	3
SDC Preschool	0
SDC	0
Other (I-CARES)	1
Grand Total:	28

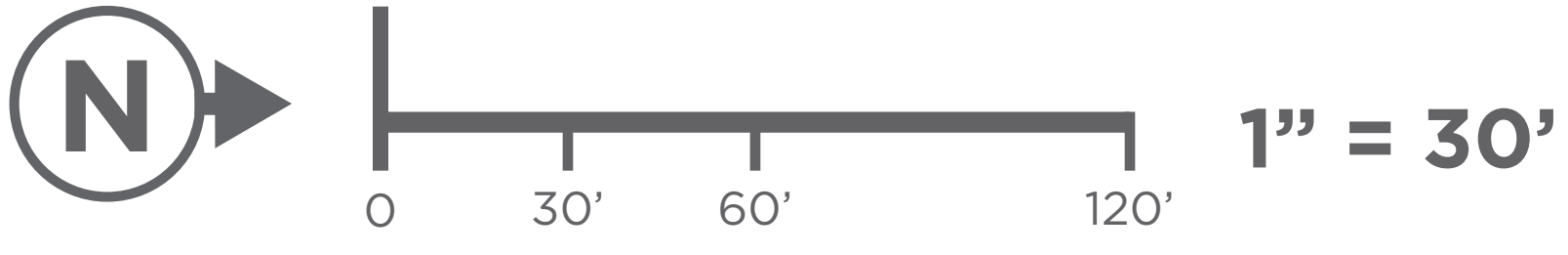

Taft Elementary
EXISTING SITE PLAN

Orange Unified School District
Facilities Master Plan



- Classrooms, CR

PK
TK
K
CR
SDC
OT/PT
VAC

Preschool
Transitional Kindergarten
Kindergarten
Classroom (Grade Level)
Special Day Class
Occupational Therapy/Physical Therapy
Vacant
- Specialty Spaces

COMP
STEAM
VAPA

Computer Lab
Science/Tech/Engineering/Art/Math
Visual Arts/Performing Arts
- Shared Spaces

MPR
LIB

Multi-Purpose Room
Library
- Admin / Faculty

FW
FL
WR
O
N
PSY
SPCH
IS
CONF
COUN
PTA

Faculty Work
Faculty Lounge
Workroom
Office
Nurse
Psychologist
Speech
Instructional Support
Conference Room
Counselor
Parent Teacher Association
- Support Spaces

CARES
ASES
S
T
U
C
KIT

Expanded Learning Program
After School Education & Safety
Storage
Toilet
Utility
Custodial
Kitchen

- Portable Classroom
- ★

Main Entry
- Drop Off

Existing Enrollment:	552
Teaching Stations:	
Preschool, PK	1
Transitional Kinder, TK	1
Kindergarten, K	2
1 st -3 rd Grade	10
4 th -6 th Grade	8
STEAM Lab	1
VAPA	0
Computer Lab	0
SDC	0
RSP	1
Other (2-GLAD, 0.5-IMC, 0.5-ASES, 1-Resource, 1-CARES)	5
Grand Total:	29

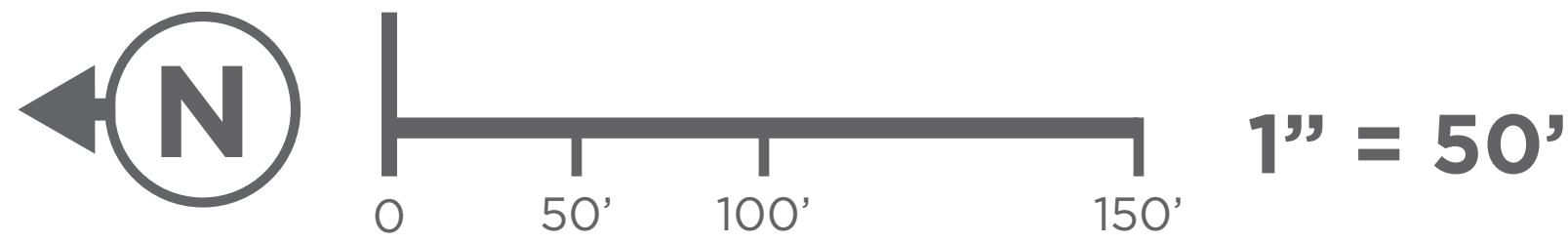

MODERNIZATION

RECONFIGURE

NEW CONSTRUCTION

Classrooms, CR

PK Preschool

TK Transitional Kindergarten

K Kindergarten

Grade Level

ENG English

HIST History

MATH Math

SDC Special Day Class

Specialty Spaces

IL Innovation Lab

VAPA Visual Arts/Perf. Arts

SCI Science

ELEC Elective

Shared Spaces

MPR Multi-Purpose Room

LIB Library

LC Learning Center

CH Changing Room

Admin / Faculty

FW Faculty Work

FL Faculty Lounge

N Nurse

CONF Conference Room

Support Spaces

AS After School

S Storage

T Toilet

U Utility

C Custodial

KIT Kitchen

SERV Serving

No Work Required

Kinder Play

Portable Classrooms

Play Apparatus

★ Main Entry

Learning Court Quad/Playfield

➔ Drop-Off

Hardcourts

Fence

Proposed Enrollment: 900	
Teaching Stations:	
Preschool, PK	1
Transitional Kinder, TK	1
Kindergarten, K	4
1 st -3 rd Grade	10
4 th -6 th Grade	11
Innovation Lab	1
VAPA	3
English, ENG	1
History, HIST	1
Math	1
Science, SCI	1
Electives	2
SDC Preschool	0
SDC	0
Other (2-After School, 2-GLAD)	4
Grand Total:	41



Cerro Villa Middle School
EXISTING SITE PLAN

Orange Unified School District
Facilities Master Plan

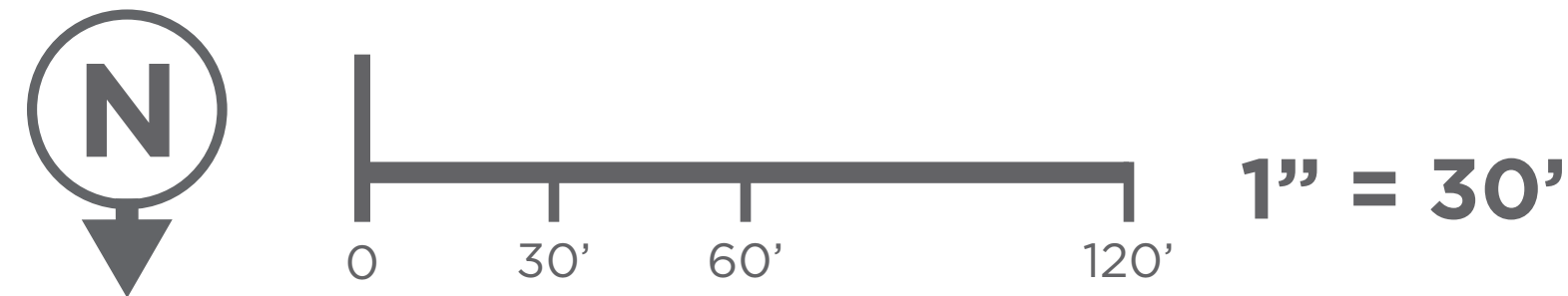
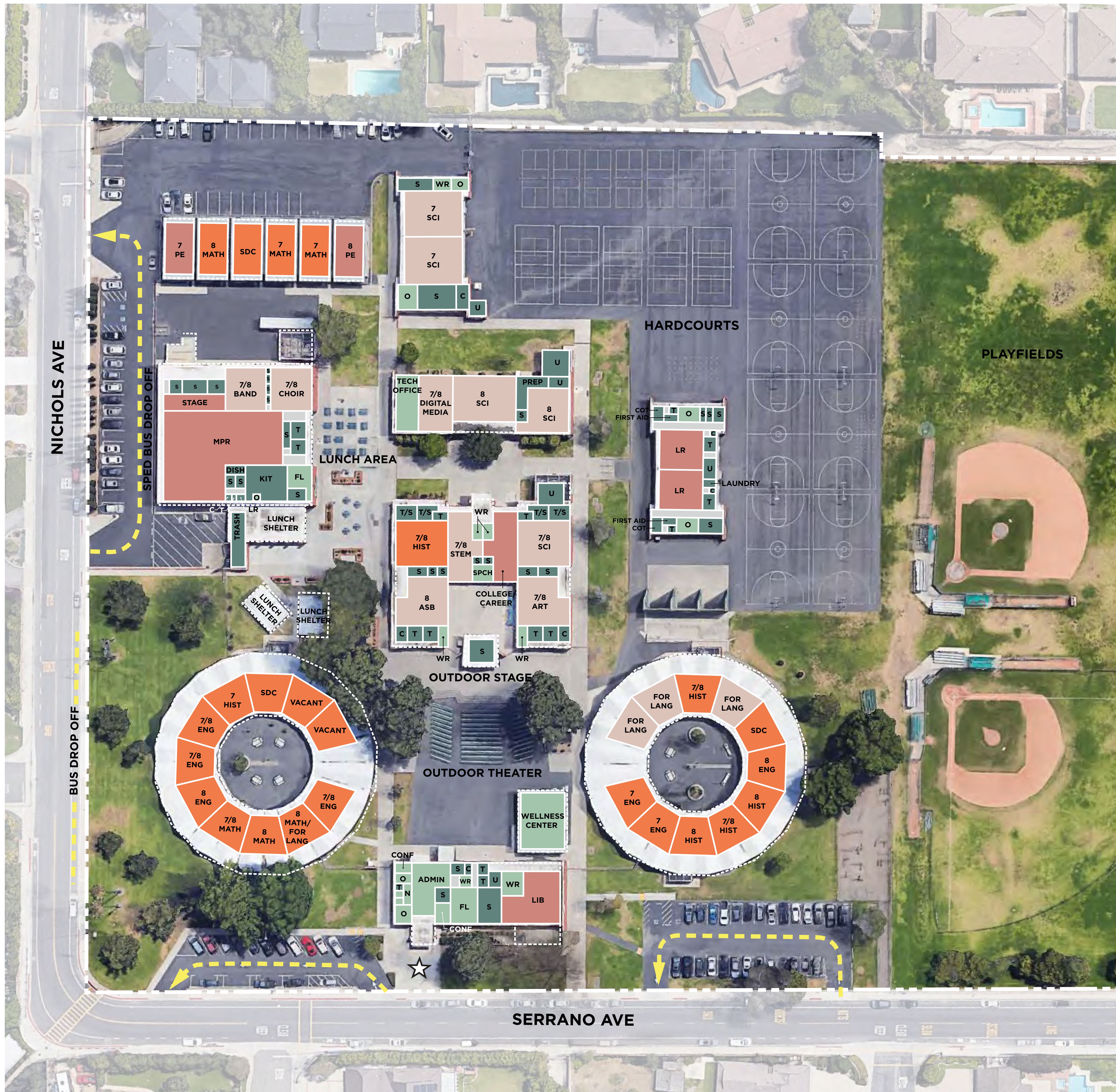

- Classrooms, CR

ENG English
HIST History
MATH Math
RSP Resource Specialist
SDC Special Day Class
OT/PT Occupational Therapy/Physical Therapy
VAC Vacant
- Electives / Labs

SCI Science Lab
COMP Computer Lab
- Shared Spaces

MPR Multi-Purpose Room
LIB Library
LR Locker Room
- Admin / Faculty

FW Faculty Work
FL Faculty Lounge
WR Workroom
O Office
N Nurse
PSY Psychologist
SPCH Speech
CONF Conference Room
COUN Counselor
PTA Parent Teacher Association
- Support Spaces

CARES Expanded Learning Program
ASES After School Education & Safety
S Storage
T Toilet
U Utility
C Custodial
KIT Kitchen

- Portable Classroom
- ★

Main Entry
- Drop Off

Existing Enrollment:	904
Teaching Stations:	
English, ENG	7
History, HIST	6
Math	6
Science, SCI	5
Electives, ELEC	9
Computer Lab, COMP	0
RSP	0
SDC	3
Other (2-Vacant, 1-College/Career, 2-PE)	5
Grand Total:	41

DRAFT DRAFT DRAFT DRAFT DRAFT DRAFT DRAFT DRAFT

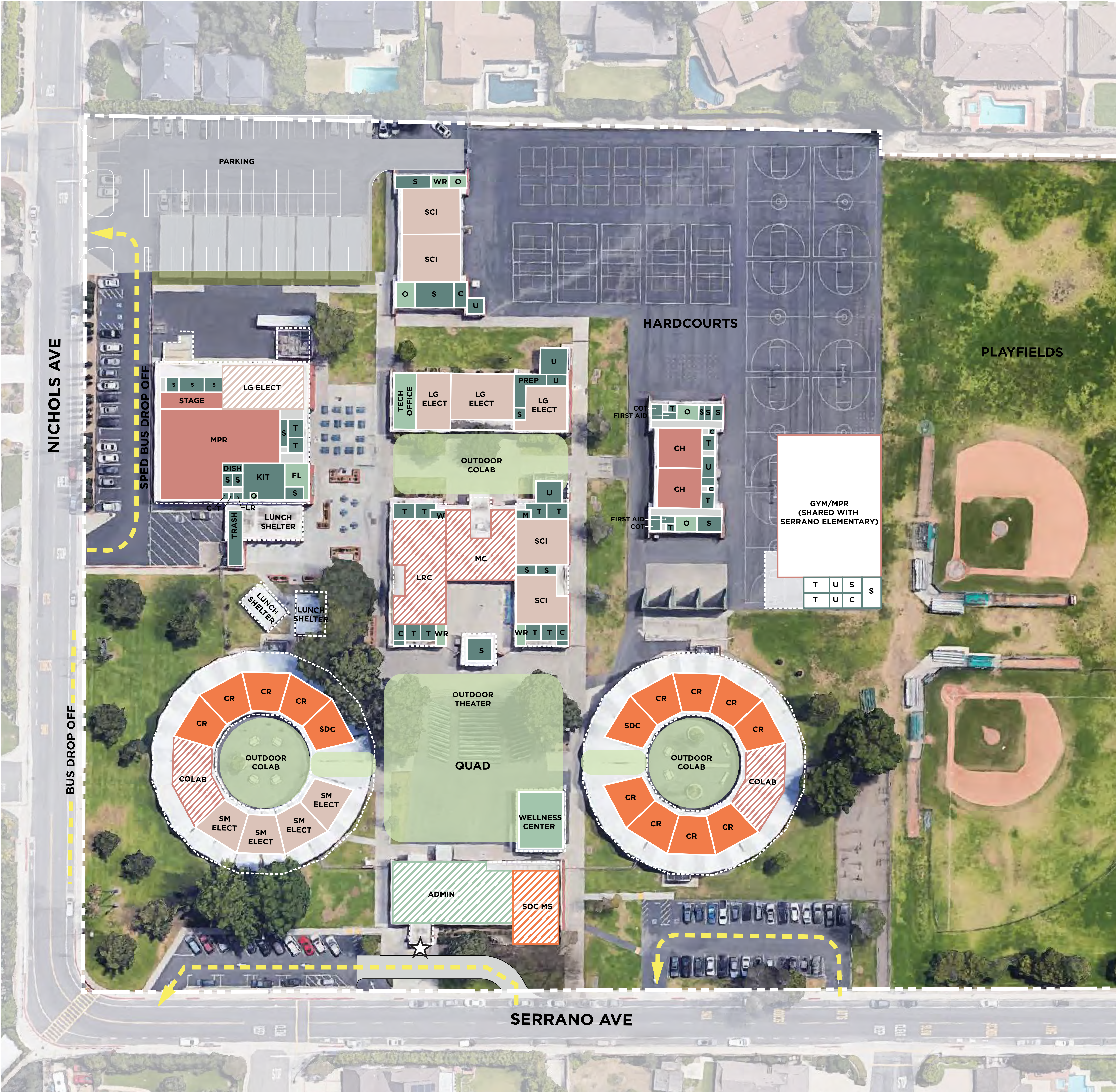

MODERNIZATION

RECONFIGURE

NEW CONSTRUCTION

Classrooms, CR

ENG English

HIST History

MATH Math

SDC Special Day Class

Electives / Labs

SCI Science Lab

ELEC Elective

Shared Spaces

MPR Multi-Purpose Room

LIB Library

LC Learning Center

CH Changing Room

Admin / Faculty

FW Faculty Work

FL Faculty Lounge

N Nurse

CONF Conference Room

Support Spaces

AS After School

S Storage

T Toilet

U Utility

C Custodial

KIT Kitchen

SERV Serving

No Work Required

Portable Classrooms

Main Entry

Drop-Off

Fence

Learning Court Quad/Playfield

Hardcourts

Proposed Enrollment:	700
Teaching Stations:	
English, ENG	4
History, HIST	4
Math	4
Science, SCI	4
Electives, ELEC	8
SDC	3
Other	0
Grand Total:	27



Changing Lives by Design™